

# 14MZ™ ACCESSORIES & OPTIONS

The 14MZ includes: an aluminum storage/carrying case; 32MB Compact Flash Card; 7.4V, 2200mAh Lilon transmitter battery; 4.8V, 1500mAh NiCd receiver battery; Lilon and NiCd wall chargers; stylus/wrench box; display screen cloth; heavy-duty switch harness; aileron extension; Y-harness; neck strap, DSC cord; and rubber grips.

\* = Also compatible with 12Z systems.

## R6014FS Receiver\*

- 14 channels
- Dual Antenna Diversity (DAD) for stronger signals
- Designed for Constant Channel Shifting™
- "Locks" to transmitter's unique signal with push-button Easy Link™

**Dimensions:** (L x W x H): 1.6 x 1.1 x 0.35 in (40 x 27 x 9 mm)  
**Weight:** 0.24 oz (7 g)  
**FUTL7644**

## TM-14 14-Channel 2.4GHz Transmitter Module\*

- For 2.4GHz 14MZ, 12Z and 12FG systems.
- Simple, plug-in installation.

**FUTL8934**

## 32MB Data-Pack Memory Card

- Plug-in capacity and convenience for:
  - Set-ups for up to 100 additional models
  - Digital images
  - Up to 24 voice prompts
  - Downloaded digital sound/music sequences for storage as Windows Media Audio (.wma) files
  - Downloads of free online updates and upgrades

**FUTM9410**

## Lithium-Ion Tx Battery\*

- Provides up to 3 hours of flight time per charge
- Includes unique slide charge indicator

**Capacity:** 7.4V/200mAh  
**Dimensions:** 2.7W x 1.5L x 0.79H in (69 x 38 x 20 mm)

**FUTM1475**

## LilonTx Battery Charger\*

- Recharges the Lilon Tx pack (FUTM1475) in about one hour
- Indicator light turns off when charging is complete

**Input:** 100-240V AC current (50/60Hz)  
**Output:** 8.4V, 1.5A DC current  
**FUTM1700**

## NR4F1500 NiCd Rx Battery\*

**Capacity:** 4.8V/1500mAh  
**Dimensions:** 1.9W x 2.8L x 0.74H in (47 x 69 x 19 mm)  
**Weight:** 4.1 oz (116 g)  
**FUTM1285**

## Rx Battery Charger

- Recharges Rx battery (FUTM1285) overnight

**Input:** 120V AC current (60Hz)  
**Output:** 5.8V DC current  
**FUTM1705**

## CR-2500 Lithium-Ion Tx/Rx Charger

- Capable of simultaneously charging the 14MZ's Tx pack and either a 4-6 cell Rx pack or glow starter cell
- Auto-stop uses constant current/constant voltage method for Lilon charging, and delta peak method for Rx NiCds and glow starter cells
- LCD displays input and output voltage, peak voltage and charge current, time and amount



**Requires:** 12V, 6A power  
**FUTM4168**

## Stylus/Wrench Box for 14MZ

- Rubber tip safely pinpoints desired functions on touch-screen
- Tool under tip easily tightens switch dress nuts
- Hollow handle stores L-wrenches for changing switch location and adjusting the antenna or stick tension

**FUTM5687**

## Transmitter Display Screen Cleaner

- Made of super-soft synthetic suede for scratch-free cleaning

**Dimensions:** 7.5W x 8.1L x 0.04H in (191 x 206 x 1.0 mm)  
**FUTM5720**

## DSC/Charge Adapter Cord\*

- Charge adapter for 4VF, 6EX, 7C, 9C Super, 9Z, 12FG, 12Z and 14MZ

**FUTM4243**

## ANT-17 Antenna

**FUTM5120** ANT-17

## Transmitter Neck Strap\*

- Adjustable length for customized feel

**FUTM5693**

## Heavy-Duty Switch Harness\*

- Heavy-gauge wiring and pre-soldered connectors for quality and reliability

**FUTM4387**

# 14MZ™

# 14MZ™

14-Channel Computer Systems



# Futaba®



## Futaba 14MZ Flyers Club

Futaba 14MZ owners are entitled to FREE membership into the Futaba 14MZ Flyers Club — an elite association of modelers who share an appreciation for the finest equipment available in the R/C hobby. As a registered Flyers Club member, you'll receive exclusive access to 14MZ merchandise as well as periodic update information and special offers.

Intuitive.

Interactive.

In a League of its Own.

## 14MZ.com

The dedicated information resource for 14MZ owners.

## Futaba 14MZ Website



More information about the 14MZ is as close as your computer, at [www.14MZ.com](http://www.14MZ.com). You can also take a "virtual tour" of the 14MZ transmitter...read the latest product reviews...subscribe to receive e-mail notifications of site updates...and more.

[www.14mz.com](http://www.14mz.com)

## Futaba Service Center

In the unlikely event that your Futaba equipment ever requires service, you can count on Futaba's exceptional Service Center to get you back into action fast.

Staffed by expert technicians and equipped with the most advanced diagnostic tools, the Service Center gives your Futaba radio system the knowledgeable care it deserves. If a repair is needed, they get it right the first time.

And the Service Center's location in the central United States means that shipping to most areas of the country takes only two days. You get your return package fast — without paying overnight shipping charges.

**Futaba Service Center USA**  
3002 N. Apollo Dr. Suite 1, Champaign, IL 61822

## One Year Limited Warranty

Futaba digital proportional R/C systems are warranted to the original purchaser for one full year from the date of purchase against defects in material and workmanship. During this period, Futaba will repair or replace, at our discretion, the defective component.

This warranty does not apply to improperly installed, handled, or abused systems, radios which have been damaged in a crash, nor to any unit which has been repaired or altered by unauthorized agencies. Under no circumstances will the buyer be entitled to consequential or incidental damages. This limited warranty gives you specific legal rights. You may have other rights which vary from state to state. Batteries and plastic housings are not covered by warranty.

This warranty applies to Futaba products purchased and used in the United States, Canada, and Mexico.

# Futaba®

[www.futaba-rc.com](http://www.futaba-rc.com)



# 14MZ™

## 14-Channel Computer Systems

It's the flight system pilots have been waiting for: the perfect marriage of the incredible programming power and flexibility of the 14MZ to Futaba Advanced Spread Spectrum Technology (FASST) — the most dependable signal transmission technology ever created.

Long before it was ever considered for hobby use, Futaba

## READY FOR THE BEST IN 2.4GHZ TECHNOLOGY? YOU'LL FIND IT IN THE 14MZ!

engineers had already begun using and refining 2.4GHz technology for industrial R/C use. By the time we discovered the hobby potential of 2.4GHz technology, we had over 15 years of experience in 2.4GHz design and manufacturing — a unique advantage that pays off in the premium performance of Futaba FASST systems.



Where other 2.4GHz systems restrict themselves to one or two frequencies, FASST systems shift frequencies every two milliseconds — or 500 times per second! That leaves no time for signal conflicts or interruptions — and no need for a frequency pin.



Like the best drivers, Futaba's Pre-Vision technology enhances dependability by scanning the road ahead. This allows it to detect and correct errors before they can cause problems. Patent # 6,141,392

**A FUTABA EXCLUSIVE!**



R6014FS receiver design calls for two antennas, and orienting them at right angles to each other. The receiver constantly monitors both antennas and automatically uses the antenna with the strongest signal, to eliminate "dead" spots and ensure uninterrupted reception.



Each Futaba 2.44GHz FASST transmitter module leaves the factory with a unique ID code. The receiver "learns" the code during the very first link-up with the transmitter — and will only recognize signals with that code from that time on. The link is permanent, and easy to establish: just push a button on the receiver, and it's done!

## FASST: The Gold Standard of Dependability

Since they include all four of these unique and overlapping features, FASST systems are capable of creating a virtually "bulletproof" connection between system and model — and effectively reduce the chances of taking a "hit" to near zero.

## Custom-Developed IC Chips

Futaba uses custom IC chips that they've designed specifically for radio-control — ensuring quality, reliability, and security. This is why Futaba FASST systems are faster and more reliable than the competition.



## Over 2x Less Minimum Latency\*

Latency is a measure of the time between control movement and servo response. Servo response in Futaba 2.4GHz FASST systems is over **twice** as fast as that in other systems, for the most immediate response of any R/C flight system.

\*Based on a comparison between the 6EX FASST system to the DX-7.



## Hassle-Free Fail-Safe

Unlike fail-safes that require complicated, six-step set-up and a binding plug, the fail-safe on the 2.4GHz 14MZ is programmed through the transmitter, just like the fail-safes on conventional systems. Faster, easier...Futaba.

## Futaba Tx Modules: Designed for quick, snap-in fits!

Futaba put an incredible amount of thought into how well one component fits — and works — with the next. Futaba 2.44GHz modules are no different from any other Futaba transmitter module: they simply plug into place, for fast, solid connections. No extra cords or clutter — just a perfect fit and unparalleled performance first-time, every time.

STOCK NUMBER	SYSTEM	MODE	MODULATION	BAND	RECEIVER	SERVOs	RX BATTERY	TX BATTERY
FUTK9400	14MZAP	2	FASST	2.4GHz	R6014FS	—	1500mAh NiCd	2200mAh Lilon
FUTK9401	14MZHP	2	FASST	2.4GHz	R6014FS	—	1500mAh NiCd	2200mAh Lilon
FUTK9402	14MZAP	1	FASST	2.4GHz	R6014FS	—	1500mAh NiCd	2200mAh Lilon
FUTK9403	14MZHP	1	FASST	2.4GHz	R6014FS	—	1500mAh NiCd	2200mAh Lilon

## ENJOY THE UNRIVALED POWER AND DEPENDABILITY OF THE WORLD'S ONLY 14-CHANNEL R/C SYSTEM!

LED Flashing status		
color	mode	condition
yellow	fast blink	Powering up/powering off
yellow	slow blink	Start up error
purple	on	Ready without RF power
sky blue	slow blink	Setting frequency mode
purple	on	Frequency setting mode
blue	on	Trainer/student mode
red	slow blink	RF module error
green	on	Ready with RF power

### Seven-Color LED Indicator

### Slider Arms (2 side-mount; 2 front/rear accessible)

### Customizable Switch Banks (right and left)

- Change location of existing switches, or plug in the style you prefer: long or short, button or toggle, spring-loaded or positionable.

### 14MZ™ Specifics:

- Dual processors — Includes a custom Futaba processor for critical flight functions and a Windows® CE processor for set-up and programming.
- 2048 technology — for twice the resolution of the best 1024 PCM systems
- Modular design — equipped for 2.4GHz operation, but can be switched to 72MHz components without losing a split-second of response time!
- Heli and airplane/sailplane programming
- 30-model memory
- Assignable switches/functions
- 10 user-programmable mixes
- 24 factory-defined mixes
- 9 flight conditions (8 plus default)
- Mixing for up to 4 engines
- 4 menus and up to 54 programmable functions.
- Can be updated and/or upgraded with free downloads from the 14MZ web site — a Futaba exclusive
- Voice prompts can be assigned to specific switches. Operating switch activates an audio confirmation!
- Ideal for simultaneous dual-receiver operation
- Deluxe aluminum case



### Direct Select Buttons

### Rotary Dial

- For easier menu/function navigation.

### Included Compact Flash Card

- Expands memory by 100 models
- Stores downloaded digital images
- Records/stores downloaded Windows Media Audio (.wma) files, recorded sound files and up to 24, 3-second voice prompts for play back
- Stores free 14MZ upgrades and updates downloaded from 14MZ web site

### Antenna Storage

### R6014FS Receiver

- 14 channels
- Dual antennas
- Battery fail-safe with auto cut-off
- Designed for Continuous Channel Shifting™ technology
- "Locks" to transmitter's unique signal with push-button Easy Link™

### Full-Color HVGA Display

Choose the way you want to program!

- Cut programming time in half with state-of-the-art touch-screen set-up **or**
- Use the rotary dial and direct select buttons at the bottom of the screen.
- Start-up screen leads to three function-specific menus:
  - System — for transmitter functions
  - Linkage — for model functions that remain constant.
  - Model — for functions that modify performance based on conditions
- Identify aircraft with digital images alone — or add model names up to 32 characters long.
- Clear, sharp 640 x 240 pixel resolution.
- Displays battery capacity, trim positions, and other critical flight data for fast, at-a-glance reference.
- Anti-glare filter and adjustable screen contrast maximize visibility in any light



### Rotary Dials (3)

Assignable to any function. The LD and RD dials pop up for adjustment and retract to prevent unintentional changes to settings.

### Quad-Bearing Gimbals

- with dual bearings on each axis; length, tension and detent adjustments; and long-life potentiometer

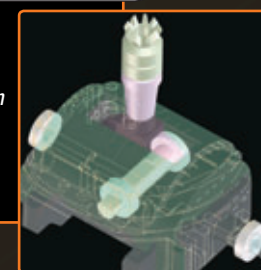

### Speaker

### Microphone

### Digital Trims (6; T1-T6)

### Servo Grouping™

- Allows all servos dedicated to a single function to be operated simultaneously and controlled like a single servo.
- Servos can be plugged into different (even non-consecutive) receiver channels.
- No servo synchronizer required — each servo's EPA can be adjusted individually from the transmitter.

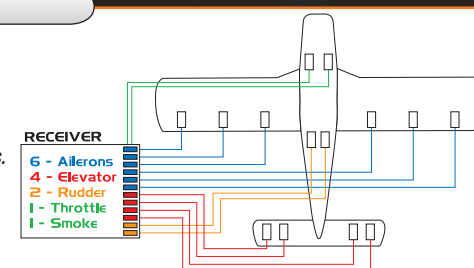

### TM-14 Module

### Slider Arms

(Side sliders adjust from back) (Front sliders adjust from front or back)

### Gimbal Stick Adjustment Ports

For fine tuning stick feel to your touch

### DSC/Trainer Cord Jack

### Rubber Grips

### Battery Box

### Earphone Jack

### Battery Charging Jack

### Lithium-Ion Battery