

One Top-Notch Truggy Kit

DEX8T

1/8 Scale 4WD Electric Truggy Kit



It's the premier racing truggy kit for dominating the 1/8 scale competition, leading the way with sizzling speeds, super toughness and confident handling! Easy to set up, easy to maintain and highly versatile, the DEX8T is packed with innovative features — including a patent-pending sliding gear mesh for rock-solid weight distribution. From battling for bragging rights at the local track to going for TQ and 1st place at regional and national events, the DEX8T is engineered to deliver the ultimate racing experience.

FEATURES:

- 5 mm chassis and front/rear shock towers are constructed from lightweight, milled 7075 T6 aluminum
- Innovative, patent-pending sliding gear mesh for rock-solid weight distribution, consistent braking and simplified maintenance
- Easy-access front/rear diff units minimize tune-up time
- Independent active caster inserts boost set-up flexibility
- Fully adjustable pivot ball suspension and hinge pin inserts provides more options for front-end mods; galvanized components protect against oxygenation
- Balanced front and rear geometry results in dependable handling
- 16 mm Big Bore aluminum shocks with vented shock caps and a choice of constant volume and emulsion bodies
- Ultra-lightweight differentials with composite cross shafts increase acceleration
- Easy-access center diff installs with only four screws for fast tuning
- Center universal joints minimize heat transfer and maximize drivetrain efficiency
- Ultra-tough composite and steel components for lasting performance
- Clunk-style fuel tank with extra-wide gutter and spillage evacuation system, compatible with all fuel bottles
- Adjustable, four-position Ackermann
- Ultra-lightweight 50T spur gear with metal insert for the diff outdrive
- Fully adjustable battery tray lets drivers move the battery forward, backward or side-to-side
- Fully waterproof receiver box with rubber and foam seals
- Fully adjustable battery box, designed to accommodate NiMHs, LiPos and LiFes

Length: 23.3 in (585 mm)

Width: 16.2 in (408 mm)

Height: (approx.): 7.7 in (196 mm)

Weight: 7.7 lb (3.5 kg)

Requires: 1/8 brushless motor, 1/8 brushless ESC, 2-channel radio system, high-torque steering servo, (2) 2S 7.4V 5000mAh (min.) LiPo batteries, compatible charger, 1/8 off-road truggy tires, 1/8 truggy wheels, pinion gear

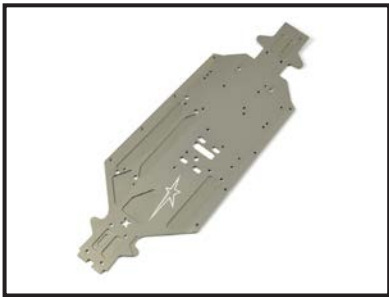

3 mm hard-anodized 7075 T6 aluminum chassis.



Patent-pending sliding gear mesh ensures that the motor stays in the same position, regardless of adjustments.



16 mm Big Bore shocks allow drivers to conquer even the most demanding tracks.



The ultra-tough, aerodynamic polycarbonate body delivers the perfect combination of durability and weight balance.



Equalized weight distribution makes handling more consistent. Fast, easy pinion changes result in efficient gear tuning.



Independent active caster inserts help make the most of the dynamic, adjustable pivot ball suspension, and can be fine-tuned in just minutes.



Milled shock towers reduce weight and increase durability. Etched parts deliver high quality and impressive style.



A removable radio tray makes installation of electronic components fast and easy.



Multiple battery layout options allow racers to create custom weight configurations for faster lap times and improved agility.

Available: Now

Stock #	Description	Advertised Price
TDRC0402	DEX8T 1/8 Scale 4WD Electric Competition Truggy Kit.....	\$599.99

For further information please contact:
Carol Pesch
Product Communication Manager
cpsesch@hobbico.com
217-398-3630

team-durango.com



Click on the Team Durango logo and Facebook icon to visit our web site and Facebook page.