

## Mechanism of the regulator

Silicone regulator sheet

### Stop valve

The stop valve regulates the pressurized fuel to send proper amount of fuel to the carburetor according to the engine r.p.m.

The pressurized fuel goes in from the fuel tank

### Fuel passage

The fuel is sent to the carburetor and mixed with air to be transferred to the engine.

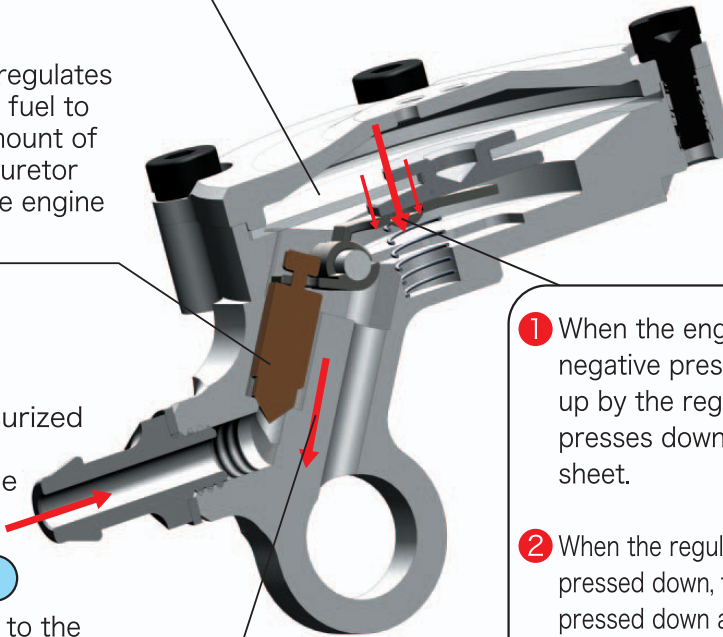

- 1 When the engine starts, the negative pressure is picked up by the regulator and presses down the regulator sheet.
- 2 When the regulator sheet is pressed down, the lever is also pressed down and it lifts the stop valve to supply necessary fuel to the carburetor.