

MAX-61SX-HRING "WC"

(17930)

TYPE 60B

(27981010)

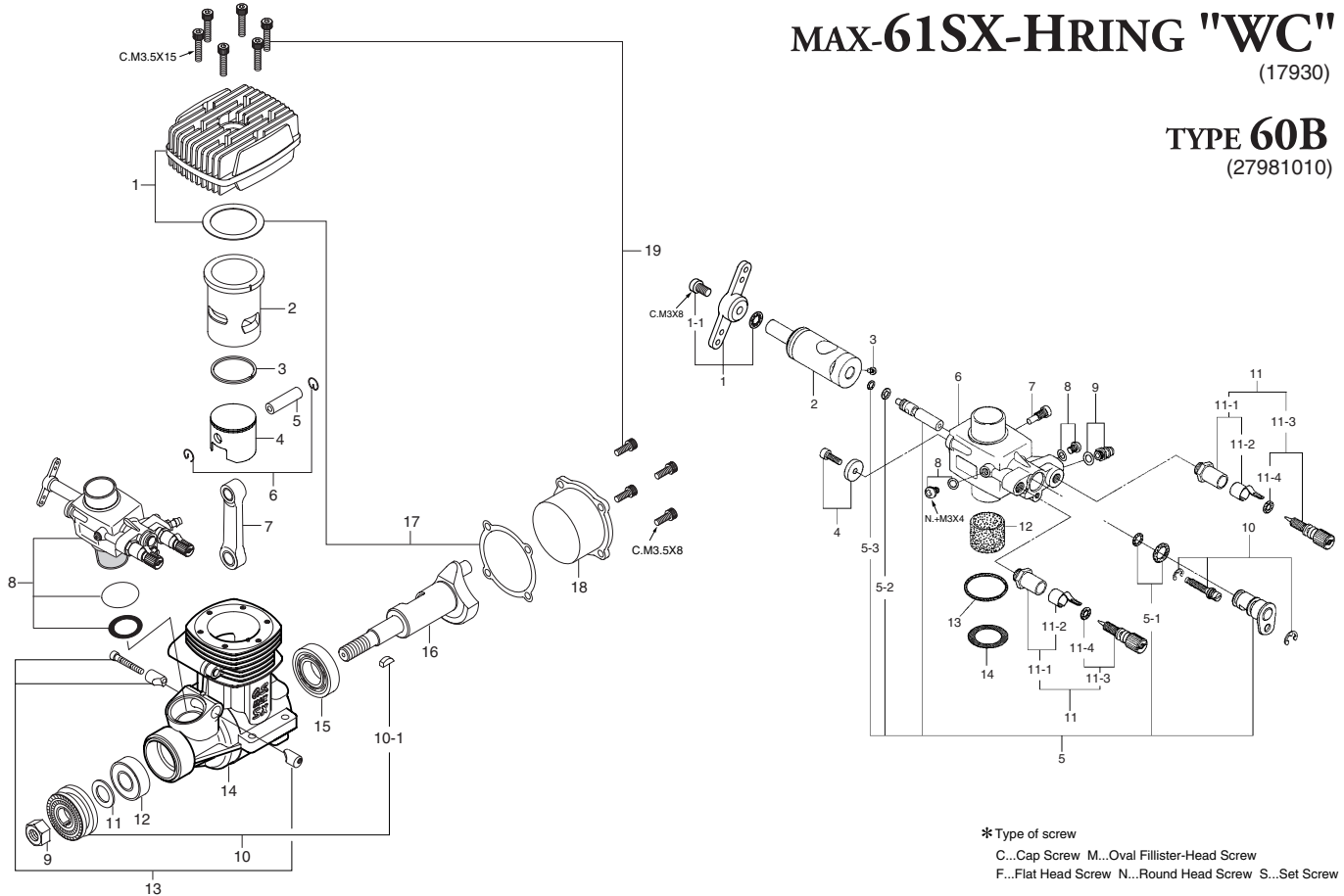

* Type of screw

C...Cap Screw M...Oval Fillister-Head Screw

F...Flat Head Screw N...Round Head Screw S...Set Screw

No.	Code No.	Description
1	27904200	Heatsink Head
2	27953100	Cylinder Liner
3	26703404	Piston Ring
4	27903200	Piston
5	26606008	Piston Pin
6	27917000	Piston Pin Retainer (2pcs.)
7	27905000	Connecting Rod
8	27981010	Carburetor Complete (Type 60B)
9	45010002	Propeller Nut
10	27708010	Drive Hub
10-1	27708200	Woodruff Key
11	46120000	Thrust Washer
12	26731002	Crankshaft Ball Bearing (Front)
13	27981710	Carburetor Retainer Assembly
14	27951000	Crankcase
15	27930000	Crankshaft Ball Bearing (Rear)
16	27952000	Crankshaft
17	27914000	Gasket Set
18	27907000	Cover Plate
19	27913000	Screw Set
	71608001	Glow Plug No.8
		Needle Adjusting Screw (M2.6x5)

No.	Code No.	Description
1	27381410	Throttle Lever Assembly
1-1	22826131	Throttle Lever Retaining Screw (2pcs.)
2	27981200	Carburetor Rotor
3	27981920	Metering Nozzle Retaining Screw
4	27981220	Rotor Guide Washer
5	27981301	Mixture Control Valve Assembly
5-1	27981850	"O" Ring Set
5-2	27881820	"O" Ring (L)
5-3	22781800	"O" Ring (S)
6	27981110	Carburetor Body (w/Thermo insulator)
7	27981600	Fixed Throttle Stop Screw
8	27881120	Plug Screw
9	22681953	Fuel Inlet (No.1)
10	27981332	Mixture Control Screw
11	27981900	Needle Valve Assembly
11-1	27381940	Needle Valve Holder Assembly
11-2	26711305	Ratchet Spring
11-3	27981910	Needle Assembly
11-4	24981837	"O" Ring (2pcs.)
12	27984900	Thermo insulator
13	27915000	Carburetor Rubber Gasket
14	27915100	Carburetor Sealing Washer (1pc.)
		Needle Adjusting Screw (M2.6x5)

O.S. GENUINE PARTS & ACCESSORIES

Code No.	Description
27983000	60D Mixture Control Carburetor
71705000	In-Flight Control Needle Valve
72403050	Super Filter (L)
71530300	Crankshaft Clamp 3261
55500003	M4 Lock Washer (10sets)
41621100	Needle Adjusting Screw (M2.6x5) (5pcs.)
79871060	M3.5x8 Cap Screw Set (10pcs.)
79871090	M3.5x15 Cap Screw Set (10pcs.)
71521000	Long Socket Wrench With Plug Grip