

MONSTER TRUCK™

BRUSHLESS REPLACEMENT PARTS

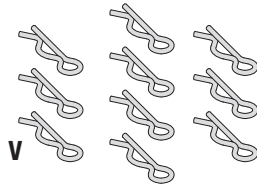

BODY CLIP



DIDC1000

3MM NYLON INSERT LOCK NUT

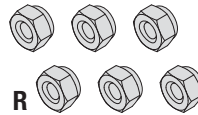

DIDC1001

DIFF BEVEL GEAR SET

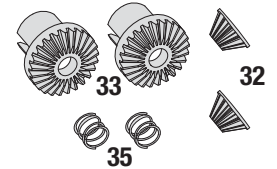

DIDC1002

DIFF RING & PINION GEAR SET

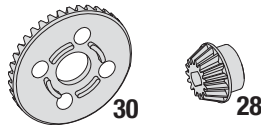

DIDC1003

DIFFERENTIAL CASE

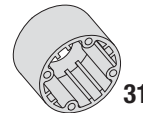

DIDC1004

45T SPUR GEAR

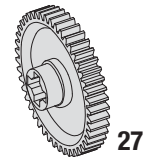

DIDC1005

GEARBOX SET

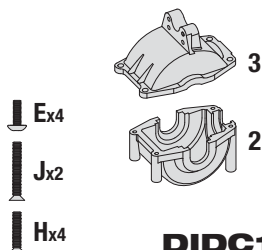

DIDC1006

CENTER DRIVE SHAFT

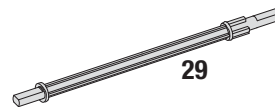

DIDC1007

AXLE SET

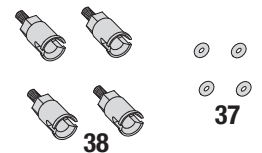

DIDC1008

DOGBONE SET

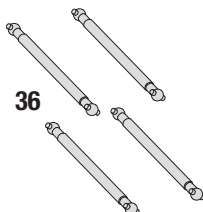

DIDC1009

STEERING BELLCRANK SET

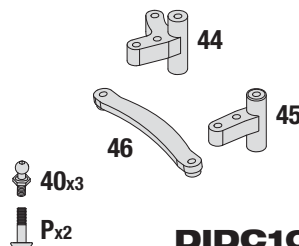

DIDC1010

FRONT HUB CARRIER SET

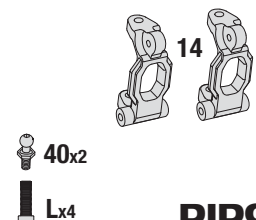

DIDC1012

STEERING KNUCKLE SET

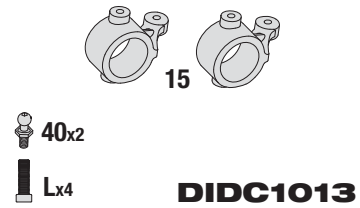

REAR HUB SET

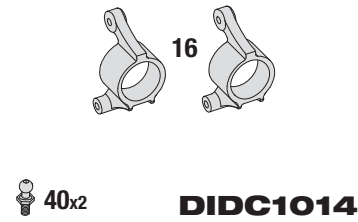

ASSEMBLED LONG SHOCK SET

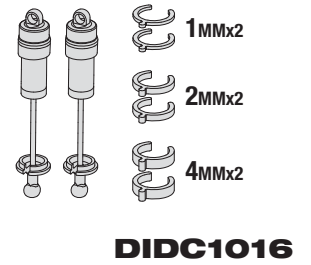

SUSPENSION ARM SET

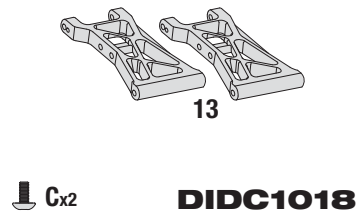

UPPER CHASSIS BRACE

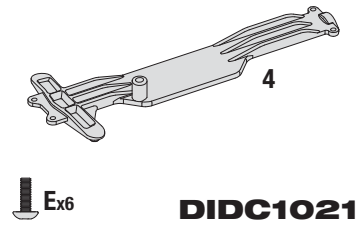

HINGE PIN HOLDER SET

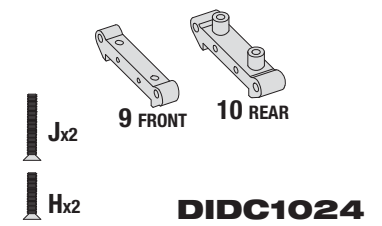

BATTERY HOLD-DOWN

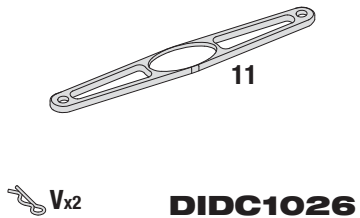

SPUR GEAR COVER

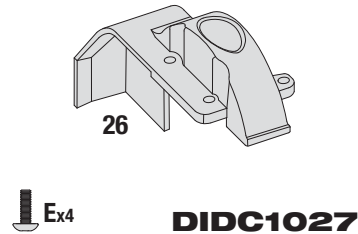

CHASSIS

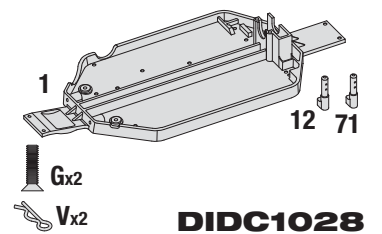

UPPER SHOCK MOUNT SET

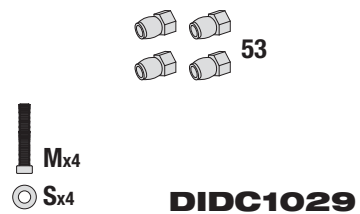

MOTOR MOUNT

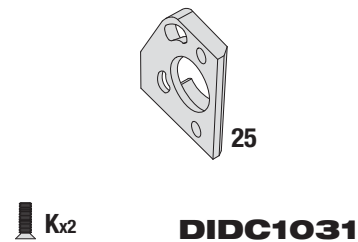

12T PINION GEAR

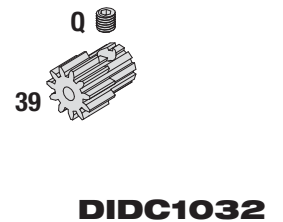

6-CELL 1300MAH BATTERY

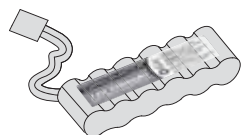

BALL STUD SET

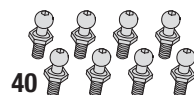

2x36.5MM HINGE PIN SET



2x22MM HINGE PIN SET

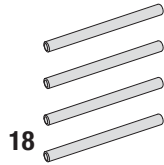

DIDC1036

2x16.5MM DIFF PIN SET



DIDC1037

**LONG SHOCK SPRINGS
(MEDIUM SOFT/YELLOW)**

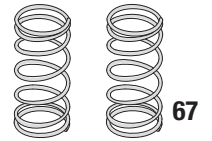

DIDC1038

LINKAGE SET

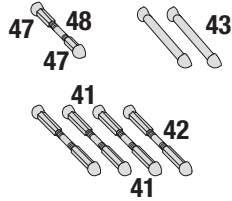

DIDC1042

BUMPER SET

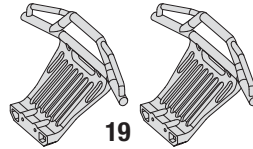

Ex4

DIDC1046

SHOCK TOWER

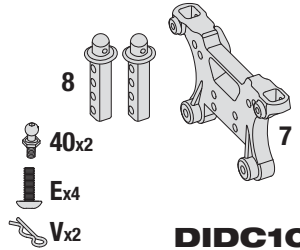

DIDC1054

**LONG SHOCK SPRING
(MEDIUM HEAVY/LIGHT BLUE)**

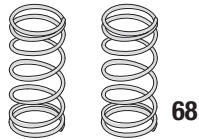

DIDC1059

ASSEMBLED DIFFERENTIAL

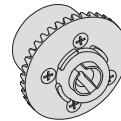

DIDC1061

DRIVE SHAFT SPACER SET

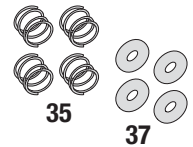

DIDC1062

BATTERY POST SET

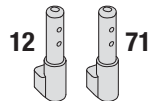

Gx2
Vx2

DIDC1063

ANTENNA TUBE & CAP

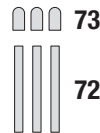

DIDC1064

SHOCK SHAFT SET

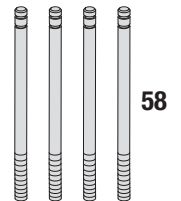

DIDC1066

SHOCK PLASTIC PARTS SET

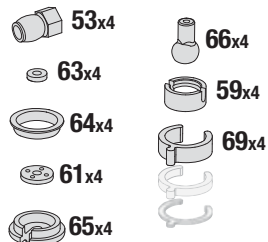

DIDC1067

6x10MM BALL BEARING



DIDC1070

8x12MM BALL BEARING

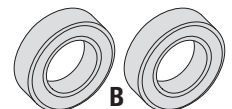

DIDC1071

5300KV MOTOR



DIDC1128

2.5x6mm SOCKET HEAD HEX SCREWS

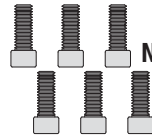

DIDC1132

BODY (RED) W/DECALS

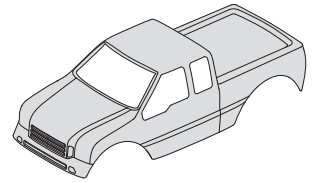

DIDC1195

ASSEMBLED WHEEL/TIRE/FOAM

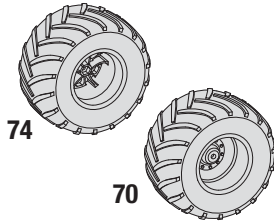

DIDC1196

SERVO SAVER SET

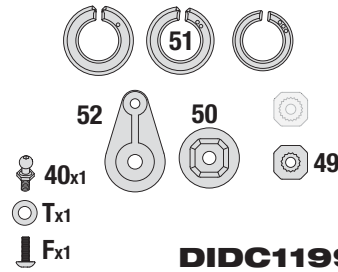

DIDC1199

UNIVERSAL SERVO MOUNT

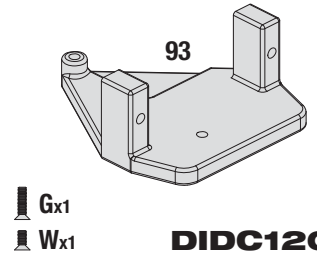

DIDC1202

TRANSMITTER

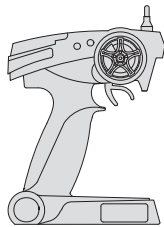

DIDJ1001

RX18 2.4GHz RECEIVER

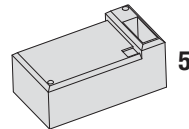

DIDL1000

25A BRUSHLESS ESC

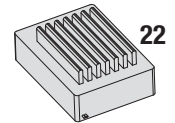

DIDM1002

D-S100 SERVO w/SERVO SAVER

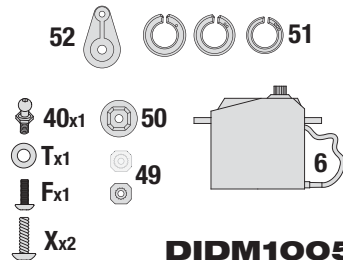

DIDM1005

6-CELL NIMH USB CHARGER

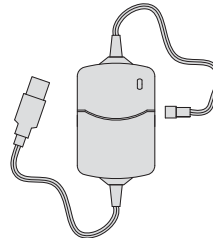

DIDP1004

HARDWARE SET

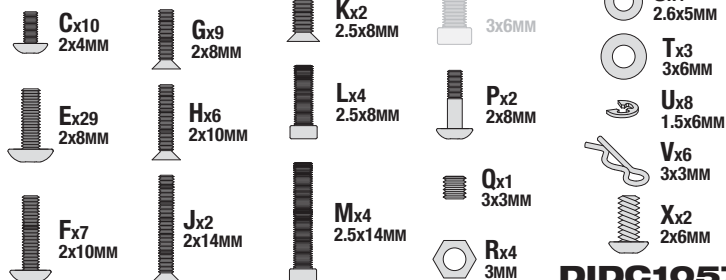

DIDC1057

This parts list shows the key number, part description, and stock number for the replacement parts sets. When more than one stock number is listed, that part is available in multiple replacement parts sets.

| # | Item Description | Available in Stock # | # | Item Description | Available in Stock # |
|-----------------|---|----------------------|----|--|----------------------|
| 1 | Chassis | DIDC1028 | 61 | Shock Piston | DIDC1016, DIDC1067 |
| 2 | Lower Gearbox Half | DIDC1006 | 62 | Shock O-Ring | DIDC1016 |
| 3 | Upper Gearbox Half | DIDC1006 | 63 | Shock O-Ring Spacer | DIDC1016, DIDC1067 |
| 4 | Upper Chassis Brace | DIDC1021 | 64 | Upper Shock Spring Retainer | DIDC1016, DIDC1067 |
| 5 | 2.4G Receiver Brushless | DIDL1000 | 65 | Lower Shock Spring Retainer | DIDC1016, DIDC1067 |
| 6 | Servo w/Servo Saver | DIDM1005 | 66 | Shock End | DIDC1016, DIDC1067 |
| 7 | Shock Tower | DIDC1054 | 67 | Long Shock Spring (Med Soft/Yellow) | DIDC1038 |
| 8 | Body Mount | DIDC1054 | 68 | Long Shock Spring (Med Heavy/Blue) | DIDC1059 |
| 9 | Front Hinge Pin Holder | DIDC1024 | 69 | Shock Pre-Load Spacer 1mm | DIDC1016, DIDC1067 |
| 10 | Rear Hinge Pin Holder | DIDC1024 | 69 | Shock Pre-Load Spacer 2mm | DIDC1016, DIDC1067 |
| 11 | Battery Hold Down | DIDC1026 | 69 | Shock Pre-Load Spacer 4mm | DIDC1016, DIDC1067 |
| 12 | Front Battery Post | DIDC1028, DIDC1063 | 70 | Left Wheel/Tire/Foam Insert Assembled | DIDC1196 |
| 13 | Suspension Arm | DIDC1018 | 71 | Rear Battery Post | DIDC1028, DIDC1063 |
| 14 | Front Hub Carrier | DIDC1012 | 72 | Antenna Tube | DIDC1064 |
| 15 | Steering Knuckle | DIDC1013 | 73 | Antenna Cap | DIDC1064 |
| 16 | Rear Hub | DIDC1014 | 74 | Right Wheel/Tire/Foam Insert Assembled | DIDC1196 |
| 17 | 2x36.5mm Pin (Inner Hinge) | DIDC1035 | 93 | Servo Mount Brushless | DIDC1202 |
| 18 | 2x22mm Pin (Outer Hinge, Steering) | DIDC1036 | | | |
| 19 | Bumper | DIDC1046 | | | |
| 22 | 25A Brushless ESC | DIDM1002 | | | |
| 24 | 5300KV Brushless Motor | DIDC1128 | | | |
| 25 | Motor Mount | DIDC1031 | | | |
| 26 | Spur Gear Cover | DIDC1027 | | | |
| 27 | 45 Tooth Spur Gear | DIDC1005 | | | |
| 28 | 15 Tooth Differential/Pinion Gear | DIDC1003 | | | |
| 29 | Center Drive Shaft | DIDC1007 | | | |
| 30 | 38T Differential Ring Gear | DIDC1003, DIDC1061 | | | |
| 31 | Differential Case | DIDC1004, DIDC1061 | | | |
| 32 | Diff Bevel Gear (Small) | DIDC1002, DIDC1061 | | | |
| 33 | Diff Bevel Gear (Large) | DIDC1002, DIDC1061 | | | |
| 34 | 2x16.5mm Pin (Diff Gear Pin) | DIDC1037, DIDC1061 | | | |
| 35 | Dogbone Spring | DIDC1002, DIDC1062 | | | |
| 36 | Dogbone | DIDC1009 | | | |
| 37 | 2x5mm O-Ring | DIDC1008, DIDC1062 | | | |
| 38 | Axle | DIDC1008 | | | |
| 39 | 12T Pinion Gear (.6 Mod, 2mm Shaft) | DIDC1032 | | | |
| 40 | Ball Stud | DIDC1034 | | | |
| 41 | Ball Cup (Long) | DIDC1042 | | | |
| 42 | Camber Rod | DIDC1042 | | | |
| 43 | Tie Rod | DIDC1042 | | | |
| 44 | Steering Bell Crank (Right) | DIDC1010 | | | |
| 45 | Steering Ball Crank (Left) | DIDC1010 | | | |
| 46 | Steering Drag Link | DIDC1010 | | | |
| 47 | Ball Cup (Short) | DIDC1042 | | | |
| 48 | Steering Rod | DIDC1042 | | | |
| 49 | Servo Saver Spline | DIDC1199, DIDM1005 | | | |
| 50 | Servo Saver Base | DIDC1199, DIDM1005 | | | |
| 51 | Servo Saver Spring | DIDC1199, DIDM1005 | | | |
| 52 | Servo Saver Arm | DIDC1199, DIDM1005 | | | |
| 53 | Upper Shock Mount | DIDC1029, DIDC1067 | | | |
| 55 | Shock Body | DIDC1016 | | | |
| 56 | Shock Cap | DIDC1016 | | | |
| 58 | Shock Shaft | DIDC1066, DIDC1016 | | | |
| 59 | Shock Seal Retainer | DIDC1016, DIDC1067 | | | |
| 60 | Shock Diaphragm | DIDC1016 | | | |
| HARDWARE | | | | | |
| A | 6x10mm Ball Bearing | DIDC1070 | | | |
| B | 8x12mm Ball Bearing | DIDC1071 | | | |
| C | 2x4mm Round Head Screw | DIDC1057 | | | |
| E | 2x8mm Round head Screw | DIDC1057 | | | |
| F | 2x10mm Round Head Screw | DIDC1057 | | | |
| G | 2x8mm Flat Head Screw | DIDC1057 | | | |
| H | 2x10mm Flat Head Screw | DIDC1057 | | | |
| J | 2x14mm Flat Head Screw | DIDC1057 | | | |
| K | 2.5x8mm Flat Head Screw | DIDC1057 | | | |
| L | 2.5x8mm Socket Head Cap Screw | DIDC1057 | | | |
| M | 2.5x14mm Socket Head Cap Screw | DIDC1057 | | | |
| N | 2.5x6mm Socket Head Cap Screw | DIDC1057 | | | |
| P | 2x8mm Round Head Shoulder Screw | DIDC1057 | | | |
| Q | 3x3mm Set Screw | DIDC1057 | | | |
| R | 3mm Nylon-Insert Lock Nut | DIDC1001, DIDC1057 | | | |
| S | 2.6x5mm Washer | DIDC1057 | | | |
| T | 3x6mm Washer | DIDC1057 | | | |
| U | 1.5mm E-Clip | DIDC1057 | | | |
| V | Body Clip (Small) | DIDC1000, DIDC1057 | | | |
| W | 2x4mm Flat Head Screw | DIDC1202 | | | |
| X | 2x6mm S/T Round Head Screw | DIDC1057 | | | |

MONSTER TRUCK™ BRUSHLESS

