

DT4.18™

REPLACEMENT PARTS

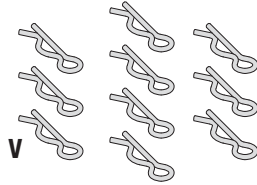

BODY CLIP



DIDC1000

3MM NYLON INSERT LOCK NUT

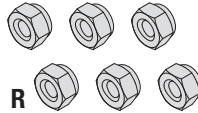

DIDC1001

DIFF BEVEL GEAR SET

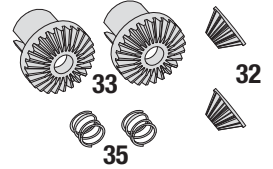

DIDC1002

DIFF RING & PINION GEAR SET

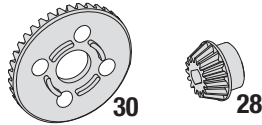

DIDC1003

DIFFERENTIAL CASE

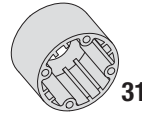

DIDC1004

45T SPUR GEAR

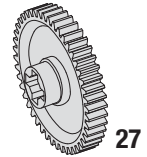

DIDC1005

GEARBOX SET

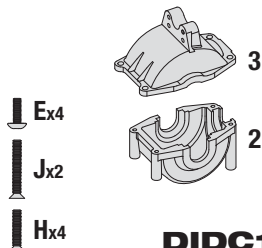

DIDC1006

CENTER DRIVE SHAFT

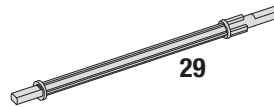

DIDC1007

AXLE SET

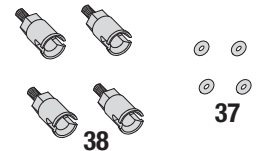

DIDC1008

DOGBONE SET

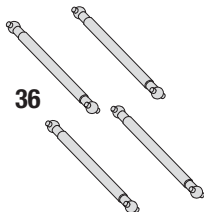

DIDC1009

STEERING BELLCRANK SET

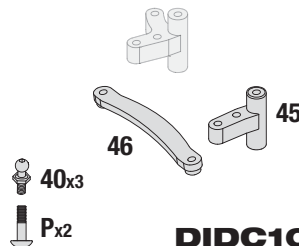

DIDC1010

SERVO SAVER SET

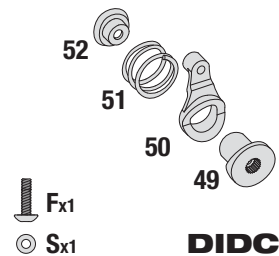

DIDC1011

FRONT HUB CARRIER SET

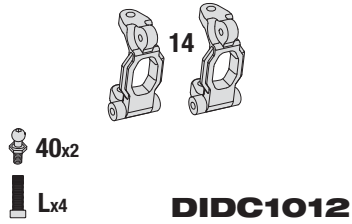

STEERING KNUCKLE SET

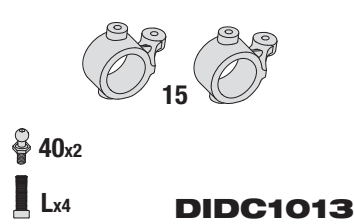

REAR HUB SET

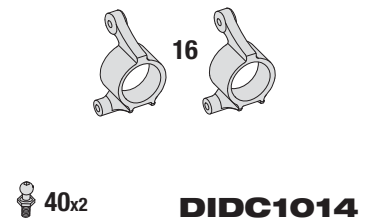

ASSEMBLED LONG SHOCK SET

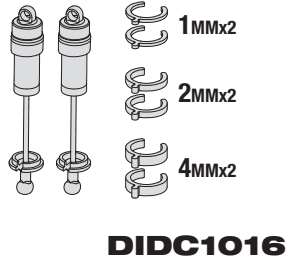

SUSPENSION ARM SET

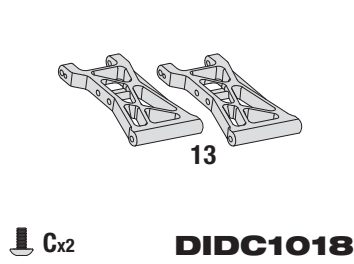

UPPER CHASSIS BRACE

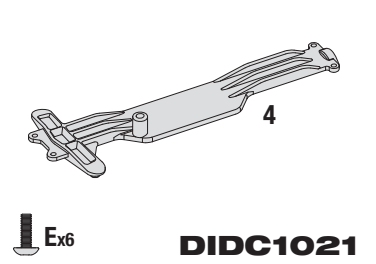

HINGE PIN HOLDER SET

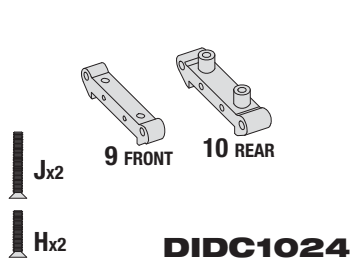

BATTERY HOLD-DOWN

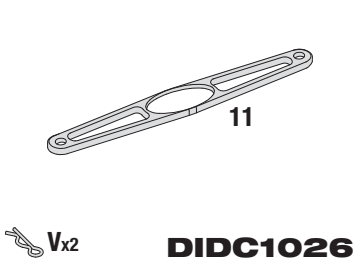

SPUR GEAR COVER

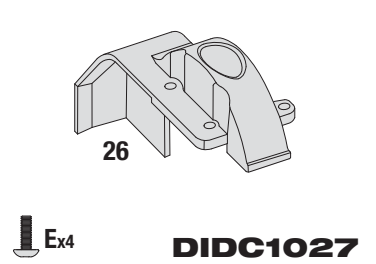

CHASSIS

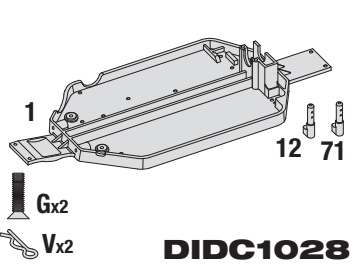

UPPER SHOCK MOUNT SET

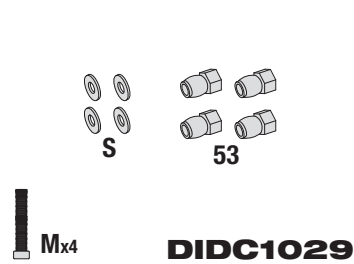

MOTOR MOUNT

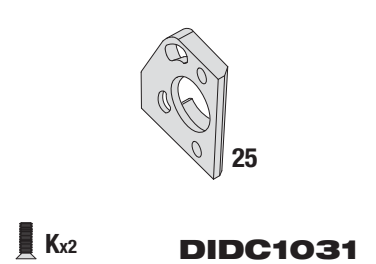

6-CELL 1300MAH BATTERY

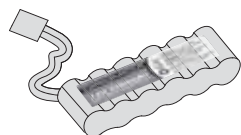

BALL STUD SET

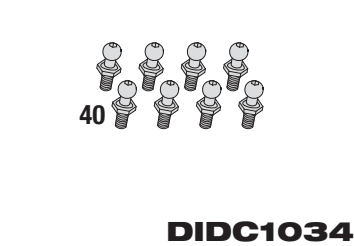

2x36.5MM HINGE PIN SET

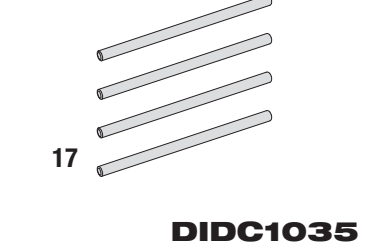

2x22MM HINGE PIN SET

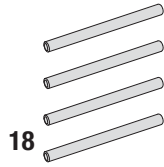

DIDC1036

2x16MM DIFF PIN SET



DIDC1037

**LONG SHOCK SPRINGS
(HEAVY/ORANGE)**

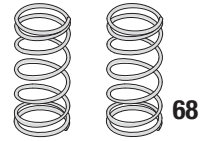

DIDC1040

LINKAGE SET

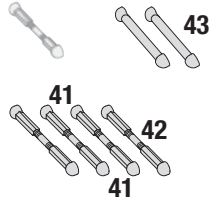

DIDC1042

FRONT BUMPER SET

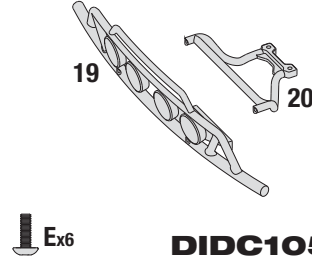

DIDC1052

SHOCK TOWER

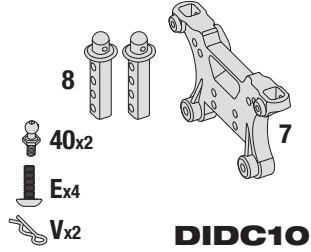

DIDC1054

ASSEMBLED DIFFERENTIAL

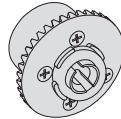

DIDC1061

DRIVE SHAFT SPACER SET

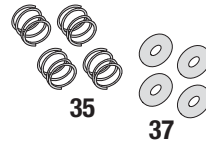

DIDC1062

BATTERY POST SET

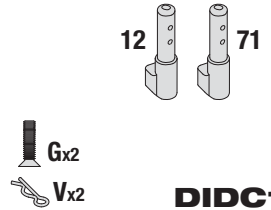

DIDC1063

ANTENNA TUBE & CAP

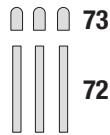

DIDC1064

SHOCK SHAFT SET

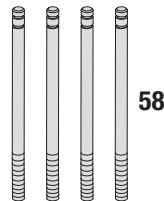

DIDC1066

6x10MM BALL BEARING



DIDC1070

8x12MM BALL BEARING

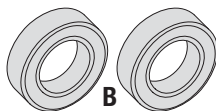

DIDC1071

SPARE WHEEL MOUNT

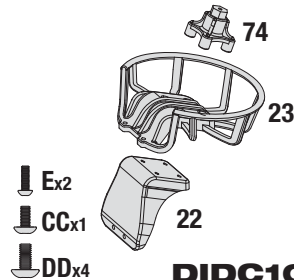

DIDC1072

ASSEMBLED WHEEL & TIRE SET

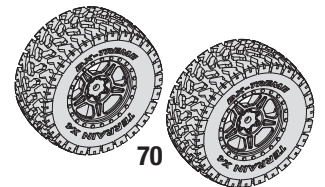

DIDC1080

LIGHT BAR

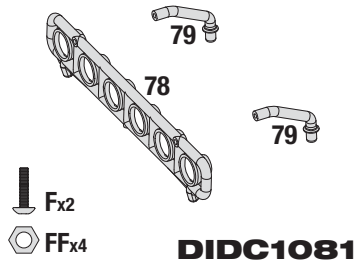

ROLL BAR SET

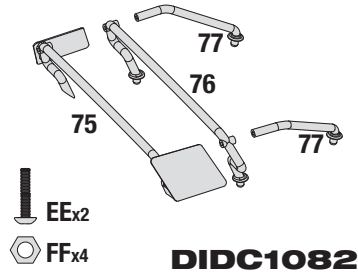

LED LIGHT SET

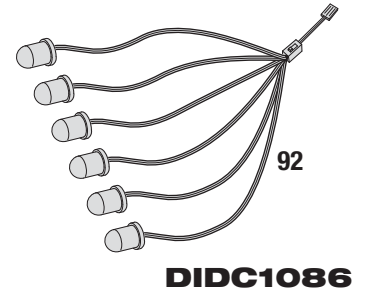

BODY W/DECALS DT4.18BL

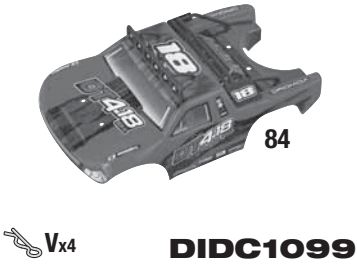

13T PINION GEAR

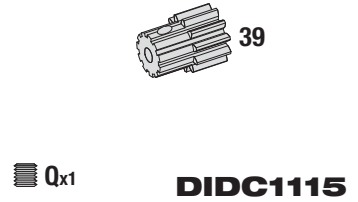

5300KV MOTOR



STEERING LINKAGE

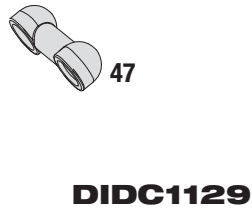

STEERING BELLCRANK

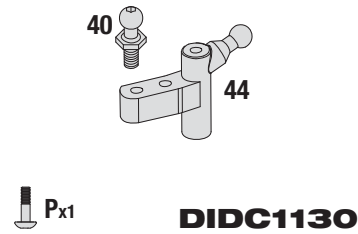

SERVO MOUNT



2.5x6mm SOCKET HEAD HEX SCREWS

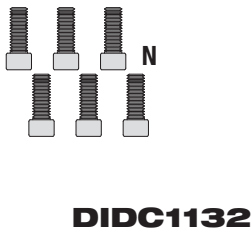

D100 TRANSMITTER



RX18 2.4GHz RECEIVER

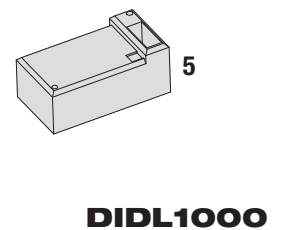

D-S100 SERVO

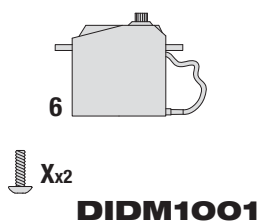

25A BRUSHLESS ESC

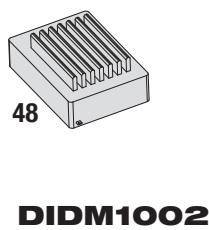

BATTERY CHARGER & MONITOR

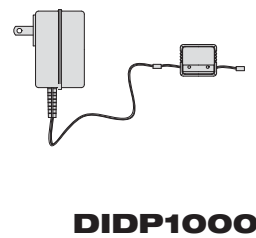

CHARGE MONITOR

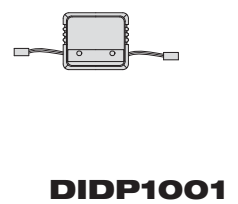

This parts list shows the key number, part description, and stock number for the replacement parts sets. When more than one stock number is listed, that part is available in multiple replacement parts sets.

#	Item Description	Available in Stock #	
1	Chassis.....	DIDC1028	59 Shock Seal RetainerDIDC1016
2	Lower Gearbox Half.....	DIDC1006	60 Shock Diaphragm.....DIDC1016
3	Upper Gearbox Half.....	DIDC1006	61 Shock Piston.....DIDC1016
4	Upper Chassis Brace.....	DIDC1021	62 Shock O-Ring.....DIDC1016
5	RX18 2.4GHz Receiver.....	DIDL1000	63 Shock O-Ring Spacer.....DIDC1016
6	D-S100 Servo.....	DIDM1001	64 Upper Shock Spring Retainer.....DIDC1016
7	Shock Tower.....	DIDC1054	65 Lower Shock Spring Retainer.....DIDC1016
8	Body Mount Post.....	DIDC1054	66 Shock End.....DIDC1016
9	Front Hinge Pin Holder.....	DIDC1024	68 Long Shock Spring (Heavy/Orange)..... DIDC1040
10	Rear Hinge Pin Holder.....	DIDC1024	69 Shock Pre-Load Spacer 1mm.....DIDC1016
11	Battery Hold Down.....	DIDC1026	69 Shock Pre-Load Spacer 2mm.....DIDC1016
12	Front Battery Post.....	DIDC1028, DIDC1063	69 Shock Pre-Load Spacer 4mm.....DIDC1016
13	Suspension Arm.....	DIDC1018	70 Wheel/Tire/Foam Insert Assembled..... DIDC1080
14	Front Hub Carrier.....	DIDC1012	71 Rear Battery Post..... DIDC1028, DIDC1063
15	Steering Knuckle.....	DIDC1013	72 Antenna Tube.....DIDC1064
16	Rear Hub.....	DIDC1014	73 Antenna Cap.....DIDC1064
17	2x36.5mm Pin (Inner Hinge).....	DIDC1035	74 Spare Tire Hub.....DIDC1072
18	2x22mm Pin (Outer Hinge, Steering).....	DIDC1036	75 Roll Bar Front.....DIDC1082
19	Front Bumper.....	DIDC1052	76 Roll Bar Rear.....DIDC1082
20	Front Bumper Brace.....	DIDC1052	77 Roll Bar Brace.....DIDC1082
22	Spare Tire Mount.....	DIDC1072	78 Light Bar.....DIDC1081
23	Spare Tire Cage.....	DIDC1072	79 Light Bar Brace.....DIDC1081
24	5300 kV Brushless Motor.....	DIDC1128	84 Body.....DIDC1099
25	Motor Mount.....	DIDC1031	92 Light Set.....DIDC1086
26	Spur Gear Cover.....	DIDC1027	93 Servo Mount.....DIDC1131
27	45 Tooth Spur Gear.....	DIDC1005	
28	15 Tooth Differential Pinion Gear.....	DIDC1003	HARDWARE
29	Center Drive Shaft.....	DIDC1007	A 6x10mm Ball Bearing..... DIDC1070
30	38T Differential Ring Gear...DIDC1003, DIDC1061		B 8x12mm Ball Bearing..... DIDC1071
31	Differential Case.....DIDC1004, DIDC1061		C 2x4mm Round Head Screw
32	Diff Bevel Gear (Small).....DIDC1002, DIDC1061		E 2x8mm Round Head Screw
33	Diff Bevel Gear (Large).....DIDC1002, DIDC1061		F 2x10mm Round Head Screw
34	2x16.5mm Pin (Diff Gear Pin).....	DIDC1037, DIDC1061	G 2x8mm Flat Head Screw
35	Dogbone Spring.....	DIDC1002, DIDC1062	H 2x10mm Flat Head Screw
36	Dogbone.....	DIDC1009	J 2x14mm Flat Head Screw
37	2x5mm O-Ring.....	DIDC1008, DIDC1062	K 2.5x8mm Flat Head Screw
38	Axle.....	DIDC1008	L 2.5x8mm Socket Head Cap Screw
39	13T Pinion Gear (.6 Mod, 2mm Shaft) ..DIDC1115		M 2.5x14mm Socket Head Cap Screw
40	Ball Stud.....	DIDC1034	N 2.5x6mm Socket Head Hex Screw.....DIDC1132
41	Ball Cup (Long).....	DIDC1042	P 2x8mm Round Head Shoulder Screw
42	Camber Rod.....	DIDC1042	Q 3x3mm Set Screw
43	Tie Rod.....	DIDC1042	R 3mm Nylon-Insert Lock Nut..... DIDC1001
44	Steering Bell Crank (Right).....	DIDC1130	S 2.6x5mm Washer
45	Steering Bell Crank (Left).....	DIDC1010	U 1.5mm E-Clip
46	Steering Drag Link.....	DIDC1010	V Body Clip (Small)..... DIDC1000
47	Steering Linkage.....	DIDC1129	X 2x6mm S/T Round Head Screw
48	BE18 25A Electronic Speed Control.....DIDM1002		CC 3x6mm S/T Button Head Screw
49	Servo Saver Spline.....	DIDC1011	DD 3x8mm S/T Button Head Screw
50	Servo Saver Arm.....	DIDC1011	EE 2x20mm Round Head Screw
51	Servo Saver Spring.....	DIDC1011	FF 4mm Nut
52	Servo Saver Cap.....	DIDC1011	
53	Upper Shock Mount.....	DIDC1029	
55	Shock Body.....	DIDC1016	
56	Shock Cap.....	DIDC1016	
58	Shock Shaft.....	DIDC1066, DIDC1016	

DT4.18™ BL

