

BX4.18™ BL

REPLACEMENT PARTS

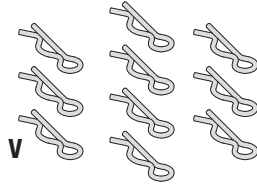

BODY CLIP



DIDC1000

3MM NYLON INSERT LOCK NUT

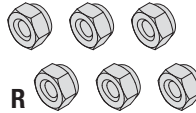

DIDC1001

DIFF BEVEL GEAR SET

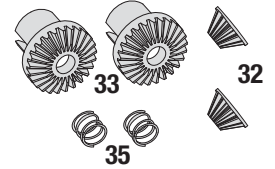

DIDC1002

DIFF RING & PINION GEAR SET

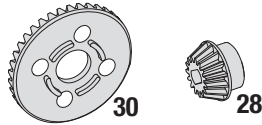

DIDC1003

DIFFERENTIAL CASE

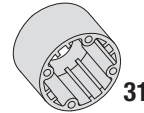

DIDC1004

45T SPUR GEAR

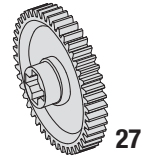

DIDC1005

GEARBOX SET

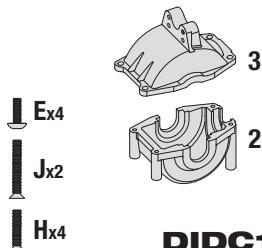

DIDC1006

CENTER DRIVE SHAFT

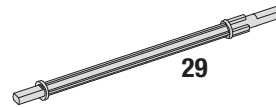

DIDC1007

AXLE SET

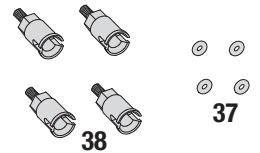

DIDC1008

DOGBONE SET

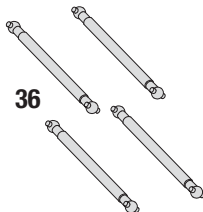

DIDC1009

STEERING BELLCRANK SET

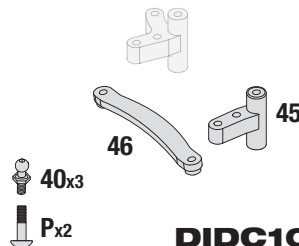

DIDC1010

SERVO SAVER SET

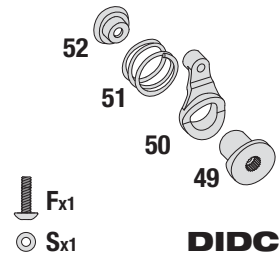

DIDC1011

FRONT HUB CARRIER SET

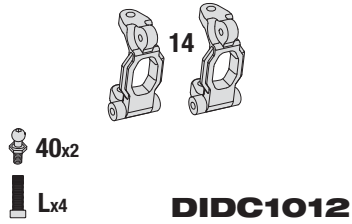

STEERING KNUCKLE SET

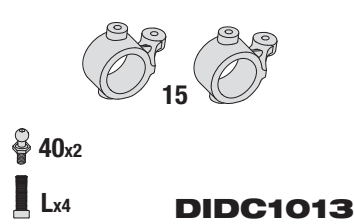

REAR HUB SET

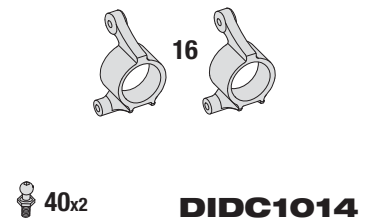

ASSEMBLED SHORT SHOCK SET

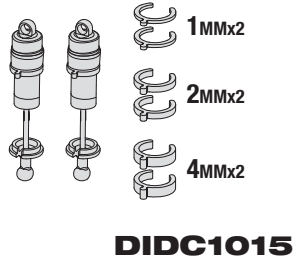

ASSEMBLED LONG SHOCK SET

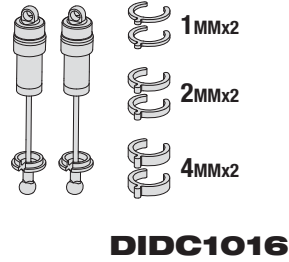

ASSEMBLED WHEEL & TIRE SET



SUSPENSION ARM SET

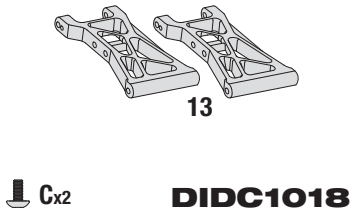

FRONT SHOCK TOWER

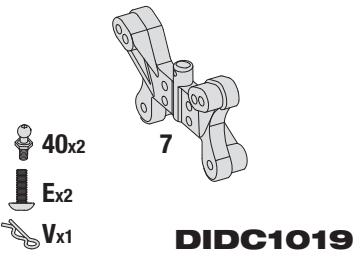

REAR SHOCK TOWER

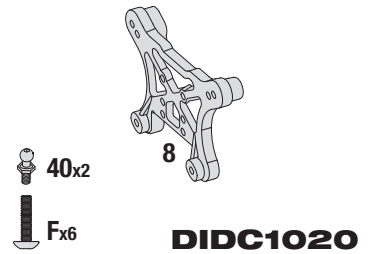

UPPER CHASSIS BRACE

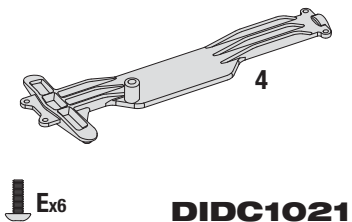

REAR WING

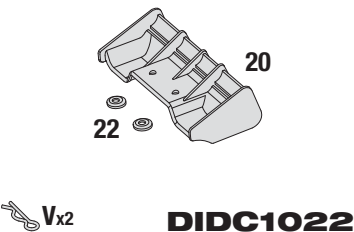

WING MOUNT

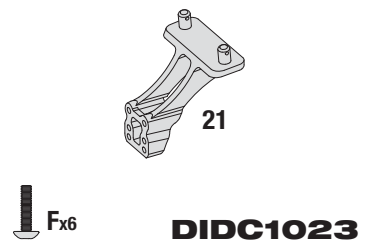

HINGE PIN HOLDER SET

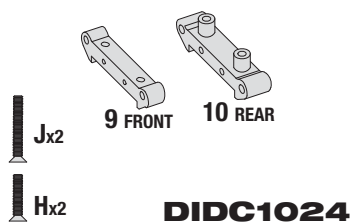

FRONT BUMPER

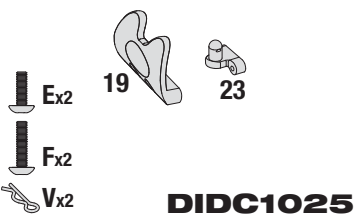

BATTERY HOLD-DOWN

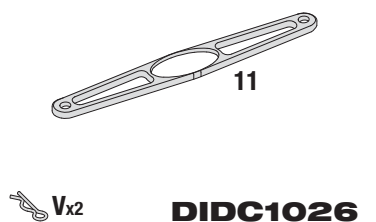

SPUR GEAR COVER

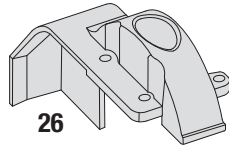

Ex4

DIDC1027

CHASSIS

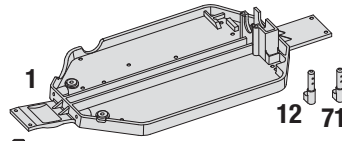

Gx2
Vx2

DIDC1028

UPPER SHOCK MOUNT SET

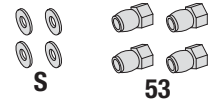

Mx4

DIDC1029

MOTOR MOUNT

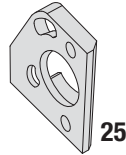

Kx2

DIDC1031

6-CELL 1300MAH BATTERY

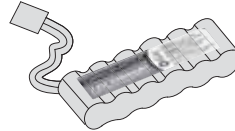

DIDC1033

BALL STUD SET



DIDC1034

2x36.5MM HINGE PIN SET

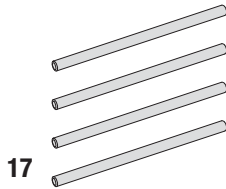

DIDC1035

2x22MM HINGE PIN SET

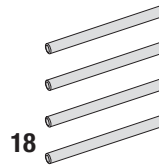

DIDC1036

2x16MM DIFF PIN SET



DIDC1037

LONG SHOCK SPRINGS (SOFT/RED)

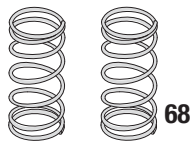

DIDC1039

LINKAGE SET

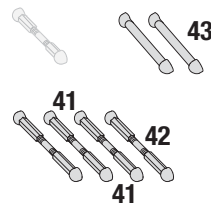

DIDC1042

SHORT SHOCK SPRINGS (MEDIUM/LIGHT BLUE)

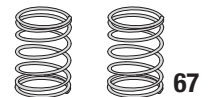

DIDC1043

HARDWARE SET

- Cx10** 2x4MM
- E_x29** 2x8MM
- Fx7** 2x10MM
- Gx9** 2x8MM
- Hx6** 2x10MM
- Jx2** 2x14MM
- Kx2** 2.5x8MM
- Lx4** 2.5x8MM
- Mx4** 2.5x14MM
- Nx2** 2.5x6MM
- Px2** 2x8MM
- Qx1** 3x3MM
- Rx4** 3MM
- Sx5** 2.6x5MM
- Ux8** 1.5x6MM
- Vx6** 3x3MM
- Xx2** 2x6MM

DIDC1057

ASSEMBLED DIFFERENTIAL

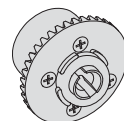

DIDC1061

DRIVE SHAFT SPACER SET

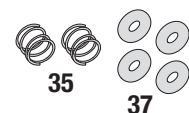

DIDC1062

BATTERY POST SET

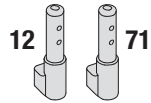

DIDC1063

ANTENNA TUBE & CAP

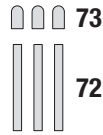

DIDC1064

SHOCK SHAFT SET

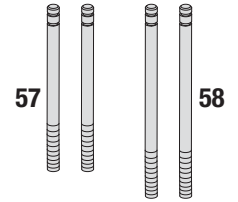

DIDC1065

6x10MM BALL BEARING

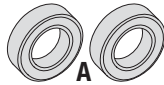

DIDC1070

8x12MM BALL BEARING

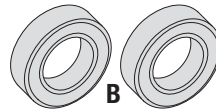

DIDC1071

BODY W/DECALS BX4.18BL



DIDC1095

13T PINION GEAR

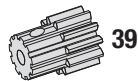

DIDC1115

5300KV MOTOR



DIDC1128

STEERING LINKAGE

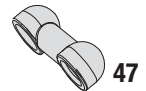

DIDC1129

STEERING BELLCRANK

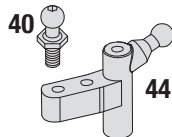

DIDC1130

SERVO MOUNT

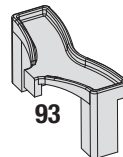

DIDC1131

2.5x6mm SOCKET HEAD HEX SCREWS

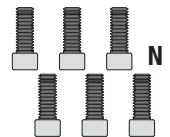

DIDC1132

D100 TRANSMITTER

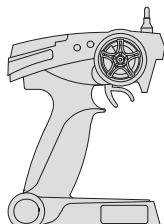

DIDJ1000

RX18 2.4GHz RECEIVER

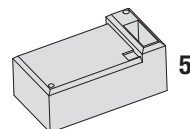

DIDL1000

D-S100 SERVO

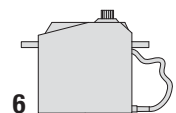

DIDM1001

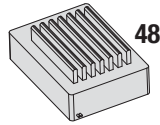
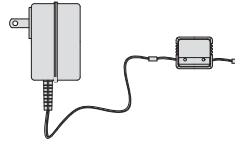
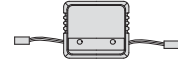
25A BRUSHLESS ESC**DIDM1002****BATTERY CHARGER & MONITOR****DIDP1000****CHARGE MONITOR****DIDP1001**

This parts list shows the key number, part description, and stock number for the replacement parts sets. When more than one stock number is listed, that part is available in multiple replacement parts sets.

#	Item Description	Available in Stock #	#	Item Description	Available in Stock #
1	Chassis.....	DIDC1028	50	Servo Saver Arm.....	DIDC1011
2	Lower Gearbox Half.....	DIDC1006	51	Servo Saver Spring.....	DIDC1011
3	Upper Gearbox Half.....	DIDC1006	52	Servo Saver Cap.....	DIDC1011
4	Upper Chassis Brace.....	DIDC1021	53	Upper Shock Mount.....	DIDC1029
5	RX18 2.4GHz Receiver.....	DIDL1000	54	Shock Body (Short).....	DIDC1015
6	Servo.....	DIDM1001	55	Shock Body (Long).....	DIDC1016
7	Front Shock Tower.....	DIDC1019	56	Shock Cap.....	DIDC1015, DIDC1016
8	Rear Shock Tower.....	DIDC1020	57	Shock Shaft (Short).....	DIDC1065, DIDC1015
9	Front Hinge Pin Holder.....	DIDC1024	58	Shock Shaft (Long).....	DIDC1065, DIDC1016
10	Rear Hinge Pin Holder.....	DIDC1024	59	Shock Seal Retainer.....	DIDC1015, DIDC1016
11	Battery Hold Down.....	DIDC1026	60	Shock Diaphragm.....	DIDC1015, DIDC1016
12	Front Battery Post.....	DIDC1028, DIDC1063	61	Shock Piston.....	DIDC1015, DIDC1016
13	Suspension Arm.....	DIDC1018	62	Shock O-Ring.....	DIDC1015, DIDC1016
14	Front Hub Carrier.....	DIDC1012	63	Shock O-Ring Spacer.....	DIDC1015, DIDC1016
15	Steering Knuckle.....	DIDC1013	64	Upper Shock Spring Retainer.....	DIDC1015, DIDC1016
16	Rear Hub.....	DIDC1014	65	Lower Shock Spring Retainer.....	DIDC1015, DIDC1016
17	2x36.5mm Pin (Inner Hinge).....	DIDC1035	66	Shock End.....	DIDC1015, DIDC1016
18	2x22mm Pin (Outer Hinge, Steering).....	DIDC1036	67	Shock Spring (Short/Med/Lt Blue).....	DIDC1043
19	Front Bumper.....	DIDC1025	68	Shock Spring (Long/Soft/Red).....	DIDC1039
20	Rear Wing.....	DIDC1022	69	Shock Pre-Load Spacer 1mm.....	DIDC1015, DIDC1016
21	Wing Mount.....	DIDC1023	69	Shock Pre-Load Spacer 2mm.....	DIDC1015, DIDC1016
22	Wing Washer.....	DIDC1022	69	Shock Pre-Load Spacer 4mm.....	DIDC1015, DIDC1016
23	Rear Body Mount.....	DIDC1025	70	Wheel/Tire/Foam Insert Assembled.....	DIDC1017
24	5300kV Brushless Motor.....	DIDC1128	71	Rear Battery Post.....	DIDC1028, DIDC1063
25	Motor Mount.....	DIDC1031	72	Antenna Tube.....	DIDC1064
26	Spur Gear Cover.....	DIDC1027	73	Antenna Cap.....	DIDC1064
27	45 Tooth Spur Gear.....	DIDC1005	93	Servo Mount.....	DIDC1131
28	15 Tooth Differential Pinion Gear.....	DIDC1003			
29	Center Drive Shaft.....	DIDC1007			
30	38T Differential Ring Gear.....	DIDC1003, DIDC1061			
31	Differential Case.....	DIDC1004, DIDC1061			
32	Diff Bevel Gear (Small).....	DIDC1002, DIDC1061			
33	Diff Bevel Gear (Large).....	DIDC1002, DIDC1061			
34	2x16.5mm Pin (Diff Gear Pin).....	DIDC1037, DIDC1061			
35	Dogbone Spring.....	DIDC1002, DIDC1062			
36	Dogbone.....	DIDC1009			
37	2x5mm O-Ring.....	DIDC1008, DIDC1062			
38	Axle.....	DIDC1008			
39	13T Pinion Gear.....	DIDC1115			
40	Ball Stud.....	DIDC1034			
41	Ball Cup (Long).....	DIDC1042			
42	Camber Rod.....	DIDC1042			
43	Tie Rod.....	DIDC1042			
44	Steering Bell Crank (Right).....	DIDC1130			
45	Steering Ball Crank (Left).....	DIDC1010			
46	Steering Drag Link.....	DIDC1010			
47	Steering Linkage.....	DIDC1129			
48	BE18 25A Electronic Speed Control.....	DIDM1002			
49	Servo Saver Spline.....	DIDC1011			

HARDWARE	
A	6x10mm Ball Bearing..... DIDC1070
B	8x12mm Ball Bearing..... DIDC1071
C	2x4mm Round Head Screw..... DIDC1057
E	2x8mm Round head Screw..... DIDC1057
F	2x10mm Round Head Screw..... DIDC1057
G	2x8mm Flat Head Screw..... DIDC1057
H	2x10mm Flat Head Screw..... DIDC1057
J	2x14mm Flat Head Screw..... DIDC1057
K	2.5x8mm Flat Head Screw..... DIDC1057
L	2.5x8mm Socket Head Cap Screw..... DIDC1057
M	2.5x14mm Socket Head Cap Screw..... DIDC1057
N	2.5x6mm Socket Head Hex Screw..... DIDC1132
P	2x8mm Round Head Shoulder Screw..... DIDC1057
Q	3x3mm Set Screw..... DIDC1057
R	3mm Nylon-Insert Lock Nut..... DIDC1001, DIDC1057
S	2.6x5mm Washer..... DIDC1057
U	1.5mm E-Clip..... DIDC1057
V	Body Clip (Small)..... DIDC1000, DIDC1057
X	2x6mm S/T Round Head Screw..... DIDC1057

BX4.18 BL

