

# BUGGY™

## REPLACEMENT PARTS

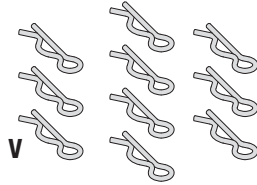

### BODY CLIP



**DIDC1000**

### 3MM NYLON INSERT LOCK NUT

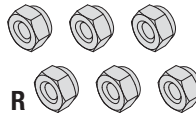

**DIDC1001**

### DIFF BEVEL GEAR SET

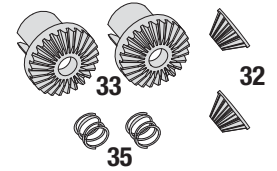

**DIDC1002**

### DIFF RING & PINION GEAR SET

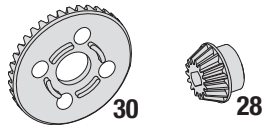

**DIDC1003**

### DIFFERENTIAL CASE

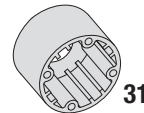

**DIDC1004**

### 45T SPUR GEAR

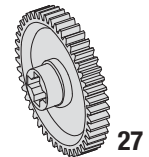

**DIDC1005**

### GEARBOX SET

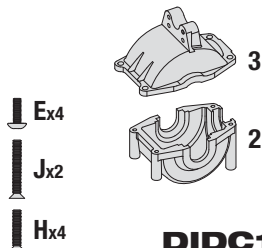

**DIDC1006**

### CENTER DRIVE SHAFT

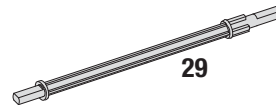

**DIDC1007**

### AXLE SET

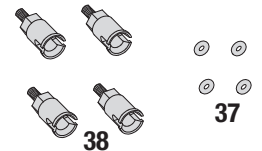

**DIDC1008**

### DOGBONE SET

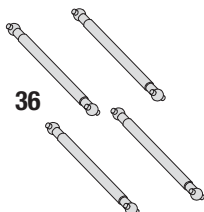

**DIDC1009**

### STEERING BELLCRANK SET

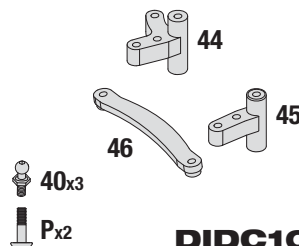

**DIDC1010**

### FRONT HUB CARRIER SET

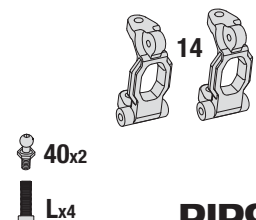

**DIDC1012**

**STEERING KNUCKLE SET**

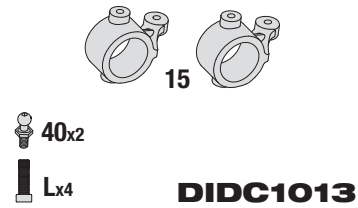

**REAR HUB SET**

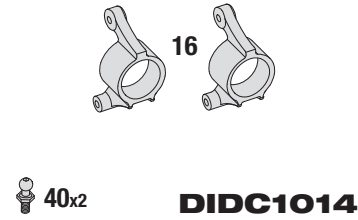

**ASSEMBLED SHORT SHOCK SET**

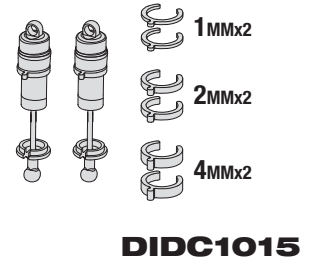

**ASSEMBLED LONG SHOCK SET**

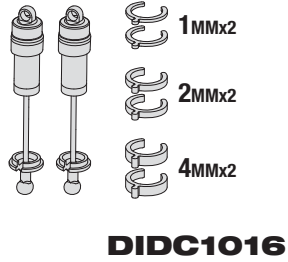

**ASSEMBLED WHEEL & TIRE SET**

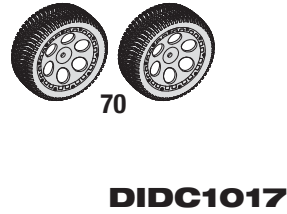

**SUSPENSION ARM SET**

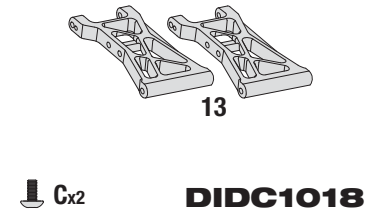

**FRONT SHOCK TOWER**

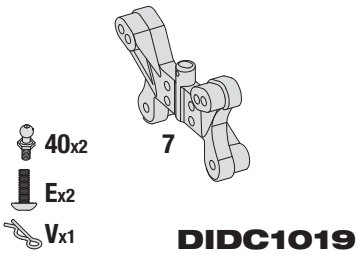

**REAR SHOCK TOWER**

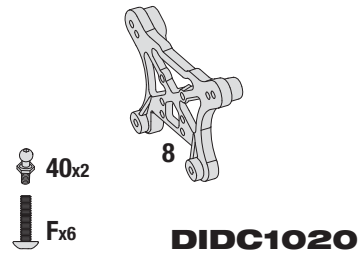

**UPPER CHASSIS BRACE**

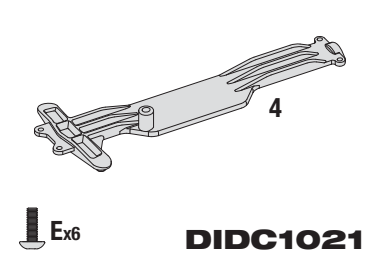

**REAR WING**

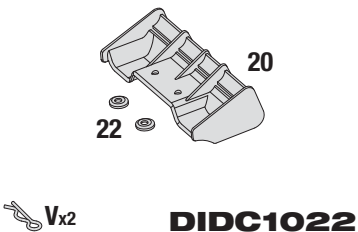

**WING MOUNT**

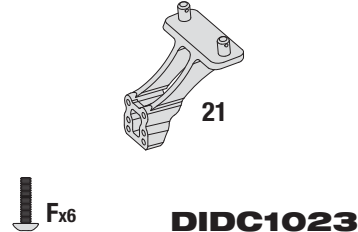

**HINGE PIN HOLDER SET**

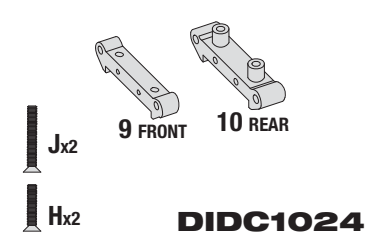

**FRONT BUMPER**

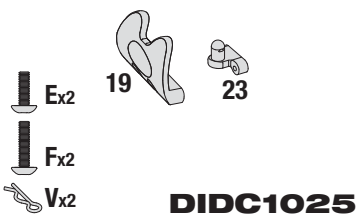

**BATTERY HOLD-DOWN**

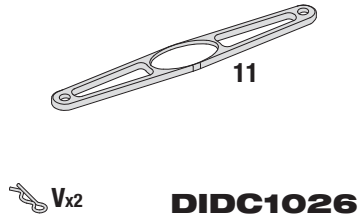

**SPUR GEAR COVER**

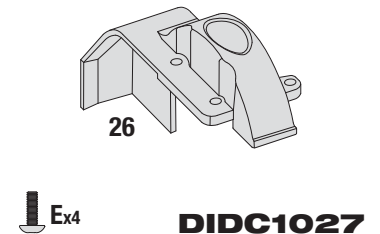

**CHASSIS**

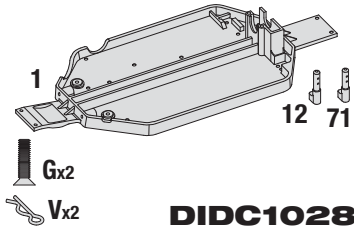

**DIDC1028**

**UPPER SHOCK MOUNT SET**

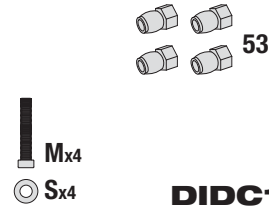

**DIDC1029**

**MOTOR MOUNT**

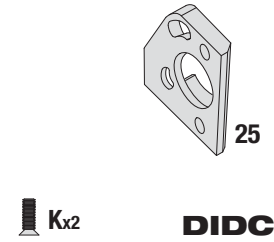

**DIDC1031**

**12T PINION GEAR**

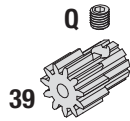

**DIDC1032**

**6-CELL 1300MAH BATTERY**

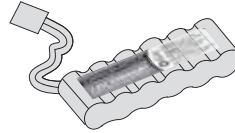

**DIDC1033**

**BALL STUD SET**



**DIDC1034**

**2x36.5MM HINGE PIN SET**

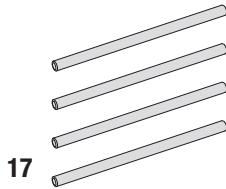

**DIDC1035**

**2x22MM HINGE PIN SET**

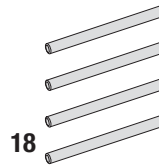

**DIDC1036**

**2x16.5MM DIFF PIN SET**



**DIDC1037**

**LONG SHOCK SPRINGS  
(SOFT/RED)**

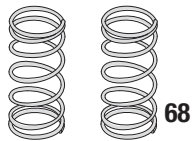

**DIDC1039**

**LINKAGE SET**

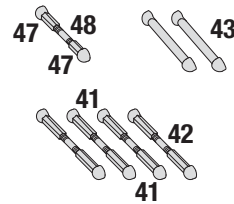

**DIDC1042**

**SHORT SHOCK SPRINGS  
(MEDIUM/LIGHT BLUE)**

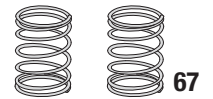

**DIDC1043**

**ASSEMBLED DIFFERENTIAL**

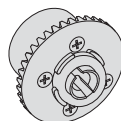

**DIDC1061**

**DRIVE SHAFT SPACER SET**

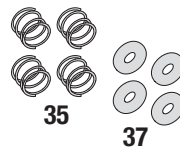

**DIDC1062**

**BATTERY POST SET**

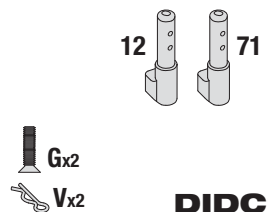

**DIDC1063**

**ANTENNA TUBE & CAP**



**DIDC1064**

**SHOCK SHAFT SET**

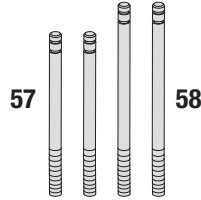

**DIDC1065**

**SHOCK PLASTIC PARTS SET**

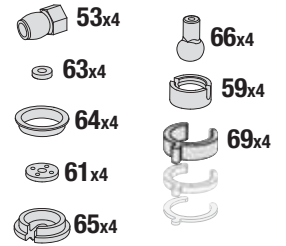

**DIDC1067**

**6x10MM BALL BEARING**

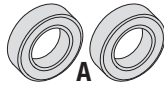

**DIDC1070**

**8x12MM BALL BEARING**

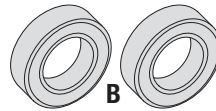

**DIDC1071**

**M370 MOTOR**

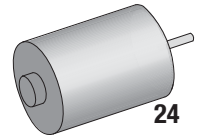

**DIDC1193**

**SERVO SAVER SET**

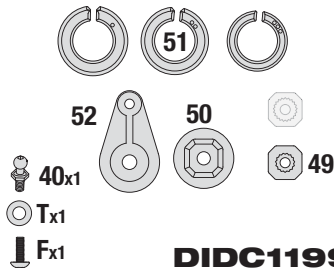

**DIDC1199**

**BODY SET**

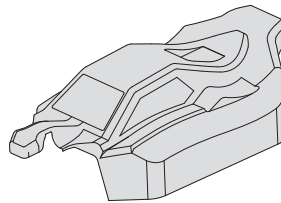

**DIDC1200**

**TRANSMITTER**

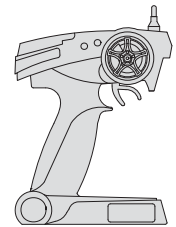

**DIDJ1001**

**D-S101 SERVO**

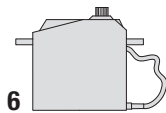

X2

**DIDM1005**

**RE-183 RECEIVER/ESC UNIT**

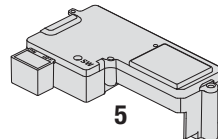

**DIDM1004**

**6-CELL NIMH AC CHARGER**

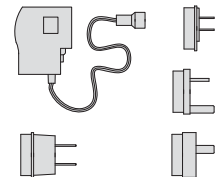

**DIDP1003**

**HARDWARE SET**



Cx10  
2x4MM



Gx9  
2x8MM

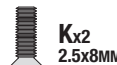

Kx2  
2.5x8MM



Nx2  
3x6MM



Ex29  
2x8MM



Hx6  
2x10MM

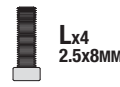

Lx4  
2.5x8MM

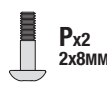

Px2  
2x8MM

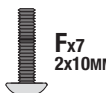

Fx7  
2x10MM



Jx2  
2x14MM

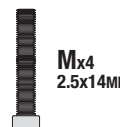

Mx4  
2.5x14MM



Qx1  
3x3MM



Rx4  
3MM



Sx4  
2.6x5MM



Tx3  
3x6MM



Ux8  
1.5x6MM



Vx6  
3x3MM



Xx2  
2x6MM

**DIDC1057**

*This parts list shows the key number part description, and stock number for the replacement parts sets. When more than one stock number is listed that part is available in multiple replacement parts sets.*

<b>#</b>	<b>Item Description</b>	<b>Available in Stock #</b>	<b>#</b>	<b>Item Description</b>	<b>Available in Stock #</b>
1	Chassis .....	DIDC1028	53	Upper Shock Mount .....	DIDC1067, DIDC1029
2	Lower Gearbox Half .....	DIDC1006	54	Front Shock Body (Short).....	DIDC1015
3	Upper Gearbox Half.....	DIDC1006	55	Rear Shock Body (Long) .....	DIDC1016
4	Upper Chassis Brace.....	DIDC1021	56	Shock Cap.....	DIDC1015, DIDC1016
5	RE-18 Receiver/ESC Unit.....	DIDM1000	57	Front Shock Shaft (Short) .....	DIDC1065, DIDC1015
6	Servo .....	DIDM1005	58	Rear Shock Shaft (Long).....	DIDC1065, DIDC1016
7	Front Shock Tower.....	DIDC1019	59	Shock Seal Retainer .....	DIDC1067, DIDC1015, DIDC1016
8	Rear Shock Tower.....	DIDC1020	60	Shock Diaphragm .....	DIDC1015, DIDC1016
9	Front Hinge Pin Holder .....	DIDC1024	61	Shock Piston.....	DIDC1067, DIDC1015, DIDC1016
10	Rear Hinge Pin Holder .....	DIDC1024	62	Shock O-Ring.....	DIDC1015, DIDC1016
11	Battery Hold Down.....	DIDC1026	63	Shock O-Ring Spacer.....	DIDC1067, DIDC1015, DIDC1016
12	Front Battery Post.....	DIDC1028, DIDC1063	64	Upper Shock Spring Retainer .....	DIDC1067, DIDC1015, DIDC1016
13	Suspension Arm.....	DIDC1018	65	Lower Shock Spring Retainer.....	DIDC1067, DIDC1015, DIDC1016
14	Front Hub Carrier (C-Hub).....	DIDC1012	66	Shock End.....	DIDC1015, DIDC1016
15	Steering Knuckle .....	DIDC1013	67	Shock Spring Short (Med/Lt Blue) .....	DIDC1043
16	Rear Hub .....	DIDC1014	68	Shock Spring Long (Soft/Red).....	DIDC1039
17	2x36.5mm Pin (Inner Hinge Pin).....	DIDC1035	69	Shock Pre-Load Spacers .....	DIDC1067, DIDC1015, DIDC1016
18	2x22mm Pin (Outer Hinge Pin, Steering Pivot)	DIDC1036	70	Wheel/Tire/Foam Assembled .....	DIDC1017
19	Bumper .....	DIDC1025	71	Rear Battery Post.....	DIDC1028, DIDC1063
20	Rear Wing .....	DIDC1022	72	Antenna Tube .....	DIDC1064
21	Wing Mount .....	DIDC1023	73	Antenna Cap .....	DIDC1064
22	Wing Washer.....	DIDC1022			
23	Rear Body Mount .....	DIDC1025			
24	Torque 370 Motor 35T.....	DIDC1193			
25	Motor Mount.....	DIDC1031			
26	Spur Gear Cover.....	DIDC1027			
27	45 Tooth Spur Gear .....	DIDC1005			
28	15 Tooth Differential Pinion Gear .....	DIDC1003			
29	Center Drive Shaft .....	DIDC1007			
30	38 Tooth Differential Ring Gear.....	DIDC1003 DIDC1061			
31	Differential Case .....	DIDC1004, DIDC1061			
32	Diff Bevel Gear (Small).....	DIDC1002, DIDC1061			
33	Diff Output/Bevel Gear (Large).....	DIDC1002 DIDC1061			
34	2x16.5mm Pin (Diff Gear Pin).....	DIDC1037 DIDC1061			
35	Dogbone Spring.....	DIDC1002, DIDC1062			
36	Dogbone.....	DIDC1009			
37	2 x 5mm O-Ring.....	DIDC1008, DIDC1062			
38	Axle.....	DIDC1008			
39	12T Pinion Gear .....	DIDC1032			
40	Ball Stud .....	DIDC1034			
41	Ball Cup (Long) .....	DIDC1042			
42	Camber Rod.....	DIDC1042			
43	Tie Rod .....	DIDC1042			
44	Steering Bell Crank (Right) .....	DIDC1010			
45	Steering Ball Cranks (Left).....	DIDC1010			
46	Steering Drag Link.....	DIDC1010			
47	Ball End (Short).....	DIDC1042			
48	Steering Rod.....	DIDC1042			
49	Servo Saver Spline .....	DIDC1199			
50	Servo Saver Base .....	DIDC1199			
51	Servo Saver Spring.....	DIDC1199			
52	Servo Saver Arm.....	DIDC1199			

**HARDWARE**

<b>A</b>	6x10mm Ball Bearing .....	DIDC1070
<b>B</b>	8x12mm Ball Bearing .....	DIDC1071
<b>C</b>	2x4mm Round Head Screw .....	DIDC1057
<b>E</b>	2x8mm Round head Screw.....	DIDC1057
<b>F</b>	2x10mm Round Head Screw .....	DIDC1057
<b>G</b>	2x8mm Flat Head Screw .....	DIDC1057
<b>H</b>	2x10mm Flat Head Screw .....	DIDC1057
<b>J</b>	2x14mm Flat Head Screw .....	DIDC1057
<b>K</b>	2.5x8mm Flat Head Screw .....	DIDC1057
<b>L</b>	2.5x8mm Socket Head Cap Screw .....	DIDC1057
<b>M</b>	2.5x14mm Socket Head Cap Screw .....	DIDC1057
<b>N</b>	3x6mm Socket Head Cap Screw .....	DIDC1057
<b>P</b>	2x8mm Round Head Shoulder Screw.....	DIDC1057
<b>Q</b>	3x3mm Set Screw .....	DIDC1057
<b>R</b>	3mm Nylon-Insert Lock Nut.....	DIDC1001, DIDC1057
<b>S</b>	2.6x5mm Washer .....	DIDC1057
<b>T</b>	3x6mm Washer.....	DIDC1057
<b>U</b>	1.5mm E-Clip.....	DIDC1057
<b>V</b>	Body Clip (Small).....	DIDC1000, DIDC1057
<b>X</b>	2x6mm S/T Round Head Screw.....	DIDC1057

# BUGGY™

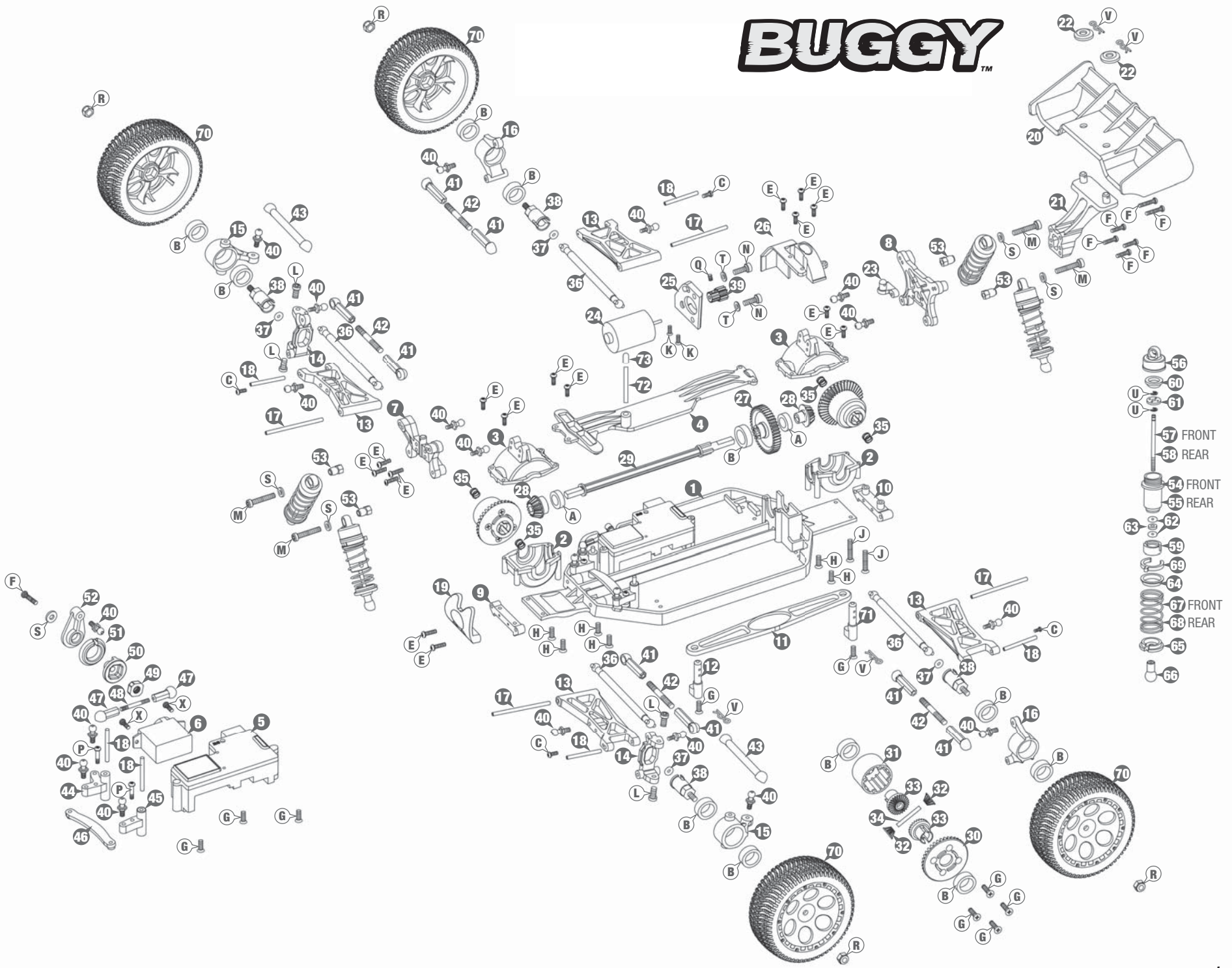

- 56
- 60
- 61
- 57 FRONT
- 58 REAR
- 54 FRONT
- 55 REAR
- 63
- 62
- 59
- 69
- 64
- 67 FRONT
- 68 REAR
- 65
- 66