

SHORT COURSE TRUCK™

REPLACEMENT PARTS

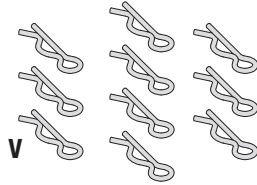

BODY CLIP



DIDC1000

3MM NYLON INSERT LOCK NUT

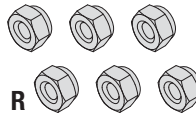

DIDC1001

DIFF BEVEL GEAR SET

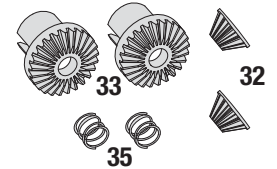

DIDC1002

DIFF RING & PINION GEAR SET

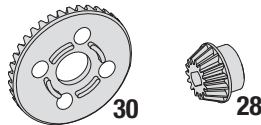

DIDC1003

DIFFERENTIAL CASE

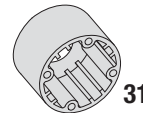

DIDC1004

45T SPUR GEAR

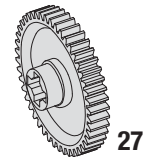

DIDC1005

GEARBOX SET

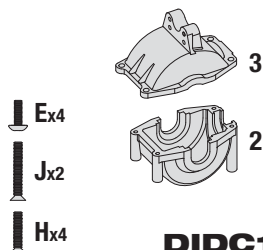

DIDC1006

CENTER DRIVE SHAFT



DIDC1007

AXLE SET

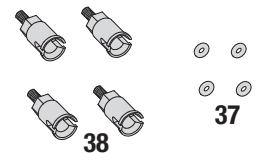

DIDC1008

DOGBONE SET

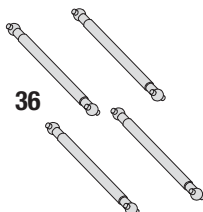

DIDC1009

STEERING BELLCRANK SET

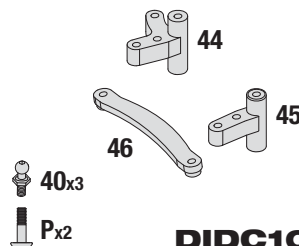

DIDC1010

FRONT HUB CARRIER SET

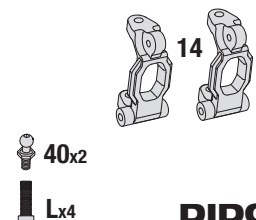

DIDC1012

STEERING KNUCKLE SET

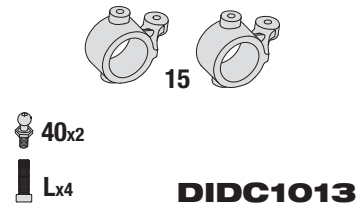

REAR HUB SET

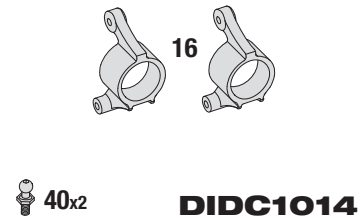

ASSEMBLED LONG SHOCK SET

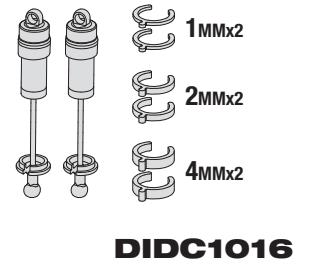

SUSPENSION ARM SET

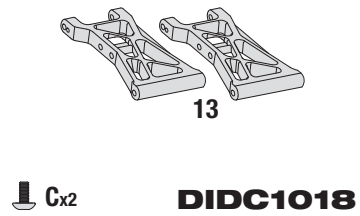

UPPER CHASSIS BRACE

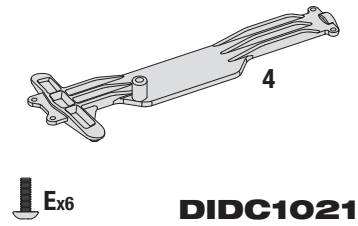

HINGE PIN HOLDER SET

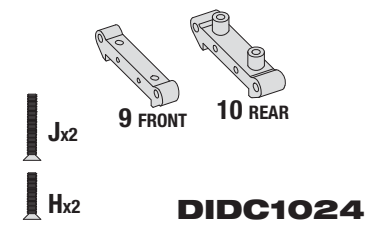

BATTERY HOLD-DOWN

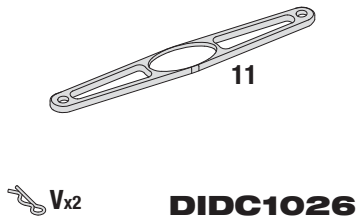

SPUR GEAR COVER

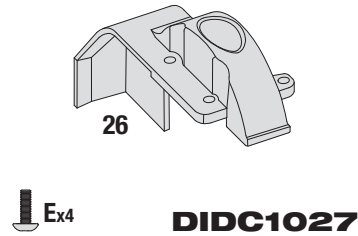

CHASSIS

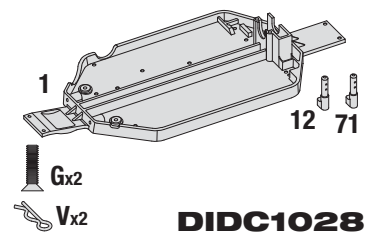

UPPER SHOCK MOUNT SET

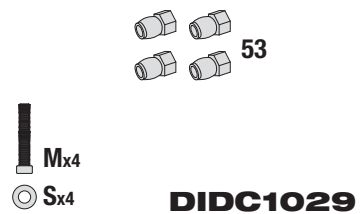

MOTOR MOUNT

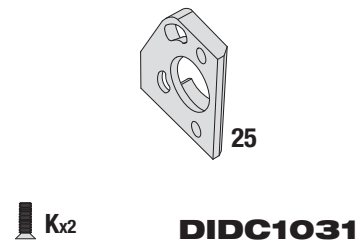

12T PINION GEAR

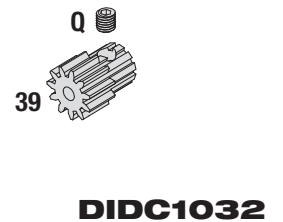

6-CELL 1300MAH BATTERY

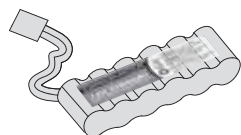

BALL STUD SET

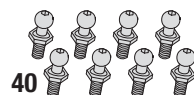

2x36.5MM HINGE PIN SET



2x22MM HINGE PIN SET

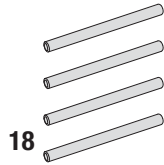

DIDC1036

2x16.5MM DIFF PIN SET



DIDC1037

**LONG SHOCK SPRINGS
(HEAVY/ORANGE)**

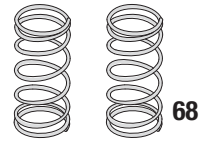

DIDC1040

LINKAGE SET

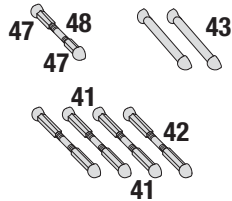

DIDC1042

FRONT BUMPER SET

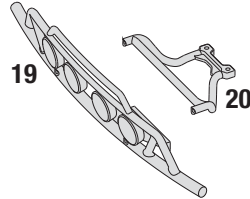

DIDC1052

REAR BUMPER SET

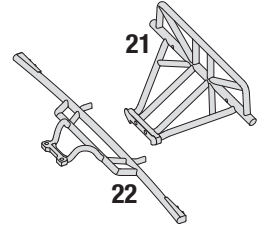

DIDC1053

SHOCK TOWER

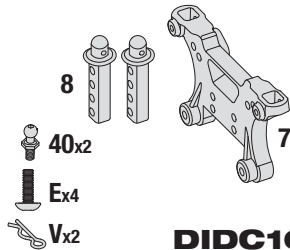

DIDC1054

MUD FLAP SET

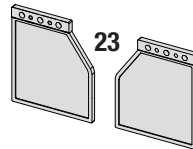

DIDC1055

ASSEMBLED WHEEL & TIRE SET

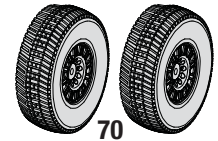

DIDC1056

ASSEMBLED DIFFERENTIAL

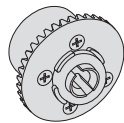

DIDC1061

DRIVE SHAFT SPACER SET

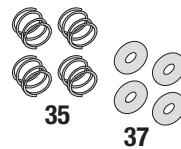

DIDC1062

BATTERY POST SET

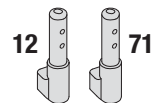

DIDC1063

ANTENNA TUBE & CAP

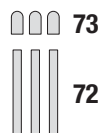

DIDC1064

SHOCK SHAFT SET

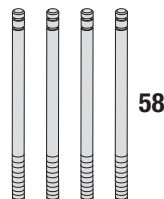

DIDC1066

SHOCK PLASTIC PARTS SET

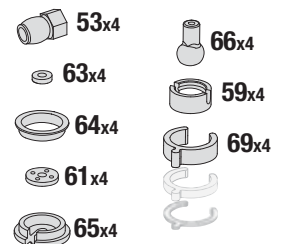

DIDC1067

6x10MM BALL BEARING

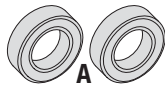

DIDC1070

8x12MM BALL BEARING

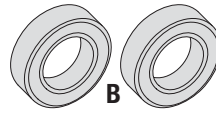

DIDC1071

TORQUE 370 MOTOR 35T

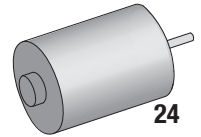

DIDC1193

SERVO SAVER SET

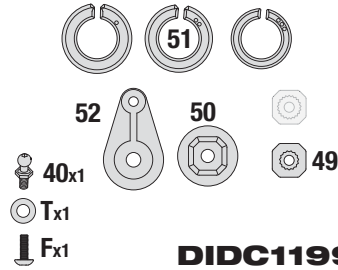

DIDC1199

BODY SHORT COURSE

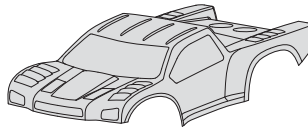

DIDC1203

TRANSMITTER

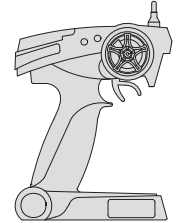

DIDJ1001

D-S100 SERVO w/SERVO SAVER

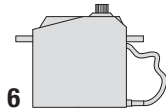

Xx2

DIDM1005

RE-183 RECEIVER/ESC UNIT

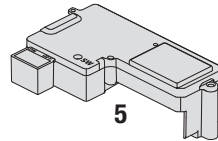

DIDM1004

6-CELL NIMH AC CHARGER

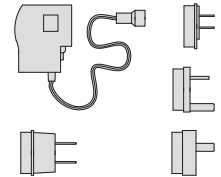

DIDP1003

HARDWARE SET



Cx10
2x4MM



Gx9
2x8MM

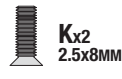

Kx2
2.5x8MM

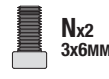

Nx2
3x6MM



Ex29
2x8MM



Hx6
2x10MM

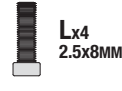

Lx4
2.5x8MM

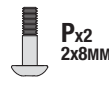

Px2
2x8MM

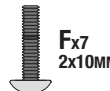

Fx7
2x10MM

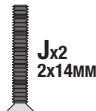

Jx2
2x14MM

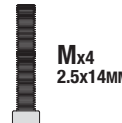

Mx4
2.5x14MM



Qx1
3x3MM



Rx4
3MM



Sx4
2.6x5MM



Tx3
3x6MM



Ux8
1.5x6MM



Vx6
3x3MM



Xx2
2x6MM

DIDC1057

This parts list shows the key number, part description, and stock number for the replacement parts sets. When more than one stock number is listed, that part is available in multiple replacement parts sets.

#	Item Description	Available in Stock #	#	Item Description	Available in Stock #
1	Chassis	DIDC1028	58	Shock Shaft	DIDC1066, DIDC1016
2	Lower Gearbox Half	DIDC1006	59	Shock Seal Retainer	DIDC1016, DIDC1067
3	Upper Gearbox Half.....	DIDC1006	60	Shock Diaphragm	DIDC1016
4	Upper Chassis Brace.....	DIDC1021	61	Shock Piston.....	DIDC1016, DIDC1067
5	RE-183 Receiver/ESC Unit	DIDM1004	#	Item Description	Available in Stock #
6	Servo w/Servo Saver	DIDM1005	62	Shock O-Ring.....	DIDC1016
7	Shock Tower	DIDC1054	63	Shock O-Ring Spacer.....	DIDC1016, DIDC1067
8	Body Mount.....	DIDC1054	64	Upper Shock Spring Retainer	DIDC1016, DIDC1067
9	Front Hinge Pin Holder	DIDC1024	65	Lower Shock Spring Retainer.....	DIDC1016, DIDC1067
10	Rear Hinge Pin Holder	DIDC1024	66	Shock End.....	DIDC1016, DIDC1067
11	Battery Hold Down.....	DIDC1026	68	Long Shock Spring (Heavy/Orange).....	DIDC1040
12	Front Battery Post.....	DIDC1028, DIDC1063	69	Shock Pre-Load Spacer 1mm.....	DIDC1016, DIDC1067
13	Suspension Arm.....	DIDC1018	69	Shock Pre-Load Spacer 2mm.....	DIDC1016, DIDC1067
14	Front Hub Carrier	DIDC1012	69	Shock Pre-Load Spacer 4mm.....	DIDC1016, DIDC1067
15	Steering Knuckle	DIDC1013	70	Wheel/Tire/Foam Insert Assembled.....	DIDC1163
16	Rear Hub	DIDC1014	71	Rear Battery Post.....	DIDC1028, DIDC1063
17	2x36.5mm Pin (Inner Hinge).....	DIDC1035	72	Antenna Tube	DIDC1064
18	2x22mm Pin (Outer Hinge, Steering)	DIDC1036	73	Antenna Cap	DIDC1064
19	Front Bumper.....	DIDC1052			
20	Front Bumper Brace	DIDC1052			
21	Rear Bumper.....	DIDC1053			
22	Rear Bumper Brace	DIDC1053			
23	Mud Flap.....	DIDC1055			
24	Torque 370 Motor 35T.....	DIDC1193			
25	Motor Mount	DIDC1031			
26	Spur Gear Cover.....	DIDC1027			
27	45 Tooth Spur Gear	DIDC1005			
28	15 Tooth Differential/Pinion Gear	DIDC1003			
29	Center Drive Shaft	DIDC1007			
30	38T Differential Ring Gear	DIDC1003, DIDC1061			
31	Differential Case	DIDC1004, DIDC1061			
32	Diff Bevel Gear (Small).....	DIDC1002, DIDC1061			
33	Diff Bevel Gear (Large).....	DIDC1002, DIDC1061			
34	2x16.5mm Pin (Diff Gear Pin).....	DIDC1037, DIDC1061			
35	Dogbone Spring	DIDC1002, DIDC1062			
36	Dogbone.....	DIDC1009			
37	2x5mm O-Ring.....	DIDC1008, DIDC1062			
38	Axle.....	DIDC1008			
39	12T Pinion Gear (.6 Mod, 2mm Shaft).....	DIDC1032			
40	Ball Stud	DIDC1034			
41	Ball Cup (Long)	DIDC1042			
42	Camber Rod	DIDC1042			
43	Tie Rod	DIDC1042			
44	Steering Bell Crank (Right)	DIDC1010			
45	Steering Ball Crank (Left).....	DIDC1010			
46	Steering Drag Link.....	DIDC1010			
47	Ball Cup (Short).....	DIDC1042			
48	Steering Rod.....	DIDC1042			
49	Servo Saver Spline	DIDC1199, DIDM1005			
50	Servo Saver Base	DIDC1199, DIDM1005			
51	Servo Saver Spring.....	DIDC1199, DIDM1005			
52	Servo Saver Arm	DIDC1199, DIDM1005			
53	Upper Shock Mount	DIDC1029, DIDC1067			
55	Shock Body.....	DIDC1016			
56	Shock Cap.....	DIDC1016			

HARDWARE

A	6x10mm Ball Bearing	DIDC1070
B	8x12mm Ball Bearing	DIDC1071
C	2x4mm Round Head Screw	DIDC1057
E	2x8mm Round head Screw.....	DIDC1057
F	2x10mm Round Head Screw	DIDC1057
G	2x8mm Flat Head Screw	DIDC1057
H	2x10mm Flat Head Screw	DIDC1057
J	2x14mm Flat Head Screw	DIDC1057
K	2.5x8mm Flat Head Screw	DIDC1057
L	2.5x8mm Socket Head Cap Screw	DIDC1057
M	2.5x14mm Socket Head Cap Screw	DIDC1057
N	3x6mm Socket Head Cap Screw	DIDC1057
P	2x8mm Round Head Shoulder Screw	DIDC1057
Q	3x3mm Set Screw	DIDC1057
R	3mm Nylon-Insert Lock Nut.....	DIDC1001, DIDC1057
S	2.6x5mm Washer.....	DIDC1057
T	3x6mm Washer.....	DIDC1057
U	1.5mm E-Clip.....	DIDC1057
V	Body Clip (Small).....	DIDC1000, DIDC1057
X	2x6mm S/T Round Head Screw	DIDC1057

SHORT COURSE TRUCK™

