

BX4.18™

REPLACEMENT PARTS

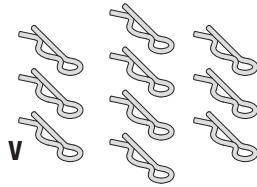

BODY CLIP



DIDC1000

3MM NYLON INSERT LOCK NUT

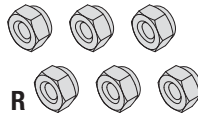

DIDC1001

DIFF BEVEL GEAR SET

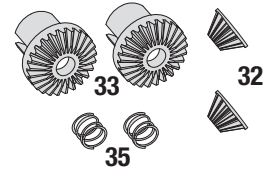

DIDC1002

DIFF RING & PINION GEAR SET

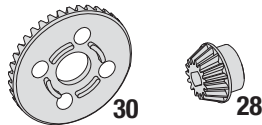

DIDC1003

DIFFERENTIAL CASE

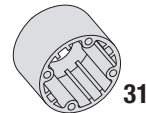

DIDC1004

45T SPUR GEAR

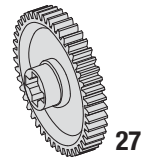

DIDC1005

GEARBOX SET

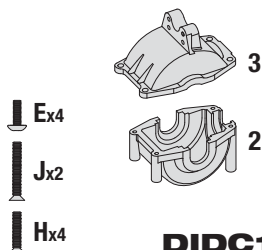

DIDC1006

CENTER DRIVE SHAFT



DIDC1007

AXLE SET

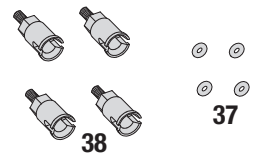

DIDC1008

DOGBONE SET

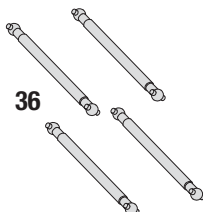

DIDC1009

STEERING BELLCRANK SET

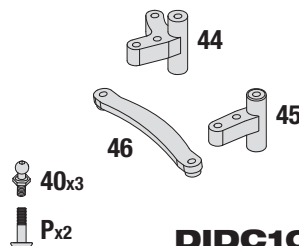

DIDC1010

SERVO SAVER SET

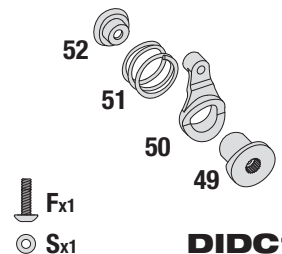

DIDC1011

FRONT HUB CARRIER SET

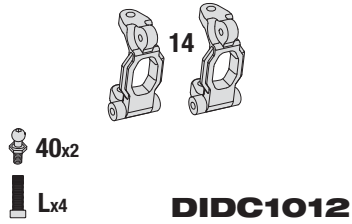

STEERING KNUCKLE SET

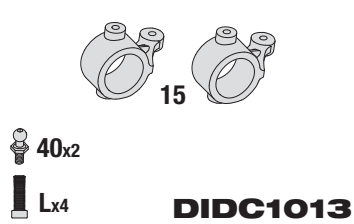

REAR HUB SET

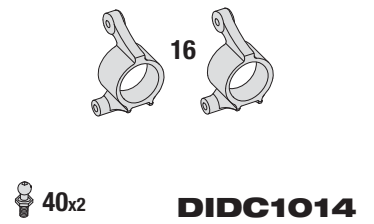

ASSEMBLED SHORT SHOCK SET

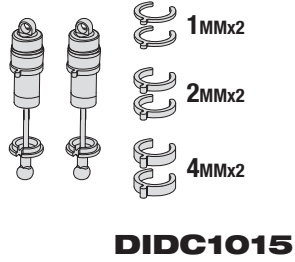

ASSEMBLED LONG SHOCK SET

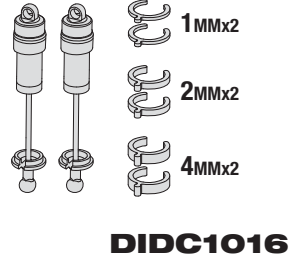

ASSEMBLED WHEEL & TIRE SET

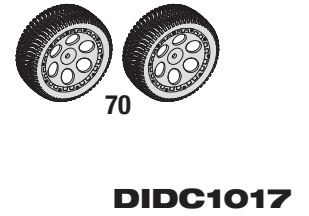

SUSPENSION ARM SET

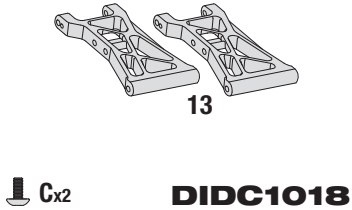

FRONT SHOCK TOWER

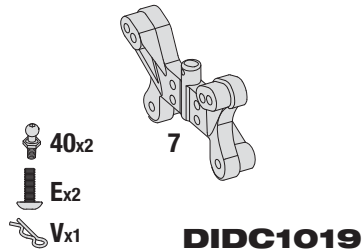

REAR SHOCK TOWER

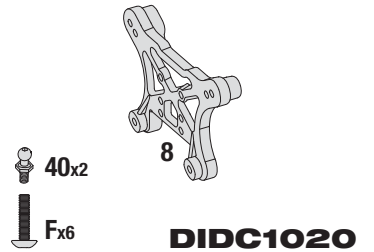

UPPER CHASSIS BRACE

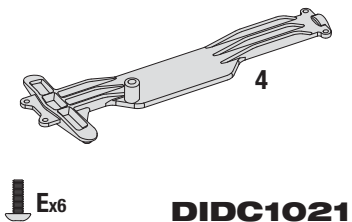

REAR WING

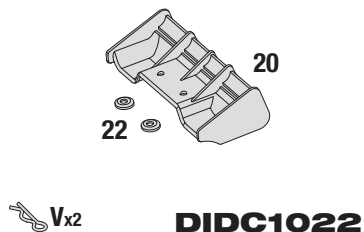

WING MOUNT



HINGE PIN HOLDER SET

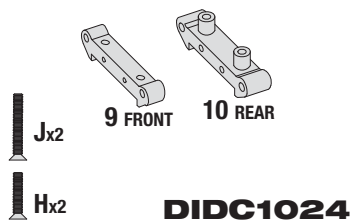

FRONT BUMPER

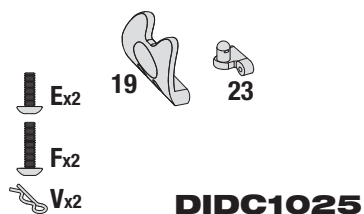

BATTERY HOLD-DOWN

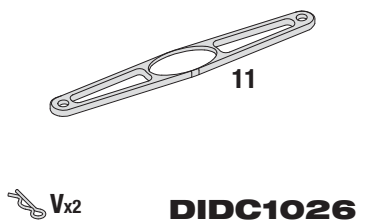

SPUR GEAR COVER

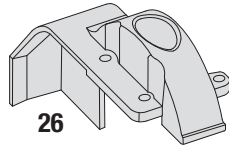

E_x4

DIDC1027

CHASSIS

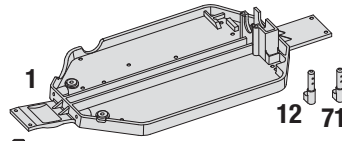

G_x2
V_x2

DIDC1028

UPPER SHOCK MOUNT SET

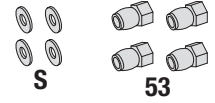

M_x4

DIDC1029

M370 MOTOR



T_x2
N_x2

DIDC1030

MOTOR MOUNT

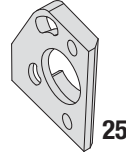

K_x2

DIDC1031

12T PINION GEAR

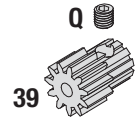

DIDC1032

6-CELL 1300MAH BATTERY

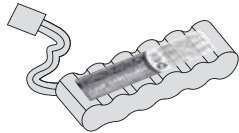

DIDC1033

BALL STUD SET



DIDC1034

2x36.5MM HINGE PIN SET

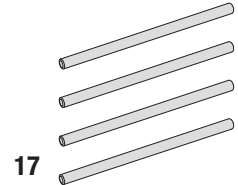

DIDC1035

2x22MM HINGE PIN SET

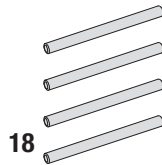

DIDC1036

2x16MM DIFF PIN SET



DIDC1037

**LONG SHOCK SPRINGS
(SOFT/RED)**

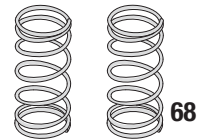

DIDC1039

DECAL SHEET



DIDC1041

LINKAGE SET

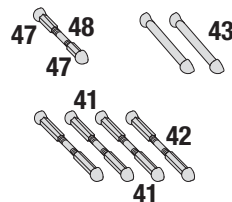

DIDC1042

**SHORT SHOCK SPRINGS
(MEDIUM/LIGHT BLUE)**

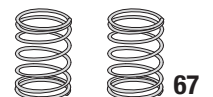

DIDC1043

BODY BX4.18



Vx2

DIDC1044

ASSEMBLED DIFFERENTIAL

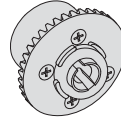

DIDC1061

DRIVE SHAFT SPACER SET

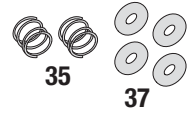

DIDC1062

BATTERY POST SET

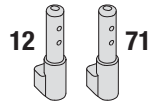

Gx2
 Vx2

DIDC1063

ANTENNA TUBE & CAP



DIDC1064

SHOCK SHAFT SET

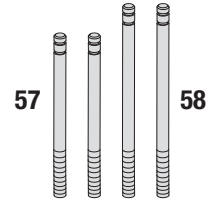

DIDC1065

6x10MM BALL BEARING

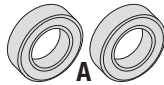

DIDC1070

8x12MM BALL BEARING

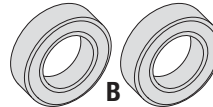

DIDC1071

D100 TRANSMITTER

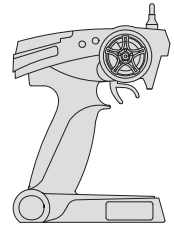

DIDJ1000

RE-18 RECEIVER/ESC UNIT

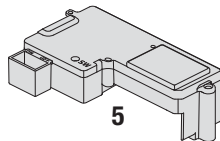

DIDM1000

D-S100 SERVO

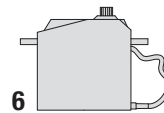

Xx2

DIDM1001

BATTERY CHARGER & MONITOR

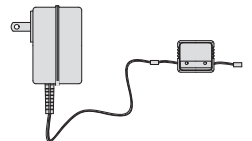

DIDP1000

CHARGE MONITOR

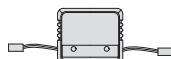

DIDP1001

HARDWARE SET

Cx10
2x4MM

Gx9
2x8MM

Kx2
2.5x8MM

Nx2
3x6MM

Sx5
2.6x5MM

Ex29
2x8MM

Hx6
2x10MM

Lx4
2.5x8MM

Px2
2x8MM

Tx2
3x6MM

Fx7
2x10MM

Jx2
2x14MM

Mx4
2.5x14MM

Qx1
3x3MM

Ux8
1.5x6MM

Rx4
3MM

Vx6
3x3MM

Xx2
2x6MM

DIDC1057

This parts list shows the key number, part description, and stock number for the replacement parts sets. When more than one stock number is listed, that part is available in multiple replacement parts sets.

#	Item Description	Available in Stock #	#	Item Description	Stock #
1	Chassis.....	DIDC1028	53	Upper Shock Mount	DIDC1029
2	Lower Gearbox Half	DIDC1006	54	Front Shock Body (Short).....	DIDC1015
3	Upper Gearbox Half	DIDC1006	55	Rear Shock Body (Long)	DIDC1016
4	Upper Chassis Brace	DIDC1021	56	Shock Cap	DIDC1015, DIDC1016
5	RE-18 Receiver/ESC Unit.....	DIDM1000	57	Front Shock Shaft (Short) ..	DIDC1065, DIDC1015
6	Servo.....	DIDM1001	58	Rear Shock Shaft (Long)	DIDC1065, DIDC1016
7	Front Shock Tower	DIDC1019	59	Shock Seal Retainer	DIDC1015, DIDC1016
8	Rear Shock Tower	DIDC1020	60	Shock Diaphragm.....	DIDC1015, DIDC1016
9	Front Hinge Pin Holder	DIDC1024	61	Shock Piston	DIDC1015, DIDC1016
10	Rear Hinge Pin Holder	DIDC1024	62	Shock O-Ring	DIDC1015, DIDC1016
11	Battery Hold Down	DIDC1026	63	Shock O-Ring Spacer	DIDC1015, DIDC1016
12	Front Battery Post	DIDC1028, DIDC1063	64	Upper Shock Spring Retainer	DIDC1015
13	Suspension Arm.....	DIDC1018			DIDC1016
14	Front Hub Carrier (C-Hub)	DIDC1012	65	Lower Shock Spring Retainer	DIDC1015
15	Steering Knuckle	DIDC1013			DIDC1016
16	Rear Hub	DIDC1014	66	Shock End	DIDC1015, DIDC1016
17	2x36.5mm Pin (Inner Hinge Pin).....	DIDC1035	67	Shock Spring Short (Med/Lt Blue)	DIDC1043
18	2x22mm Pin (Outer Hinge Pin, Steering Pivot)	DIDC1036	68	Shock Spring Long (Soft/Red)	DIDC1039
			69	Shock Pre-Load Spacers	DIDC1015, DIDC1016
19	Bumper	DIDC1025	70	Wheel/Tire/Foam Assembled	DIDC1017
20	Rear Wing	DIDC1022	71	Rear Battery Post	DIDC1028, DIDC1063
21	Wing Mount	DIDC1023	72	Antenna Tube.....	DIDC1064
22	Wing Washer.....	DIDC1022	73	Antenna Cap	DIDC1064
23	Rear Body Mount	DIDC1025			
24	M370 Motor	DIDC1030			
25	Motor Mount	DIDC1031			
26	Spur Gear Cover.....	DIDC1027			
27	45 Tooth Spur Gear	DIDC1005			
28	15 Tooth Differential Pinion Gear.....	DIDC1003			
29	Center Drive Shaft	DIDC1007			
30	38 Tooth Differential Ring Gear	DIDC1003			
		DIDC1061			
31	Differential Case	DIDC1004, DIDC1061			
32	Diff Bevel Gear (Small)	DIDC1002, DIDC1061			
33	Diff Output/Bevel Gear (Large)	DIDC1002			
		DIDC1061			
34	2x16.5mm Pin (Diff Gear Pin)	DIDC1037			
		DIDC1061			
35	Dogbone Spring	DIDC1002, DIDC1062			
36	Dogbone.....	DIDC1009			
37	2 x 5mm O-Ring.....	DIDC1008, DIDC1062			
38	Axle	DIDC1008			
39	12T Pinion Gear.....	DIDC1032			
40	Ball Stud.....	DIDC1034			
41	Ball Cup (Long)	DIDC1042			
42	Camber Rod	DIDC1042			
43	Tie Rod	DIDC1042			
44	Steering Bell Crank (Right).....	DIDC1010			
45	Steering Ball Cranks (Left).....	DIDC1010			
46	Steering Drag Link.....	DIDC1010			
47	Ball End (Short).....	DIDC1042			
48	Steering Rod	DIDC1042			
49	Servo Saver Spline	DIDC1011			
50	Servo Saver Arm	DIDC1011			
51	Servo Saver Spring	DIDC1011			
52	Servo Saver Cap.....	DIDC1011			

HARDWARE

A	6x10mm Ball Bearing	DIDC1070
B	8x12mm Ball Bearing	DIDC1071
C	2x4mm Round Head Screw.....	DIDC1057
E	2x8mm Round head Screw	DIDC1057
F	2x10mm Round Head Screw.....	DIDC1057
G	2x8mm Flat Head Screw.....	DIDC1057
H	2x10mm Flat Head Screw.....	DIDC1057
J	2x14mm Flat Head Screw.....	DIDC1057
K	2.5x8mm Flat Head Screw.....	DIDC1057
L	2.5x8mm Socket Head Cap Screw.....	DIDC1057
M	2.5x14mm Socket Head Cap Screw.....	DIDC1057
N	3x6mm Socket Head Cap Screw.....	DIDC1057
P	2x8mm Round Head Shoulder Screw....	DIDC1057
Q	3x3mm Set Screw	DIDC1057
R	3mm Nylon-Insert Lock Nut	DIDC1001,
		DIDC1057
S	2.6x5mm Washer	DIDC1057
T	3x6mm Washer	DIDC1057
U	1.5mm E-Clip	DIDC1057
V	Body Clip (Small)	DIDC1000, DIDC1057
X	2x6mm S/T Round Head Screw	DIDC1057

BX4.18™

