

SC4.18™

REPLACEMENT PARTS

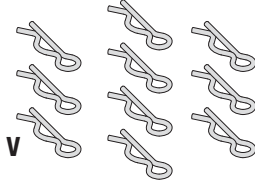

BODY CLIP



DIDC1000

3MM NYLON INSERT LOCK NUT

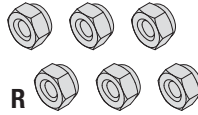

DIDC1001

DIFF BEVEL GEAR SET

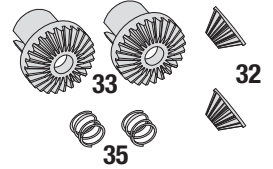

DIDC1002

DIFF RING & PINION GEAR SET

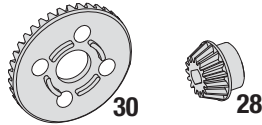

DIDC1003

DIFFERENTIAL CASE

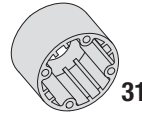

DIDC1004

45T SPUR GEAR

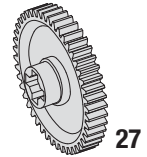

DIDC1005

GEARBOX SET

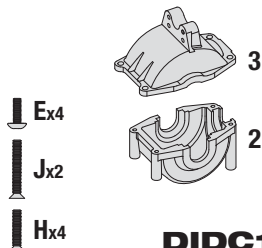

DIDC1006

CENTER DRIVE SHAFT

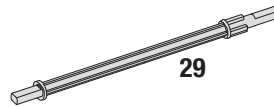

DIDC1007

AXLE SET

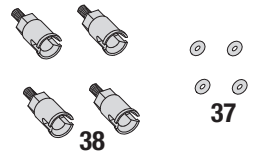

DIDC1008

DOGBONE SET

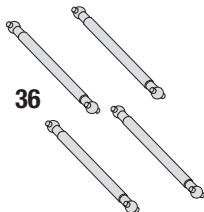

DIDC1009

STEERING BELLCRANK SET

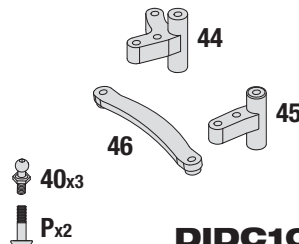

DIDC1010

SERVO SAVER SET

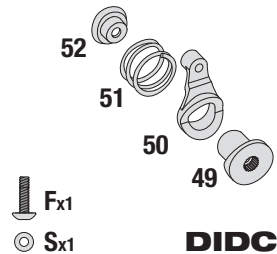

DIDC1011

FRONT HUB CARRIER SET

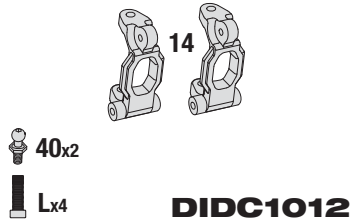

STEERING KNUCKLE SET

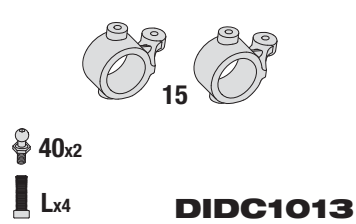

REAR HUB SET

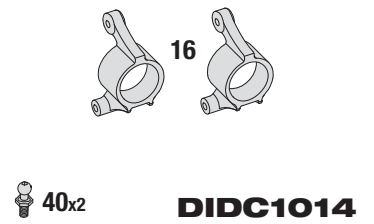

ASSEMBLED LONG SHOCK SET

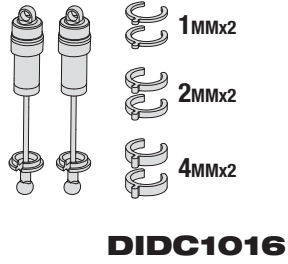

SUSPENSION ARM SET

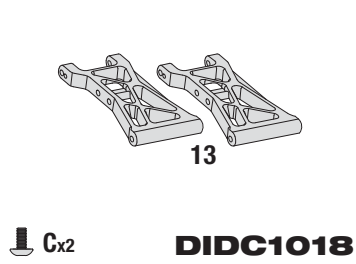

UPPER CHASSIS BRACE

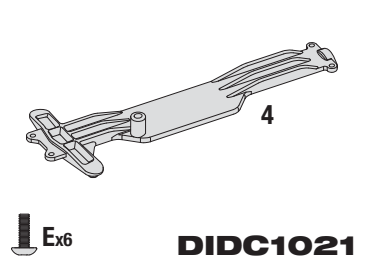

HINGE PIN HOLDER SET

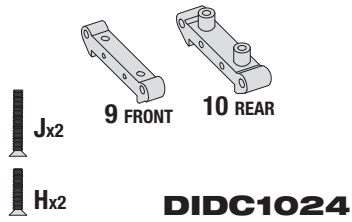

BATTERY HOLD-DOWN

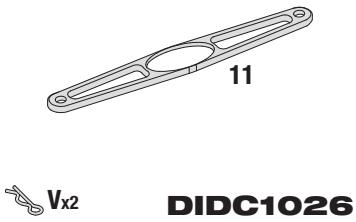

SPUR GEAR COVER

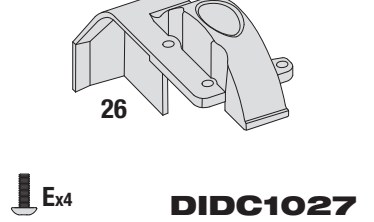

CHASSIS

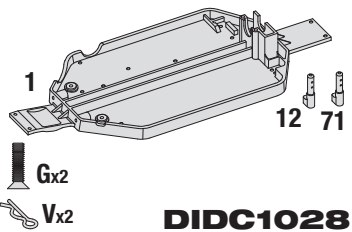

UPPER SHOCK MOUNT SET

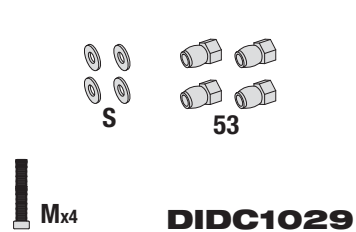

M370 MOTOR



MOTOR MOUNT

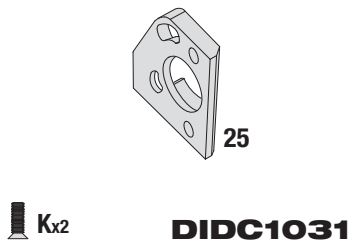

12T PINION GEAR

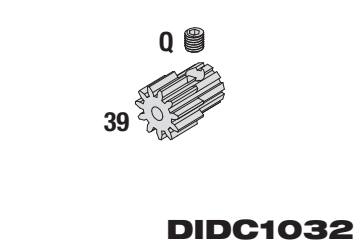

6-CELL 1300MAH BATTERY

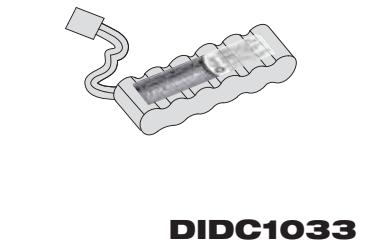

BALL STUD SET

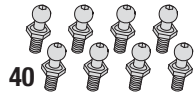

DIDC1034

2x36.5MM HINGE PIN SET

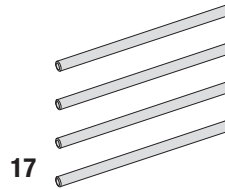

DIDC1035

2x22MM HINGE PIN SET

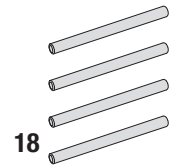

DIDC1036

2x16MM DIFF PIN SET



DIDC1037

**LONG SHOCK SPRINGS
(HEAVY/ORANGE)**

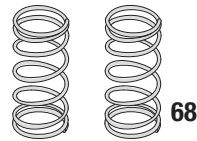

DIDC1040

LINKAGE SET

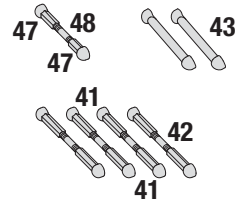

DIDC1042

FRONT BUMPER SET

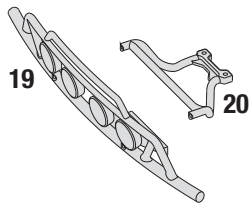

Ex6

DIDC1052

REAR BUMPER SET

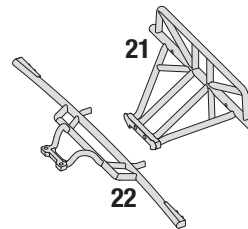

Ex6

DIDC1053

SHOCK TOWER

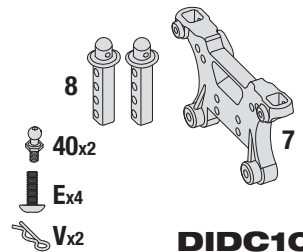

DIDC1054

MUD FLAP SET

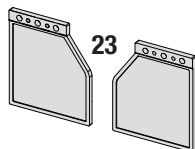

Cx6

DIDC1055

ASSEMBLED WHEEL & TIRE SET

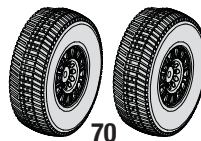

DIDC1056

DECAL SET



DIDC1058

BODY SC4.18



Vx4

DIDC1060

ASSEMBLED DIFFERENTIAL

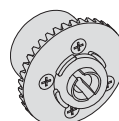

DIDC1061

DRIVE SHAFT SPACER SET

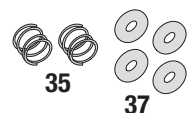

DIDC1062

BATTERY POST SET

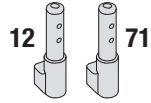

DIDC1063

ANTENNA TUBE & CAP



DIDC1064

SHOCK SHAFT SET

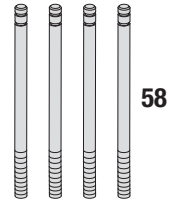

DIDC1066

6x10MM BALL BEARING

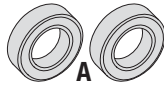

DIDC1070

8x12MM BALL BEARING

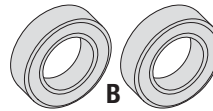

DIDC1071

D100 TRANSMITTER

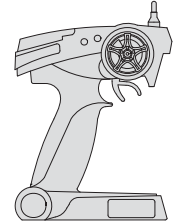

DIDJ1000

RE-18 RECEIVER/ESC UNIT

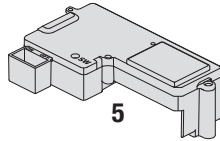

DIDM1000

D-S100 SERVO

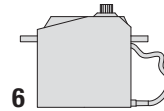

DIDM1001

BATTERY CHARGER & MONITOR

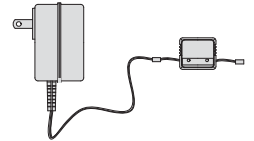

DIDP1000

CHARGE MONITOR



DIDP1001

HARDWARE SET

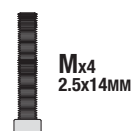

DIDC1057

This parts list shows the key number, part description, and stock number for the replacement parts sets. When more than one stock number is listed, that part is available in multiple replacement parts sets.

#	Item Description	Available in Stock #	#	Item Description	Available in Stock #
1	Chassis.....	DIDC1028	58	Shock Shaft.....	DIDC1066, DIDC1016
2	Lower Gearbox Half.....	DIDC1006	59	Shock Seal Retainer.....	DIDC1016
3	Upper Gearbox Half.....	DIDC1006	60	Shock Diaphragm.....	DIDC1016
4	Upper Chassis Brace.....	DIDC1021	61	Shock Piston.....	DIDC1016
5	RE-18 Receiver/ESC Unit.....	DIDM1000	62	Shock O-Ring.....	DIDC1016
6	Servo.....	DIDM1001	63	Shock O-Ring Spacer.....	DIDC1016
7	Shock Tower.....	DIDC1054	64	Upper Shock Spring Retainer.....	DIDC1016
8	Body Mount.....	DIDC1054	65	Lower Shock Spring Retainer.....	DIDC1016
9	Front Hinge Pin Holder.....	DIDC1024	66	Shock End.....	DIDC1016
10	Rear Hinge Pin Holder.....	DIDC1024	68	Long Shock Spring (Heavy/Orange).....	DIDC1040
11	Battery Hold Down.....	DIDC1026	69	Shock Pre-Load Spacer 1mm.....	DIDC1016
12	Front Battery Post.....	DIDC1028, DIDC1063	69	Shock Pre-Load Spacer 2mm.....	DIDC1016
13	Suspension Arm.....	DIDC1018	69	Shock Pre-Load Spacer 4mm.....	DIDC1016
14	Front Hub Carrier.....	DIDC1012	70	Wheel/Tire/Foam Insert Assembled.....	DIDC1056
15	Steering Knuckle.....	DIDC1013	71	Rear Battery Post.....	DIDC1028, DIDC1063
16	Rear Hub.....	DIDC1014	72	Antenna Tube.....	DIDC1064
17	2x36.5mm Pin (Inner Hinge).....	DIDC1035	73	Antenna Cap.....	DIDC1064
18	2x22mm Pin (Outer Hinge, Steering).....	DIDC1036			
19	Front Bumper.....	DIDC1052			
20	Front Bumper Brace.....	DIDC1052			
21	Rear Bumper.....	DIDC1053			
22	Rear Bumper Brace.....	DIDC1053			
23	Mud Flap.....	DIDC1055			
24	M370 Motor.....	DIDC1030			
25	Motor Mount.....	DIDC1031			
26	Spur Gear Cover.....	DIDC1027			
27	45 Tooth Spur Gear.....	DIDC1005			
28	15 Tooth Differential Pinion Gear.....	DIDC1003			
29	Center Drive Shaft.....	DIDC1007			
30	38T Differential Ring Gear.....	DIDC1003, DIDC1061			
31	Differential Case.....	DIDC1004, DIDC1061			
32	Diff Bevel Gear (Small).....	DIDC1002, DIDC1061			
33	Diff Bevel Gear (Large).....	DIDC1002, DIDC1061			
34	2x16.5mm Pin (Diff Gear Pin).....	DIDC1037 DIDC1061			
35	Dogbone Spring.....	DIDC1002, DIDC1062			
36	Dogbone.....	DIDC1009			
37	2x5mm O-Ring.....	DIDC1008, DIDC1062			
38	Axle.....	DIDC1008			
39	12T Pinion Gear (.6 Mod, 2mm Shaft).....	DIDC1032			
40	Ball Stud.....	DIDC1034			
41	Ball Cup (Long).....	DIDC1042			
42	Camber Rod.....	DIDC1042			
43	Tie Rod.....	DIDC1042			
44	Steering Bell Crank (Right).....	DIDC1010			
45	Steering Ball Crank (Left).....	DIDC1010			
46	Steering Drag Link.....	DIDC1010			
47	Ball Cup (Short).....	DIDC1042			
48	Steering Rod.....	DIDC1042			
49	Servo Saver Spline.....	DIDC1011			
50	Servo Saver Arm.....	DIDC1011			
51	Servo Saver Spring.....	DIDC1011			
52	Servo Saver Cap.....	DIDC1011			
53	Upper Shock Mount.....	DIDC1029			
55	Shock Body.....	DIDC1016			
56	Shock Cap.....	DIDC1016			

HARDWARE

A	6x10mm Ball Bearing.....	DIDC1070
B	8x12mm Ball Bearing.....	DIDC1071
C	2x4mm Round Head Screw.....	DIDC1057
E	2x8mm Round head Screw.....	DIDC1057
F	2x10mm Round Head Screw.....	DIDC1057
G	2x8mm Flat Head Screw.....	DIDC1057
H	2x10mm Flat Head Screw.....	DIDC1057
J	2x14mm Flat Head Screw.....	DIDC1057
K	2.5x8mm Flat Head Screw.....	DIDC1057
L	2.5x8mm Socket Head Cap Screw.....	DIDC1057
M	2.5x14mm Socket Head Cap Screw.....	DIDC1057
N	3x6mm Socket Head Cap Screw.....	DIDC1057
P	2x8mm Round Head Shoulder Screw.....	DIDC1057
Q	3x3mm Set Screw.....	DIDC1057
R	3mm Nylon-Insert Lock Nut.....	DIDC1001, DIDC1057
S	2.6x5mm Washer.....	DIDC1057
T	3x6mm Washer.....	DIDC1057
U	1.5mm E-Clip.....	DIDC1057
V	Body Clip (Small).....	DIDC1000, DIDC1057
X	2x6mm S/T Round Head Screw.....	DIDC1057

SC4.18™

