

ElectriFly™

by Great Planes®



SPARKING INNOVATIONS IN ELECTRIC FLIGHT™

EPERFORMANCE SERIESTM

Compact park flyers with HUGE performance... on clean, brushless power!

Extreme aerobatics don't have to require a big, glow-powered model — not when you've got an E-Performance Series ARF! These handsome high-flyers feature quality built-up wood airframes accentuated with fiberglass parts that are painted to match the pre-applied trim schemes. And in the air, you'll quickly see why "Performance" is their middle name!



- Fit and finish so refined, no one will believe they're flight-ready in just a few hours.
- Capable of a wide envelope of thrilling aerial maneuvers.
- The included hardware is specially designed for E-Performance Series models.



REACTORTM 3D ARF

**Sleek and streamlined, with
"big plane" performance**

GPMA1540
Wingspan: 41.5 in (1055 mm)
Wing Area: 384 in² (24.8 dm²)
Weight: 24-27 oz (680-765 g)
Wing Loading: 9-10 oz/ft² (27-31 g/dm²)
Length: 42 in (1065 mm)

Requires: 4-channel radio w/4 micro servos, 35-90-950 outrunner BL motor, 25A BL ESC (min) & 11.1V 910-2100mAh LiPo battery

YAK 54 3D ARF

**Realistic looks and flight —
even in 10-15 mph winds**

GPMA1532
Wingspan: 41 in (1041 mm)
Wing Area: 356 in² (23 dm²)
Weight: 24-27 oz (680-765 g)
Wing Loading: 9.7-10.9 oz/ft² (30-33 g/dm²)
Length: 38 in (960 mm)
Requires: 4-channel radio w/4 micro servos, 35-90-950 outrunner BL motor, 25A BL ESC (min) & 11.1V 1250-2100mAh LiPo battery



**Fly this plane on
REALFLIGHT[®]
G5**

Ultimate! BIPLANE 3D ARF

**Looks and flies like a larger plane,
in areas where glow can't go!**

GPMA1546

Wingspan: 33.5 in (850 mm)

Wing Area: 383 in² (24.7 dm²)

Weight: 27.5-31 oz (780-880 g)

Wing Loading: 10.3-11.6 oz/ft² (32-36 g/dm²)

Length: 37 in (935 mm)

Requires: 4+ channel radio w/4
micro servos, 35-30-950 outrunner
BL motor, 25A BL ESC (min) &
11.1V 1250-2100mAh LiPo battery



SU-31 3D ARF

**A smaller-size Sukhoi that's
big on performance**

GPMA1547

Wingspan: 41 in (1040 mm)

Wing Area: 343 in² (22.1 dm²)

Weight: 27.5-31 oz (780-880 g)

Wing Loading: 11.5-13 oz/ft² (35-40 g/dm²)

Length: 38 in (965 mm)

Requires: 4-5 channel radio w/4
micro servos, 35-30-1250 outrunner
BL motor, 35A BL ESC (min) &
11.1V 1500mAh LiPo battery

EDGE 540

**The air show ace — now a
small-field superstar!**

GPMA1550

Wingspan: 41 in (1040 mm)

Wing Area: 353 in² (22.9 dm²)

Weight: 29-32 oz (820-910 g)

Wing Loading: 11.8-13.1 oz/ft² (36-40 g/dm²)

Length: 39.5 in (1005 mm)

Requires: 4+ channel radio w/4
micro servos, 35-30-1250 outrunner
BL motor, 35A BL ESC (min) &
11.1V 1500mAh LiPo battery



**Fly this plane on
REALFLIGHT**
Expansion Pack 5

REACTOR™ 3D ARF BIPE

**Equally adept at nailing 3D
and precision aerobatics**

GPMA1580

Wingspan: 35 in (890 mm)

Wing Area: 600 in² (38.7 dm²)

Weight: 34.2-38.2 oz (970-1085 g)

Wing Loading: 8.2-9.1 oz/ft² (25-28 g/dm²)

Length: 43 in (1080 mm)

Requires: 4-5 channel radio
w/4 micro servos, 35-36-1200
outrunner BL motor, 35A BL
ESC (min) & 11.1V 1200mAh
LiPo battery

The legends of WWI return!

Their impact on the course of world history is undeniable — and so is the ease of assembling these ARF replicas. The all-wood airframes are prebuilt, the looks are spot-on accurate — and the performance is a spirited match for the up and coming ace!

- Crafted for authenticity and assembly ease!
- Trim schemes and insignia modeled after real-world aircraft.
- Painted, easy-to-install aluminum cabanes and wooden struts.
- Numerous scale details, including molded pilot busts, cowls and machine guns, shaped scale landing gear and lightweight scale wheels.



- Generous hardware packages designed for outstanding park-flyer performance.
- Just right for brushless power, nearby parks and easy backseat transportation!
- Magnetic hatches offer fast, easy access to battery packs.



S.E.5a **ARF**

Britain's first-line fighter on the Western Front!

GPMA1140
Wingspan: 34 in (865 mm)
Wing Area: 420 in² (27.1 dm²)
Weight: 1.3-1.5 lb (595-680 g)
Wing Loading: 7.5-8.2 oz/ft² (22-25 g/dm²)
Length: 25.5 in (650 mm)

Requires: 4-channel radio w/4 micro servos, 28-30-950 outrunner BL motor, 25A BL ESC (min) & 11.1V 1250mAh LiPo battery

FOKKER D.VII **ARF**

Designed to end Allied air superiority!

GPMA1141
Wingspan: 36 in (915 mm)
Wing Area: 360 in² (23.2 dm²)
Weight: 1.6 lb (730 g)
Wing Loading: 10 oz/ft² (30 g/dm²)
Length: 27 in (685 mm)

Requires: 4-channel radio w/4 micro servos, 28-30-950 outrunner BL motor, 25A BL ESC (min) & 11.1V 1250mAh LiPo battery



FOKKER DR-1

ARF

Favorite of the Red Baron and the Flying Circus!

GPMA1142

Wingspan: 29.5 in (745 mm)

Wing Area: 315 in² (20 dm²)

Weight: 1.5 lb (680 g)

Wing Loading: 10 oz/ft² (30 g/dm²)

Length: 23.5 in (600 mm)

Requires: 4-channel radio w/4 micro servos, 28-30-950 outrunner BL motor, 25A BL ESC (min) & 11.1V 1250mAh LiPo battery



SPAD XIII

ARF

America's Ace Maker of 1918!

GPMA1143

Wingspan: 34 in (865 mm)

Wing Area: 390 in² (25.2 dm²)

Weight: 22.4-25.2 oz (635-715 g)

Wing Loading: 8.3-9.3 oz/ft² (25-28 g/dm²)

Length: 27 in (685 mm)

Requires: 4-channel radio w/4 micro servos, 28-30-950 outrunner BL motor, 25A BL ESC (min) & 11.1V, 1250mAh LiPo 1250mAh battery

SOPWITH CAMEL

ARF

The deadliest Allied fighter of WWI!

GPMA1144

Wingspan: 35.5 in (900 mm)

Wing Area: 389 in² (25.1 dm²)

Weight: 21.1-26.3 oz (595-745 g)

Wing Loading: 7.8-9.7 oz/ft² (24-30 g/dm²)

Length: 25 in (630 mm)

Requires: 4-channel radio w/4 micro servos, 28-30-950 outrunner BL motor, 25A BL ESC (min) & 11.1V 1500mAh LiPo battery



NIEUPOORT XI

ARF

The Allies' answer to Germany's aerial onslaught!

■ Features prehinged ailerons and elevators, a prebuilt motor box, installed coaming, a factory-painted windshield — and scarf material for the pilot!

GPMA1146

Wingspan: 36.5 in (900 mm)

Wing Area: 314 in² (20.3 dm²)

Weight: 21.9-23.1 oz (620-650 g)

Wing Loading: 10.0-10.6 oz/ft² (31-32 g/dm²)

Length: 28 in (710 mm)

Requires: 4-channel radio w/4 micro servos, 28-30-950 outrunner BL motor, 25A BL ESC (min) & 11.1V, 1600mAh LiPo battery.

Rx-RTM Models



EXPERTLY COVERED WITH
MONOKOTE[®]

GPMA7500 ElectroStik Rx-R
GPMA1574 ElectroStik ARF
Wingspan: 52.5 in (1333.5 mm)
Wing Area: 589 in² (38 dm²)
Wing Loading: 11.7-13.6 oz/ft² (36-42 g/dm²)
Weight: 3-3.5 lb (1360-1587 g)
Length: 45.5 in (1155 mm)

Rx-R requires: 4-channel radio w/receiver & 11.1V 3200mAh LiPo battery.
ARF also requires: 3 micro servos, 42-40-1000kV outrunner brushless motor & 45A brushless ESC (min.).

ELECTROSTIKTM

The tried-and-true Stik – as an easy electric!

- Assembles in 1-2 hours – no gluing required!
- Constructed of high-quality balsa/plywood, with a factory-covered MonoKote trim scheme.
- Pre-hinged flight surfaces with mounted control horns ensure perfect alignment.

INCLUDES:

- 1000kV outrunner brushless motor
- 45A brushless ESC
- 3 micro servos



Fast, futuristic and fun!

- Sized just right for grab-it-and-go flying, anytime...anywhere!
- Capable of exciting, high-speed aerobatics and slow, steady sport flying.
- The AeroCell foam body is as strong and rigid as balsa, yet lighter and more durable than EPS foam.
- Assembles in 5 minutes – provides hours of futuristic flying!

INCLUDES:

- HyperFlowTM ducted fan unit
- 3500kV inrunner brushless motor
- 25A brushless ESC
- 2 micro servos



GPMA6000 Synapse EDF Jet Rx-R
GPMA1870 Synapse EDF Jet ARF
Wingspan: 26.5 in (665 mm)
Wing Area: 168 in² (10.8 dm²)
Weight: 12.5-13.5 oz (350-380 g)
Wing Loading: 10.7-11.6 oz/ft² (33-35 g/dm²)
Length: 24 in (590 mm)

Both require: 3+ channel radio w/elevon mixing & 11.1V 910mAh LiPo battery.
ARF also requires: two micro servos, 20-40-3500kV inrunner brushless motor & 25A brushless ESC (min.).

RX-R™ Models

All Rx-R models on this spread are also available as ARFs!

Seawind[®] EP

Exotic seaplane looks – exceptional electric ease!

- Try exciting water takeoffs and landings – or remove the water rudder for hand-launches and grass landings!
- Assembles in 2-3 hours, thanks to a tough, lightweight AeroCell™ foam airframe and high-quality hardware.
- A clear, vacu-formed canopy with a painted frame, two profile pilot figures and instrument panel details add extra realism.
- Includes cradle for easy assembly and maintenance.

INCLUDES:

- 950kV outrunner brushless motor
- 25A brushless ESC
- 3 micro servos



Fly this plane on
REALFLIGHT
Expansion Pack 6

GPMA5750 Seawind Rx-R
GPMA1169 Seawind ARF
Wingspan: 39.5 in (1005 mm)
Wing Area: 234 in² (15.1 dm²)
Weight: 24-26 oz (680-735 g)
Wing Loading: 14.8-16.0 oz/ft² (45-49 g/dm²)
Length: 33.5 in (845 mm)

Both require: 4+ channel radio & 11.1V 910-1500mAh LiPo battery.
ARF also requires: 3 micro servos, a 28-30-950 outrunner brushless motor & 25A brushless ESC (min.).

Seawind is a licensed trademark of Seawind/S.N.A., Inc.
Seawind logo is used with permission of Seawind/S.N.A., Inc.



GPMA6002 L-39 Albatros EDF Jet Rx-R
GPMA1869 L-39 Albatros EDF Jet ARF
Wingspan: 25 in (635 mm)
Wing Area: 141 in² (9.1 dm²)
Weight: 17.5-18.5 oz (500-520 g)
Wing Loading: 17.9-18.9 oz/ft² (55-58 g/dm²)
Length: 31 in (780 mm)

Both require: 3-channel radio & 11.1V 910mAh LiPo battery.
ARF also requires: 3 micro servos & 25A brushless ESC (min.).



Ducted-fan speed – fighter jet style!

- Constructed of quick-building, virtually crash-resistant AeroCell foam!
- Arrives factory-finished, with a military-inspired camouflage trim scheme.
- Compact and easy to transport.
- Also includes a display-ready canopy and a detachable armament.

INCLUDES:

- HyperFlow™ ducted fan unit
- 3500kV inrunner brushless motor
- 25A brushless ESC
- 3 micro servos

PERFORMANCE XLC™

EXTREME LIGHT CONCEPT

EXPERTLY COVERED WITH
E-Top Plus
MONOKOTE

Designed for on-the-edge 3D!

XLC ARFs are engineered and manufactured for no-compromise 3D, using the best materials for the job. Carbon fiber, hand-selected woods and lightweight painted fiberglass parts hold weight to a minimum, to make the most of brushless motors and LiPo power.

- Factory-hinged ailerons and rudder and magnetically attached cowls and hatches shorten box-to-flight times.
- Double-beveled, airfoiled tail surfaces ensure smooth-as-silk tracking and maximum maneuvering muscle.



- Precisely interlocking, laser-cut balsa airframe
- Fiberglass cowl, landing gear and wheel pants
- Reinforced carbon fiber components
- High-quality hardware

EDGE 540T ARF

- Tracks with incredible precision — with all the agility needed for awe-inspiring aerobatics.

GPMA1572

Wingspan: 49.5 in (1260 mm)
Wing Area: 490 in² (31.6 dm²)
Weight: 3.25-3.5 lb (1470-1590 g)
Wing Loading: 15-16 oz/ft² (46-49 g/dm²)
Length: 48 in (1220 mm)

Requires: 4-5 channel radio w/4 micro servos, receiver, 42-50-800 outrunner BL motor, 45A BL ESC & 14.8V 2100mAh LiPo battery



Fly this plane on
REALFLIGHT
65



Fly this plane on
REALFLIGHT
Expansion Pack 6

Matt Chapman EAGLE 580 ARF

- Die-cut decals recreate the licensed Embry-Riddle trim scheme flown by full-scale airshow legend Matt Chapman!

GPMA1573

Wingspan: 50 in (1270 mm)
Wing Area: 494 in² (31.9 dm²)
Weight: 3.25-3.5 lb (1475-1590 g)
Wing Loading: 15-16 oz/ft² (46-49 g/dm²)
Length: 47.75 in (1215 mm)

Requires: 4-channel radio w/4 micro servos, receiver, 42-50-800 outrunner BL motor, 45A BL ESC & 11.1V 2100mAh LiPo battery

Sequence ARF

- ElectriFly's first-ever pattern plane — the equal of much larger pattern ships in looks and performance.

GPMA1575

Wingspan: 50 in (1270 mm)
Wing Area: 505 in² (32.6 dm²)
Weight: 3.5-3.75 lb (1590-1700 g)
Wing Loading: 16-17 oz/ft² (49-52 g/dm²)
Length: 51.5 in (1310 mm)

Requires: 4-channel radio w/4 servos, receiver, 42-50-800 outrunner BL motor, 45A BL ESC (min) & 14.8V 2100mAh LiPo battery



Fly this plane on
REALFLIGHT
Expansion Pack 6

PRO-FORMANCE™ FOAM

Fast-building foam fliers for indoor and outdoor fun.

All of these models are made from 3 mm Pro-Formance foam and can be flight-ready in 3 hours or less. Parts are factory-finished, laser-cut and interlocking, for easy good looks and strong, arrow-straight airframes. Because of their lightness, Pro-Formance foams deliver premium performance with the smallest RimFire™ brushless motors.

PLUMA™ ARF

■ Versatile indoor/outdoor performer delivers air show aerobatics, superb 3D and everything in-between!

GPMA1130

Wingspan: 32.5 in (830 mm)

Wing Area: 518 in² (33.4 dm²)

Weight: 8.4–9.5 oz (240–270 g)

Wing Loading: 2.3 – 2.6 oz/ft² (7.2–8.1 g/dm²)

Length: 38 in (955 mm)

Requires: 4-channel radio w/3

micro servos, 28-26-1000

outrunner BL motor, 8A BL ESC

(min) & 11.1V 300mAh LiPo battery



Fly this plane on
REALFLIGHT
Expansion Pack 5



Yak 54™ ARF

■ Indoor flyer offers next-to-nothing weight for totally "out there" aerobatics!

GPMA1131

Wingspan: 32 in (820 mm)

Wing Area: 270 in² (17.4 dm²)

Weight Range: 5.5–6.7 oz (155–190 g)

Wing Loading: 2.9–3.5 oz/ft² (9–11 g/dm²)

Length: 36.5 in (920 mm)

Requires: 4-channel radio w/3

micro servos, 28-23-1750 or 28-

22-1380 outrunner BL motor, 8A BL

ESC & 7.4V 300mAh LiPo battery



Silhouette™ ARF

■ Airfoiled wing allows this indoor/outdoor foamy to fly like larger aerobats.

GPMA1132

Wingspan: 40 in (1015 mm)

Wing Area: 406 in² (26.2 dm²)

Weight: 14.5 – 16 oz (410 – 450 g)

Wing Loading: 5.2 – 5.7 oz/ft² (15.9 – 17.4 g/dm²)

Length: 41 in (1040 mm)

Requires: 4-channel radio (min.) w/4

micro servos, 28-30-950 outrunner

BL motor, 12A BL ESC & 11.1V

640mAh LiPo battery

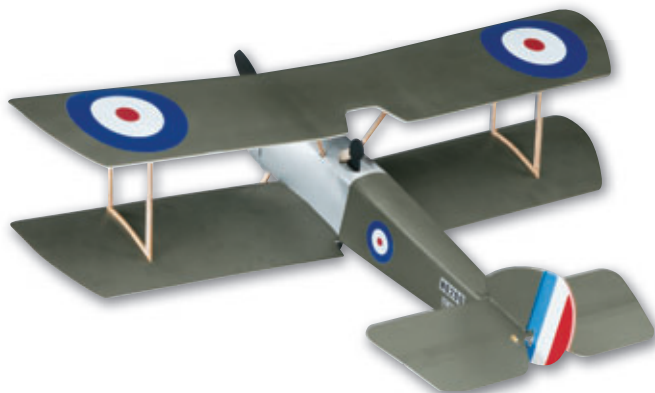

SOPWITH PUP™ ARF

■ Combines the scale-like WWI fighter looks with smooth, stable handling — just right for a first foamy or a favorite sport flier.

GPMA1133

Wingspan: 30 in (760 mm)

Wing Area: 332 in² (21.4 dm²)

Weight Range: 7.5–8.0 oz (215–225 g)

Wing Loading: 3.3–3.4 oz/ft² (10–11 g/dm²)

Length: 22 in (545 mm)

Requires: 3-channel radio w/2 servos

(pico size highly recommended), 28-

13-1750 outrunner BL motor, 8A BL

ESC & 7.4V 300mAh LiPo battery

Defend any small air space with these famous fighters!

- Both come 90% preassembled, with top-notch components such as a 280-sized motor, 3.8:1 gear drive and prop all included.
- Made of smooth, lightweight foam with lots of molded-in details.

- Major sections are prepainted, with decals included for recreating authentic WWII markings.



F6F HELLCAT

ARF

GPMA1159
Wingspan: 31.9 in (810 mm)
Wing Area: 193 in² (12.4 dm²)
Weight: 13.5-16 oz (380-454 g)
Wing Loading: 9.7 oz/ft² (30 g/dm²)
Length: 25 in (630 mm)
Requires: 3-channel radio w/2 micro
servos, 10A brushed ESC & 9.6V 650mAh
NiMH battery

Fly this plane on
REALFLIGHT
Expansion Pack 2



F4U Corsair

ARF

GPMA1157
Wingspan: 32.5 in (825 mm)
Wing Area: 224 in² (14.5 dm²)
Weight: 14-16 oz (397-454 g)
Wing Loading: 9-10 oz/ft² (29-32 g/dm²)
Length: 27 in (685 mm)
Requires: 3-channel radio w/2 micro
servos, 10A brushed ESC & 9.6V 650mAh
NiMH battery

Lancair ES^{EP} ARF

- Sleek looks with same-day assembly!
- Replicates the original sport classic with a painted fiberglass fuselage and film-covered wood wing and tail.
- Comes with a complete power system, including a Speed 400 brushed motor, 3:1 gear drive, 30A ESC, 9.6V 1800mAh NiMH, spinner and prop.

GPMA1165

Wingspan: 43 in (1090 mm)

Wing Area: 237 in² (15.3 dm²)

Weight: 26-32 oz (735-905 g)

Wing Loading: 15.8-19.4 oz/ft² (48-59 g/dm²)

Length: 31 in (785 mm)

Requires: 4-channel radio w/4 micro servos

Lancair is a registered trademark of Lancair Incorporated.



FAIRCHILD PT-19^{ARF}

- Styled after the trainer that helped thousands of Army Air Corps pilots earn their wings.
- Fast and easy ARF assembly with details you'd expect only in a kit.
- A prebuilt motor box makes installing a brushless motor a snap.

GPMA1149

Wingspan: 41.5 in (1055 mm)

Wing Area: 270 in² (17.4 dm²)

Weight: 23-29 oz (650-820 g)

Wing Loading: 12.3-15.5 oz/ft² (38-47 g/dm²)

Length: 31.5 in (800 mm)

Requires: 4-channel radio w/3 micro servos, 28-30-950 outrunner BL motor, 25A BL ESC, 11.1V 1500mAh LiPo battery & prop

PBY CATALINA^{ARF}

- The fast, fun way to enjoy seaplane adventures!
- Thrilling water takeoffs and landings are just a few hours away.
- Quality construction features include a fiberglass fuselage, built-up wood wing and tail and molded ABS wing tip floats.



GPMA1154

Wingspan: 53.5 in (1360 mm)

Wing Area: 395 in² (25.5 dm²)

Weight: 3-3.25 lb (1360-1470 g)

Wing Loading: 18-19 oz/ft² (55-58 g/dm²)

Length: 34.25 in (870 mm)

Requires: 4+ channel radio w/4 micro servos, two 950kV outrunner BL motors, two 25A BL ESCs & 11.1V 2100mAh LiPo battery



GPMA1161
Wingspan: 48 in (1220 mm)
Wing Area: 383 in² (24.7 dm²)
Weight: 2.75-3 lb (1250-1360 g)
Wing Loading: 17-18 oz/ft² (52-55 g/dm²)
Length: 39 in (990 mm)

Requires: 4-channel radio w/3
servos, 42-40-1000 outrunner
BL motor, 45A BL ESC (min) &
11.1V 3200 LiPo battery

Super Sportster™ EP ARF

Designed for brushless power and performance brilliance!

- The classic sport plane updated for brushless motors and LiPo packs!
- Great as a low-wing trainer, relaxing sport flyer or spectacular, high-speed aerobat!
- Performs like a sport-flying champ and touches down with trainer-like ease!
- Factory-assembled, with MonoKote trim, painted fiberglass parts and prehinged ailerons for extra ease.



Bullet-fast in the air — and off the bench!

- A great choice for experienced pilots and grab n' go flying almost anywhere.
- Assembled, painted and decaled! Ready for a hand launch in 30 minutes or less!
- Exceptionally maneuverable, with a factory-installed 180 motor for blink-and-it's-gone speeds!
- Sleek, 1-piece canopy doubles as an easy-access hatch for a battery and onboard gear.

INCLUDES:

- 180-sized brushed motor
- 2 props

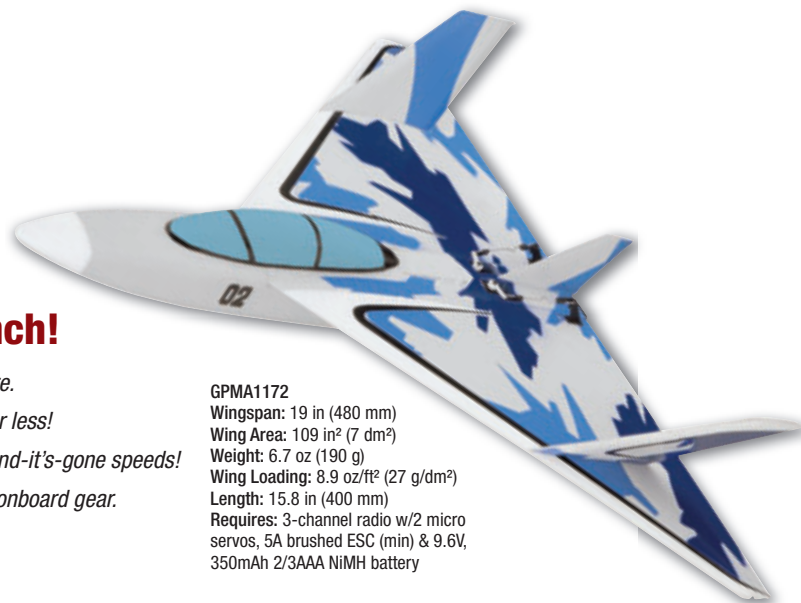

GPMA1172
Wingspan: 19 in (480 mm)
Wing Area: 109 in² (7 dm²)
Weight: 6.7 oz (190 g)
Wing Loading: 8.9 oz/ft² (27 g/dm²)
Length: 15.8 in (400 mm)
Requires: 3-channel radio w/2 micro
servos, 5A brushed ESC (min) & 9.6V,
350mAh 2/3AAA NiMH battery

INCLUDES:

- 280-sized brushed motor
- 3.5:1 gear drive
- Nylon propeller



GPMA1100
Wingspan: 41 in (1040 mm)
Wing Area: 496 in² (32 dm²)
Weight: 11-12 oz (310-340 g)
Wing Loading: 3 oz/ft² (9 g/dm²)
Length: 38.5 in (980 mm)
Requires: 3-channel radio w/2 micro servos, 5A
brushed ESC (min) & 9.6V 650mAh NiMH battery

YARD STIK™ ARF

Ready to fly whenever — and wherever — you are!

- Just right for low- or no-time pilots: super-simple, slow-flying and easy to handle.
- Floats through the air at a walk, giving new pilots more time to make good control decisions.
- Plug-in components reduce assembly time to about an hour — and hold weight to 12 ounces or less.
- Assembles from tough nylon parts, a strong, crash-resistant carbon-fiber boom and balsa sections covered in an ultralight film.

Two choices in ballistic speeds and incredible agility!

Mini Slinger™ ARF

A compact blast of fast!

GPMA1178

Wingspan: 31.5 in (805 mm)

Wing Area: 230 in² (24.8 dm²)

Weight: 7.5-8.5 oz (215-240 g)

Wing Loading: 4.7-5.3 oz/ft² (14-16 g/dm²)

Length: 15 in (380 mm)

Requires: 3-4 channel radio w/2 sub-micro servos and elevon mixing, 10A brushed ESC (min) & 9.6V, 350mAh NiMH battery

INCLUDES:

- 180-sized brushed motor
- 2 props

■ B2 bomber-inspired fliers are ready for hand launches and fast flights in just 20-30 minutes!

■ Molded foam and plastic parts are factory-finished to eliminate building and painting.

■ Upswept ABS winglets take seconds to attach and stabilize flight at all speeds.

■ Easy fits for parks, playgrounds, flying fields... and backseats!

Slinger™ ARF

Bigger in size, but equal in speed and agility!

GPMA1180

Wingspan: 47.4 in (1205 mm)

Wing Area: 459 in² (29.6 dm²)

Weight: 23 oz (650 g)

Wing Loading: 7.2 oz/ft² (22 g/dm²)

Requires: 3-4 channel radio w/2 mini servos and elevon mixing, 15A brushed ESC (min) & 9.6V, 1100mAh NiMH battery

INCLUDES:

- Speed 400 brushed motor
- 2 props

For screaming vertical — or wide-eyed aerobatics!

- A satisfying sport plane with brushed motors — a sizzling hotliner with brushless power!
- Low parts count, installed wooden motor mount and covered wings simplify assembly.
- Woven carbon-fiber fuselage adds strength, stiffness...and bold good looks!
- Delivers loops, rolls and inverted flight with economical 3-channel systems!

Siren™ ARF



GPMA1065

Wingspan: 79 in (2005 mm)

Wing Area: 430 in² (27.7 dm²)

Weight Range: 2.25-2.5 lb (1020-1130 g)

Wing Loading: 12-13 oz/ft² (37-40 g/dm²)

Length: 39 in (980 mm)

Requires: 3-4 channel radio w/3 micro servos, 600-size brushed motor, 30A ESC (min), 8.4V, 2000mAh NiMH battery & folding prop.

3D ARFs

YAK 55 ARF

Agility — and durability — that's truly amazing!

- Fly with confidence — durable FlightFlex material allows the YAK 55 to bounce back from virtually any crash!
- Thanks to the plane's light weight, large control surfaces and dual external-mounted servos, you can perform almost any 3D or high-alpha maneuver imaginable.
- The canopy unzips for easy access to on-board gear. The included prop saver lets the prop deflect back upon landing.

INCLUDES:

- 370 brushed BB motor
- Prop
- Prop saver

GPM1274
Wingspan: 34.5 in (875 mm)
Wing Area: 352 in² (22.7 dm²)
Weight: 14-16 oz (397-454 g)
Wing Loading: 5.7-6.5 oz/ft² (17-20 g/dm²)
Length: 38 in (965 mm)

Requires: 4-channel radio w/4 micro servos, micro receiver, 25A brushed ESC (min) & 11.1V 1200mAh LiPo battery



U-Can-Do 3D ARF

It's 3 planes in 1 — and all are nearly indestructible!

- It's an ARF, a park flyer and a 3D trainer that's capable of going from mild to wild!
- Mishaps are not a problem — the FlightFlex airframe is designed with plenty of "give" to fly again and again.
- A low parts count and factory-applied trim scheme means you can have your U-Can-Do 3D flight-ready after just 2-4 hours of easy assembly.

INCLUDES:

- 280 brushed BB motor
- Prop
- Prop saver

GPM1275
Wingspan: 33.5 in (850 mm)
Wing Area: 369 in² (24 dm²)
Weight: 15 oz (410 g)
Wing Loading: 5-6 oz/ft² (15-18 g/dm²)
Length: 36.5 in (925 mm)

Requires: 4-channel radio w/4 micro servos, micro receiver, 25A brushed ESC (min) & 11.1V 1200mAh LiPo battery

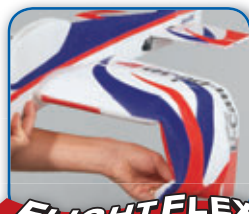

3D ARFs

YAK 55 3D ARF

Giant performance – in a park flyer size!

- Performs extreme maneuvers effortlessly and inexpensively, thanks to its brushed motor system!
- Huge control surfaces and a full flying stabilizer give the YAK 55 impressive hovering ability.
- Sized right for the park, playground or backyard!

INCLUDES:

- 280 brushed BB motor
- Prop
- Prop saver

GPMA1190

Wingspan: 33.5 in (850 mm)

Wing Area: 297 in² (19 dm²)

Weight: 12-14 oz (330-380 g)

Wing Loading: 6-7 oz/ft² (17-20 g/dm²)

Length: 33 in (840 mm)

Requires: 4-channel radio w/3 nano servos, micro receiver, 20A brushed ESC (min) & 11.1V 1200mAh LiPo battery



Fly this plane on
REALFLIGHT
64.5

Sailplane ARFs

SPECTRA™

2-METER ELECTRIC SAILPLANE

Great for new and experienced pilots!

- The ARF can be flight-ready in a few hours – or get the RTF airborne in a matter of minutes!
- A triple-taper, polyhedral wing offers massive lift and reassuring stability.
- Its tinted canopy lifts off for easy access to on-board gear, and features a high-tech, NACA-style cooling vent.
- A T-601 motor allows the Spectra to climb from 0 to 500 feet in just a minute!

EXPERTLY COVERED WITH
MONOKOTE™

Select RTF* (GPMA17**) Wingspan: 78.5 in (1995 mm)
Wing Area: 676 in² (43.6 dm²)
Weight: 50 oz (1415 g)
Wing Loading: 10.7 oz/ft² (33 g/dm²)
Length: 41.5 in (1055 mm)

*Please note that the **Kit** (GPMA0540) weighs 48 oz (1360 g) and features a wing loading of 10.2 oz/ft² (31 g/dm²).

ARF & KIT INCLUDE:

- T-601 brushed motor system

- 8x4 folding prop

SELECT RTF INCLUDES:

- 3-channel radio

- 30A ESC

- 8.4V 2100mAh NiCd battery

- 8x4 folding prop



GPMA1050 Spectra ARF
GPMA0540 Spectra Kit

ARF requires: 3-4 channel radio w/2-3 servos, 30A brushed ESC (min) & 8.4V 2100mAh NiMH battery
RTF requires: 12 "AA" batteries

Kit requires: 2-3 channel radio w/2 servos, 30A brushed ESC (min.), 8.4V 1900mAh NiMH battery & 2+ rolls MonoKote.

Kits



Quick and easy to build. Slow and easy to fly!

- Stable and self-righting — perfect for first-time pilots.
- Can be built and covered in just a weekend, even by new modelers.
- Laser-cut balsa parts fit easily and produce a light, strong airframe.



GPM0001
Wingspan: 42 in (1065 mm)
Wing Area: 294 in² (12.5 dm²)
Weight (RTF): 9-13 oz (255-370 g)
Wing Loading: 4.4-6.4 oz/ft² (12-30 g/dm²)
Length: 28.5 in (725 mm)

Requires: 3-channel radio w/2 micro servos, 280-size brushed motor, 4.1:1 gear drive, 5A brushed ESC (min), 8.4V 650mAh NiMH battery, prop & 3 sheets Coverite[™] CoverLite[™] film

Fly this plane on
REALFLIGHT
65



“Full-size” looks — and filled with potential!

- Features a flat-bottom wing for trainer-like stability and instructions for adding optional ailerons.
- A natural for Sunday sport flying or exploring basic aerobatics.
- Builds light, strong and fast from laser-cut balsa parts.



GPM0002
Wingspan: 44.8 in (1140 mm)
Wing Area: 306 in² (19.7 dm²)
Weight (RTF): 9.5-13.5 oz (270-385 g)
Wing Loading: 4.4-6.3 oz/ft² (13-19 g/dm²)
Length: 28.5 in (725 mm)

Requires: 3-4 channel radio w/2-3 micro servos, 280-size brushed motor, 4.1:1 gear drive, 5A brushed ESC (min), 8.4V 650mAh NiMH battery & 3 sheets Coverite CoverLite film

Recommended Power Systems (BLT and Tutor)

T-280GD ESC System (GPMG0430)

- Includes Speed 280 brushed motor, 4.1:1 gear drive, C-12 brushed ESC, slow-flyer prop, pinion gear & prop adapter.

T-280GD ESC System (GPMG0445)

- Same as GPMG0430, without speed control.

FUNDANGO™ KIT

The seasoned pilot's "little friend".

- Oversized elevator and ailerons provide plenty of aerobatic agility.
- Fiberglass and balsa airframe weighs just 4 ounces — all-up weight barely reaches one pound!
- Easy to transport for "grab and go" flying.



GPMA0050
 Wingspan: 35 in (890 mm)
 Wing Area: 350 in² (22.6 dm²)
 Weight: 13-16 oz (370-455 g)
 Wing Loading: 5.3-6.6 oz/ft² (16-20 g/dm²)
 Length: 30 in (760 mm)
 Requires: 4-channel radio w/2 micro servos, 400 brushed motor, 3.8:1 gear drive, 10A brushed ESC (min), 9.6V 1100mAh NiMH battery & 1 roll transparent covering

Classic Cub styling for electric aces!

J-3 ELECTRIC CUB™ KIT

- Builds straight and strong from interlocking wood parts.
- ABS cowl, formed windows and engine cylinders deliver true-to-Cub detail.
- Low-dihedral wing features ailerons for improved agility — and bolts on for transport convenience.



GPMA0156
 Wingspan: 58.8 in (1490 mm)
 Wing Area: 472 in² (30.4 dm²)
 Weight: 3.3-3.5 lb (1475-1590 g)
 Wing Loading: 16-17 oz/ft² (49-52 g/dm²)
 Length: 37 in (940 mm)
 Requires: 3-4 channel radio w/4 micro servos, 30A brushed ESC (min), 8.4V 1700mAh NiMH battery & 2+ rolls of MonoKote®

INCLUDES:

- S-600 brushed motor
- Switch harness
- Aluminum spinner
- Nylon prop

PT-Electric™ KIT

A larger, self-righting first step into electric flight.

- Builds with the self-aligning strength of interlocking, all-wood parts and the ease of step-by-step, photo instructions.
- Flies easily at the low speeds new pilots prefer.
- Self-recovers from stalls and steep banks.
- No takeoffs required — just hand-launch for long and quiet flights!



GPMA0110
 Wingspan: 56 in (1420 mm)
 Wing Area: 500 in² (32.3 dm²)
 Weight: 2.8 lb (1250 g)
 Wing Loading: 14 oz/ft² (43 g/dm²)
 Length: 39.5 in (1005 mm)

Requires: 3-4 channel radio w/3 servos, 8.4V, 1900mAh NiMH battery & 2 rolls MonoKote film

INCLUDES:

- T-600 brushed motor
- Propeller
- ON/OFF speed control
- Switch harness
- Spinner

AMMO™ Inrunner Motors

For maximum performance and unmatched efficiency in flight!

- An excellent choice for direct drives — or with matched Ammo Gear Drives.
- Drop-in compatible with ElectriFly motor mounts.



AMMO Gear Drives

- Designed for durability, with aluminum frames, dual ball bearing-supported steel shafts, brass pinion gears and nylon spur gears.
- GPMG0500 fits on a standard 10x10 stick — all others attach directly to motor mount.
- Pinions help fine-tune drive ratio for optimum performance.
- All include a prop saver or adapter, 2 pinion gears, 1 or 2 spur gears and hardware; GPMG0505-0515 also require motor mount.
- Planetary Gearbox lets you mount up to 685 watts of power in a slender package — ideal for boosting performance, extending motor life and providing a brushless power option for your glider, hotliner or racer.

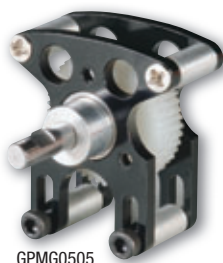

GPMG0505



GPMG0500

GPMG0495	Direct Mount – 12 mm motors
GPMG0500	Stick Mount – 20 mm motors
GPMG0505	Direct Mount – 24 mm motors
GPMG0510	Direct Mount – 28 mm motors
GPMG0515	Direct Mount – 36 mm motors
GPMG0520	Planetary Gearbox



GPMG0520

Motor Shopping by the Numbers!

Match the diameter and length to the power you want!

Example: **28-26-1000**

First number:
Diameter (mm)

Second Number:
Length (mm)

Third number:
Output: RPM/V (kV)
RPM per volt of input

Brushless

- They're the most efficient electric motor power system available — with virtually instantaneous throttle response!
- Reduce friction and maintenance to near zero — while extending motor life to the max.
- Ideal for brushed-to-brushless upgrades and glow-to-electric conversions — and great for everything from tiny, 4-oz. indoor flyers to multi-motored giants.

Inrunner Brushless Motor Chart

Stock #	Description	Weight (oz/g)	Max. Constant Watts
GPMG5105	12-30-3850	0.6 / 16	23
GPMG5110	12-30-4110	0.6 / 16	22
GPMG5115	20-30-2650	1.6 / 45	61
GPMG5120	20-30-3500	1.6 / 45	83
GPMG5125	20-30-4300	1.6 / 45	94
GPMG5130	20-30-5200	1.6 / 45	117
GPMG5135	20-40-2080	2.3 / 65	104
GPMG5140	20-40-3500	2.3 / 65	133
GPMG5142	20-40-4040	2.3 / 65	170
GPMG5145	20-40-4850	2.3 / 65	167
GPMG5150	24-33-2500	2.4 / 67	122
GPMG5155	24-33-3500	2.4 / 67	167
GPMG5160	24-33-3180	2.4 / 67	178
GPMG5165	24-33-4040	2.4 / 67	200
GPMG5170	24-33-4875	2.4 / 67	222
GPMG5175	24-45-2350	3.6 / 101	266
GPMG5180	24-45-2900	3.6 / 101	296
GPMG5185	24-45-3790	3.6 / 101	278
GPMG5190	28-35-2200	3.3 / 94	259
GPMG5195	28-35-2700	3.3 / 94	278
GPMG5200	28-35-3900	3.3 / 94	244
GPMG5205	28-35-5100	3.3 / 94	333
GPMG5210	28-45-2100	4.6 / 133	311
GPMG5215	28-45-2700	4.6 / 133	518
GPMG5220	28-45-3600	4.6 / 133	592
GPMG5225	28-56-1530	5.9 / 166	426
GPMG5230	28-56-2300	5.9 / 166	592
GPMG5235	28-56-3200	5.9 / 166	666
GPMG5240	36-30-3200	4.8 / 138	555
GPMG5245	36-30-4000	4.8 / 138	370
GPMG5250	36-30-5300	4.8 / 138	200
GPMG5255	36-40-2250	6.5 / 185	666
GPMG5260	36-40-2900	6.5 / 185	833
GPMG5265	36-40-3900	6.5 / 185	592
GPMG5285	36-50-1500	8.6 / 243	777
GPMG5290	36-50-2300	8.6 / 243	1110
GPMG5295	36-50-3300	8.6 / 243	833
GPMG5310	36-56-1200	10 / 283	1036
GPMG5315	36-56-1800	10 / 283	1110
GPMG5320	36-56-2600	10 / 283	815
GPMG5325	36-88-1280	16.3 / 461	1300

LiPo Volts-to-Cells Conversion Chart

Volts Cells	Volts Cells	Volts Cells
7.4 = 2S	18.5 = 5S	29.6 = 8S
11.1 = 3S	22.2 = 6S	33.3 = 9S
14.8 = 4S	25.9 = 7S	37 = 10S

Motors



- Ready for easy, "plug-n'-play" installation. Male connectors are attached — and female connectors are included, too. Both are gold-plated for maximum conductivity, and compatible with performance-matched BL or Silver Series™ brushless ESCs.
- Manufactured with Neodymium magnets, double-shielded bearings and low-resistance windings.

RIMFIRE™

Outrunner Motors

Brushless performance at its easiest and most economical!

- Enjoy all-out power — and superb acceleration — instantly!
- Outrunner design eliminates the need for a gear drive — resulting in a simpler, lighter and less expensive option to brushed motor/gear drive combos.
- Innovative aluminum can helps RimFire motors run cooler and produce more power than comparably sized outrunners.
- Motor mount, hardware and prop adapter (or prop saver) included.

Outrunner Brushless Motor Chart						
Stock #	Description	Specs	Weight (oz/g)	Input (V)	Max. Constant Watts	Burst Watts
GPMG4502	RimFire 250	28-13-1750	0.7 / 20	7.4-11.1	90	120
GPMG4505	RimFire 300	28-22-1380	1.0 / 27	7.4-11.1	100	150
GPMG4525	RimFire 370	28-26-1000	1.4 / 41	7.4-11.1	135	165
GPMG4560	RimFire 400	28-30-950	1.9 / 54	7.4-11.1	160	220
GPMG4595	RimFire .10	35-30-1250	2.5 / 71	11.1	325	390
GPMG4620	RimFire .15	35-36-1200	3.6 / 102	11.1-14.8	500	650
GPMG4675	RimFire .25	42-40-1000	4.4 / 125	11.1-14.8	650	740
GPMG4700	RimFire .32	42-50-800	7.0 / 198	11.1-18.5	850	1480
GPMG4715	RimFire .55	42-60-480	9.5 / 270	11.1-18.5	1100	1850
GPMG4725	RimFire .46	42-60-800	9.5 / 268	11.1-18.5	1000	1850
GPMG4740	RimFire .80	50-55-500	10.5 / 298	18.5-22.2	1300	2200
GPMG4745	RimFire .60	50-55-650	10.5 / 298	18.5-25.9	1200	2200
GPMG4770	RimFire 1.20	50-65-450	14.1 / 400	18.5-29.6	1800	2300
GPMG4795	RimFire 1.60	63-62-250	22.4 / 635	29.6-37	2500	3200
GPMG4800	RimFire 50cc	80-75-230	44.1 / 1250	33.3-55.5	5000	6500
GPMG4805	RimFire 65cc	80-85-160	52.2 / 1480	33.3-55.5	6500	8400



HYPERFLOW™

DUCTED FAN SYSTEM

- Fully optimized ducted fan power with ElectriFly quality!
- Available separately (GPMG3910), and in a complete system with a high-performance 370-size brushed motor (GPMG3911).
- Unit can also be adapted to use a 20 mm or 24 mm brushless motor.



V-Pitch™

Variable Pitch Prop System

The power to do seemingly impossible stunts with ease!

- Push/pull pitch mechanism offers split-second response — and spectacular 3D moves!
- Stop abruptly in mid-air — reverse direction in a heartbeat — make express elevator climbs at will — or float to the ground like a feather!
- A step up for the pilot who wants to go beyond hovering and torque rolls — a drop-in upgrade for aerobatic flat foamies up to 12 oz.
- Combines a modified 22M-1000 RimFire motor, variable-pitch unit, blades and mounting hardware into an amazingly light package.
- Requires: dedicated proportional radio channel, micro servo w/17 oz.-in. of torque (min.) and brushless ESC w/governor (GPMM2075 recommended).

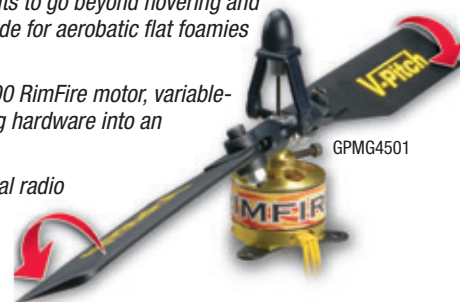

Servos

Dependable “muscle” for tiny indoor foamies to mid-size fliers!



Shown
actual size!

GPMM1200

- **ES40 Pico** — at 4 g, ideal for the indoor/outdoor park flyers, foamies and other electric airplanes.
- **ES50 Nano and ES80 Micro** — great choices for park flyers, flat foamies and other small indoor/outdoor electric aircraft.
- **ES100 Standard** — Designed for all airplanes powered by a .10-.40 glow engine or the electric equivalent.
- Lead and radio connector already attached for instant installation.

Servo Name	Stock #	Input Voltage	Torque	Speed	Dimensions (L x W x H)	Weight
ES40 Pico	GPMM1200	4.8	9.7 oz-in (0.7 kg/cm)	0.08 sec/60°	3/4 x 5/16 x 3/4 in (19.2 x 8.3 x 19.2 mm)	1/8 oz (4 g)
ES50 Nano	GPMM1210	4.8- 6.0	16.7 oz-in (1.2 kg/cm)*	0.13 sec/60°*	7/8 x 7/16 x 13/16 in (22 x 11 x 20 mm)	5/16 oz (9 g)
ES80 Micro	GPMM1220	4.8- 6.0	32.0 oz-in (2.3 kg/cm)*	0.17 sec/60°*	1-1/8 x 9/16 x 1-3/16 in (29 x 14 x 30 mm)	9/16 oz (16 g)
ES100 Std.	GPMM1230	4.8- 6.0	47.0 oz-in (3.4 kg/cm)*	0.22 sec/60°*	1-9/16 x 13/16 x 1-7/16 (40 x 20 x 36 mm)	1-7/16 oz (40 g)

* = 4.8V specifications shown.

SILVER SERIES Brushless ESCs

Tops in affordable performance — and plug-n-play ease!

- Ready for immediate hookup! Leads, Deans® battery connector, gold-plated motor bullets and universal radio connector already attached.
- Designed for complete compatibility with ElectriFly Ammo™ and RimFire™ motors and NiCd, NiMH and LiPo batteries.
- All offer smooth, proportional forward, Safe Start, ON/OFF brake and automatic low-voltage setup at pack hookup.
- Optional **Programming Card** (GPMM1895) lets you turn off Safe Start and fine-tune timing, frequency, motor rotation and voltage cutoff on **SS-60** and **SS-80** ESCs.



GPMM1850



GPMM1895



GPMM1820

Model	Stock #	Type	Input Voltage NiCd/NiMH (LiPo)	Max Cont. Current	BEC	Dimensions (LxWxH)	Weight	Battery/ Bullet Plugs
SS-8	GPMM1800	Fwd/Brake	7.2-14.4 (7.4-14.8)	8A	5V/1.5A	1-3/16 x 1-3/16 x 1/4 in (30 x 30 x 6 mm)	3/8 oz (11 g)	DeansM / 2.0 mm
SS-12	GPMM1810	Fwd/Brake	7.2-14.4 (7.4-14.8)	12A	5V/1.5A	1-5/16 x 7/8 x 1/4 in (33 x 23 x 6 mm)	1/2 oz (14 g)	DeansM / 2.0 mm
SS-25	GPMM1820	Fwd/Brake	7.2-14.4 (11.1-14.8)	25A	5V/2A	1-9/16" x 1 x 5/16 in (40 x 26 x 8 mm)	15/16 oz (26 g)	DeansU / 3.5 mm
SS-35	GPMM1830	Fwd/Brake	7.2-14.4 (11.1-14.8)	35A	5V/2A	2-1/16 x 1 x 5/16 in (52 x 26 x 8 mm)	1-1/8 oz (32 g)	DeansU / 3.5 mm
SS-45	GPMM1840	Fwd/Brake	7.2-14.4 (11.1-14.8)	45A	5V/2A	2-3/4 x 1-5/16 x 3/8 in (70 x 33 x 10 mm)	1-3/4 oz (50 g)	DeansU / 4.0 mm
SS-45D Dual	GPMM1841	Fwd/Brake	8.4-14.4 (11.1-14.8)	45A	5V/2A	2-3/4 x 1-5/16 x 3/8 in (70 x 33 x 10 mm)	1-3/4 oz (50 g)	DeansU / 4.0 mm
SS-60	GPMM1850	Fwd/Brake	16.8-38.4 (12.4-50V)	60A	n/a*	2-5/16 x 1-7/8 x 11/16 in (58 x 48 x 18 mm)	3-1/8 oz (89 g)	DeansU / 4.0 mm
SS-80	GPMM1860	Fwd/Brake	16.8-38.4 (12.4-50V)	80A	n/a*	2-3/8 x 2-5/8 x 11/16 in (60 x 67 x 18 mm)	5-1/8 oz (145 g)	Deans U / 6.0 mm

Note: Voltages based on nominal 1.2V per cell (NiCd/NiMH batteries) and 3.7V per cell (LiPo batteries).

DeansM = Deans Micro Plug connector; DeansU = Deans Ultra Plug® connector. n/a* = no BEC. Optically coupled.

Balanced LiPo Packs

Packs so good, they're guaranteed!



More voltage, less weight — two good reasons more pilots are deciding to go LiPo. Balanced LiPo packs offer two more: the ability to charge each cell to its 4.2V maximum and condition packs for longer, stronger life. And the reasons to buy Electrifly are just as good.

Start with honest numbers. If an Electrifly pack is marked 25C, you can count on 25C and a burst rate up to twice that much. Read the pack weight, and you can be sure it includes the cells,

the leads and the connectors, too. Pack construction is as solid as the numbers, with more than enough durability to stand up to day to day wear and tear.

Equip each pack with a Deans connector and a standard Electrifly balancing plug — and finish by protecting each pack with a no-nonsense, 1-year replacement guarantee.*

* For full details on the Electrifly Pack Replacement Guarantee, visit electrifly.com/battpacks.html.

Power by Electrifly —
Connectors by Deans®!

Power Series Balanced LiPo Packs

Premium LiPo performance on demand!

- The best packs for all-out 3D and contest-winning performance!
- Big, 25C continuous discharge rate help packs stay cooler during sustained, high-amp loads.
- Available in high-capacity 14.8V and 18.5V packs for larger planes, as well as 7.4V and 11.1V packs.

Choices up to 5 cells,
5,300mAh and 25C rates!

GPMP0500	11.1V 1000mAh 25C Deans Ultra	GPMP0522	18.5V 2200mAh 25C Deans Ultra
GPMP0504	7.4V 1300mAh 25C Deans Ultra	GPMP0540	7.4V 3350mAh 25C Deans Ultra
GPMP0505	11.1V 1300mAh 25C Deans Ultra	GPMP0541	11.1V 3350mAh 25C Deans Ultra
GPMP0510	7.4V 1500mAh 25C Deans Ultra	GPMP0542	14.8V 3350mAh 25C Deans Ultra
GPMP0511	11.1V 1500mAh 25C Deans Ultra	GPMP0543	18.5V 3350mAh 25C Deans Ultra
GPMP0514	7.4V 1800mAh 25C Deans Ultra	GPMP0560	7.4V 5300mAh 25C Deans Ultra
GPMP0515	11.1V 1800mAh 25C Deans Ultra	GPMP0561	11.1V 5300mAh 25C Deans Ultra
GPMP0519	7.4V 2200mAh 25C Deans Ultra	GPMP0562	14.8V 5300mAh 25C Deans Ultra
GPMP0520	11.1V 2200mAh 25C Deans Ultra	GPMP0563	18.5V 5300mAh 25C Deans Ultra
GPMP0521	14.8V 2200mAh 25C Deans Ultra		

Deans Micro = Deans Micro Plug Connector; Deans Ultra = Deans Ultra Plug® Connector.



GPMP0515



GPMP0520



GPMP0541

BP Series Balanced LiPo Packs

Balanced-pack performance for the budget.

GPMP0700	7.4V 300mAh 20C Deans Micro
GPMP0701	11.1V 300mAh 20C Deans Micro
GPMP0704	7.4V 640mAh 15C Deans Micro
GPMP0705	11.1V 640mAh 15C Deans Micro
GPMP0708	7.4V 910mAh 15C Deans Ultra
GPMP0709	11.1V 910mAh 15C Deans Ultra
GPMP0714	7.4V 1250mAh 20C Deans Ultra
GPMP0715	11.1V 1250mAh 20C Deans Ultra
GPMP0718	7.4V 1600mAh 20C Deans Ultra
GPMP0719	11.1V 1600mAh 20C Deans Ultra
GPMP0722	7.4V 2300mAh 20C Deans Ultra
GPMP0723	11.1V 2300mAh 20C Deans Ultra
GPMP0726	7.4V 3200mAh 20C Deans Ultra
GPMP0727	11.1V 3200mAh 20C Deans Ultra

- The economical way to enjoy LiPo performance!
- Over a dozen ways to tap power instantly — and handle sudden, high-amp moves with ease!

Volts-to-Cells Conversion Chart	
Volts	Cells
7.4	2S
11.1	3S
14.8	4S
18.5	5S



GPMP0719



GPMP0723



GPMP0727

Triton™ Chargers, EQ Boards & Probe

TRITON²

COMPUTERIZED CHARGER/
DISCHARGER/CYCLER

- Charges and discharges 1-24 cell NiCd/NiMHs, 1-5 cell LiPos/Lilons and 6V, 12V or 24V lead-acid batteries.
- Can cycle NiCd and NiMH cells up to 10 times automatically.
- 0.1-7.0A fast charge rates.
- 0-250mA trickle charge rates for NiCd/NiMHs.
- 0.1-3.0A discharge current.
- Includes banana plugs with mating alligator clips on input.
- Thermal probe port.

GPMM3153

Weight: 16.4 oz (466 g)

Dimensions: 6.2 x 4.0 x 2.0 in (157 x 102 x 51 mm)



Both offer:

- A blue backlit 2 x 16 LCD screen.
- 100% compatibility with the Equinox™ LiPo Cell Balancer!



Optional Thermal Probe (GPMM3151) monitors heat-sensitive NiMH and lithium batteries. Compatible only with the Triton2 and Triton2 EQ.

TRITON^{Jr.}

COMPUTERIZED CHARGER/
DISCHARGER/CYCLER

- Charges and discharges 1-14 cell NiCd/NiMHs, 1-4 cell LiPos/Lilons and 2-12V lead acid batteries.
- Can cycle NiCd and NiMH cells up to 5 times automatically.
- 0.1-5.0A fast charge rates.
- 0.1-1.0A discharge current.
- Ideal for smaller-sized, electric flight applications.
- Features a 4-direction membrane touchpad with an easy-programming menu.
- Housed in a rugged all-aluminum case.

GPMM3152

Weight: 13.1 oz (371 g)

Dimensions: 4.7 x 3.6 x 1.2 in (118 x 92 x 30 mm)



TRITON²EQ

COMPUTERIZED CHARGER/
DISCHARGER/CYCLER/BALANCER

- Charges and discharges 1-24 cell NiCds/NiMHs, 1-6 cell LiPos/Lilons and 6-24V lead-acid batteries.
- Can cycle NiCd and NiMH cells 1-10 times automatically.
- 0.1-8.0A fast charge rates.
- 0.1-3.0A discharge current.
- 10 battery memories.
- Thermal probe port.

Includes
built-in lithium
balancer!

GPMM3156

Weight: 16.4 oz (466 g)

Dimensions: 6.2 x 4 x 2 in (157 x 102 x 51 mm)



Both offer:

- LiFe (A123™) compatibility.
- A reversed, backlit LCD with a 0-45° adjustable viewing angle.
- A built-in switching AC power supply.
- Balancing for up to 6S lithium packs.
- FlightPower™ and ElectriFly balancing adapter boards.

TRITONEQ

COMPUTERIZED CHARGER/
DISCHARGER/CYCLER/BALANCER

- Charges and discharges 1-14 cell NiCds/NiMHs, 1-6 cell LiPos/Lilons and 2-12V lead-acid batteries.
- Can cycle NiCd and NiMH cells 1-5 times automatically.
- 0.1-5.0A fast charge rates.
- 0.1-1.0A discharge current.

Includes
built-in lithium
balancer!

GPMM3155

Weight: 23.8 oz (675 g)

Dimensions: 5.9 x 6.0 x 2.3 in (150 x 153 x 58 mm)



EQ Balancing Boards

- Compatible with 7.4V-22.2V LiPo packs.
- Available with **FlightPower** (GPMM3201) and **ElectriFly** (GPMM3200) balancing plugs.

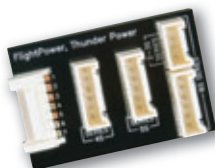

GPMM3201

Chargers

POLYCHARGE⁴

FOUR-OUTPUT LITHIUM-POLYMER CHARGER

Charges up to four LiPo packs simultaneously!

Ideal for use with Equinox™ LiPo Cell Balancer.



- Independent outputs let you start/stop charging with push-button ease — and adjust charge current to pack capacity.
- Charging ends when the pack is fully charged, or at the end of the safety timer's 3-hour limit.
- Identifies problems with sight and sound cues — includes a built-in cooling fan to carry away heat.

GPMM3015
Input Voltage: 12-15V DC
Capacity (each output): 1-4 cells, 300-3000mAh

Charge Rates: 300 – 3000mA
Dimensions: 8.2 x 5 x 1.5 in (210 x 125 x 40 mm)
Weight: 21.8 oz (615 g)

12V 12A Power Supply

A perfect, low-priced power source for all ElectriFly Triton™ chargers and more!



- State-of-the-art switching technology — essential for delivering clean DC power to sensitive equipment.
- Compact and lightweight, reducing your flight box load and work area clutter.
- Built-in current limiter prevents damage from accidental overloads — top-mounted cooling fan increases efficiency and lifespan.

GPMP0901
Input Voltage: 110-120V 60Hz
DC Output Voltage: 13.8 volts
DC Output Current: 12 amps maximum
Maximum Rated Power: 165W

Output Connections: 4mm banana jacks
Overload Protection: Solid-state current limiter
Case Size: 5.4 x 4.9 x 2.4 in (132 x 125 x 61 mm)
Weight: 29 oz (822 g)

POLYCHARGE™

LITHIUM-POLYMER CHARGER

The low-cost, “no-frills” option in LiPo charging.

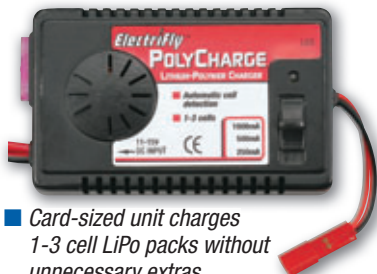

- Card-sized unit charges 1-3 cell LiPo packs without unnecessary extras.
- Features switch-selectable charge rates, plus light and sound to signal diagnostic alerts and changes in charge status.
- Includes alligator clips on input and a 2-pin output connector.

GPMM3010
Input Voltage: 11-15V DC
Capacity: 1-3 cells
Charge Rates: 250, 500, and 1000mA
Dimensions: 3.5 x 2.2 x 0.9 in (88 x 55 x 23 mm)
Weight: 4.4 oz (125 g)

PEAK 400™

DC 1-10 CELL PEAK CHARGER

The “win-win” choice for cost-conscious pilots.



- Peaks NiCd and NiMH packs with push-button ease — switches to trickle rates automatically.
- Perfect for Speed 400-size packs built from “AAA” to 2/3 sub-C cells!
- Includes input cord with alligator clips, output cord with standard connector and 2-pin adapter.

GPMM3001
Input Voltage: 11-15V DC
Capacity: 1-10 cells
Fast Charge Rates: 0.5, 1.2 & 2.5A
Trickle Charge Rates: 40, 60 & 100mA
Dimensions: 3.8 x 2.3 x 1 in (95 x 57 x 25 mm)
Weight: 4.9 oz (140 g)

NiMH

DC Peak Charger

The at-field answer to peak charging!

NiMH

GPMM3000
Input Voltage: 11-14V DC
Capacity: 6-8 cells
Fast Charge Currents: 200 & 600mA
Trickle Charge Current: 15mA
Safety Protection: Fused overload and reverse polarity



AC Park Flyer Peak Charger

At-home charging ease!

GPMM3005
Input Voltage: 110V AC
Capacity: 1-8 cells
Fast Charge Current: 200-800mA
Trickle Charge Current: 10-15mA
Dimensions: 3.2 x 2.3 x 2.3 in (80 x 60 x 60 mm)
Weight: 19 oz (535 g)

NiMH



Equinox LiPo Balancer & Leads

Equinox™

LiPo Cell Balancer



Equalize cells and maximize pack performance.

- Balances the voltage of 2-5 LiPo cells to very tight tolerances, ensuring the maximum possible safe voltage during charging — for more power and longer pack life.
- Handles 3A maximum current during charge or discharge — up to 6A with optional 2S/5S High Power connectors.
- Includes 7.4V and 11.1V battery adapters (additional adapters available separately — see listings below).
- Automatically checks for poor quality cells and provides a safe platform for charging*.

*Compatible only with LiPo packs which are wired for balancing.

Also features:

- Easy, push-button operation
- 8 status LEDs for easy monitoring
- Gold-plated banana plugs on input
- Compact size: 3.2 x 1.6 x 0.6 in (82 x 40 x 15 mm)
- Light weight: 1.55 oz (44 g)
- Overload protection

GPMM3160	Equinox LiPo Cell Balancer	GPMM3182	FlightPower 4S Adapters (3)
GPMM3161	ElectriFly 2-3S Leads	GPMM3183	FlightPower 5S Adapters (3)
GPMM3162	ElectriFly 4-5S Leads	GPMM3185	FlightPower 2S High Power Adapters (3)
GPMM3163	ElectriFly 2-5S Hi Power Leads	GPMM3186	FlightPower 3S High Power Adapters (3)
GPMM3180	FlightPower 2S Adapters (3)	GPMM3187	FlightPower 4S High Power Adapters (3)
GPMM3181	FlightPower 3S Adapters (3)	GPMM3188	FlightPower 5S High Power Adapters (3)

Adapters and Charge Leads

- The easy, "no solder" way to match batteries to chargers, speed controls, etc.
- Parallel adapters let you increase battery capacity and run times.
- Series adapters let you increase voltage for more power.
- Unique adapters allow easy connection of components with different plug types.
- Choose from a large variety of gold-plated male and female banana plugs.

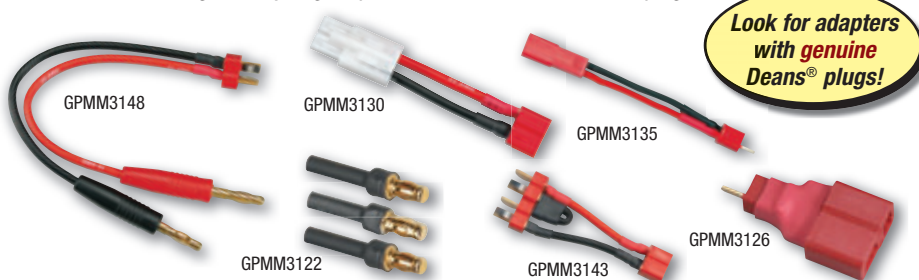

GPMM3120	2 mm Male/3.5 mm Female Bullet Adapter (3)	GPMM3138	2 mm Male Bullet / JST Male Adapter
GPMM3121	3.5 mm/4 mm Female Bullet Adapter (3)	GPMM3139	2 mm Fem Bullet / JST Female Adapter
GPMM3122	3.5 mm/2 mm Female Bullet Adapter (3)	GPMM3141	Deans Ultra Parallel ESC Adapter
GPMM3123	4 mm/3.5 mm Female Bullet Adapter (3)	GPMM3142	Parallel Deans Ultra Adapter 2 to 1
GPMM3126	Deans Micro / Deans Female Ultra Adapter	GPMM3143	Series Deans Ultra Adapter 2 to 1
GPMM3127	Deans Micro / Deans Male Ultra Adapter	GPMM3146	Parallel Deans M Adapter 2 to 1
GPMM3130	Female Ultra / Std Female Adapter	GPMM3147	Series Deans M Adapter 2 to 1
GPMM3131	Deans Male Ultra / Std Male Adapter	GPMM3148	Chrg Lead Banana/ Deans Male Ultra
GPMM3134	Deans Micro / JST Female Adapter	GPMM3149	Chrg Lead Banana/ Deans Micro
GPMM3135	Deans Micro / JST Male Adapter	GPMM3150	Banana Charge Lead/HMX Micro

Miscellaneous Accessories

GPMM1000	Switch/Charge Jack Mount Set
GPMM1010	Rx Guard Case
GPMM1050	1070 Heat-Shrink Tubing
GPMM3100	Futaba Tx Charge Adapter
GPMM3101	Hitec/Air Tx Charge Adapter
GPMM3102	JR Tx Charge Adapter
GPMM3103	2-Pin Female/Male Fut J Adapter
GPMM3104	2-Pin Male/Female Fut J Adapter
GPMM3105	2-Pin Male/Male Banana Adapter
GPMM3106	2-Pin Male Red Connectors (2)
GPMM3107	2-Pin Female Red Connectors (2)
GPMM3108	2-Pin Female Std Connector
GPMM3109	GP Power Connectors (HCAA42**) 1 set
GPMM3110	GP Male Bullet Connectors 2 mm (3)
GPMM3111	GP Female Bullet Connectors 2 mm (3)
GPMM3112	GP Male Bullet Connectors 3.5 mm (3)
GPMM3113	GP Female Bullet Connectors 3.5 mm (3)
GPMM3114	GP Male Bullet Connectors 4 mm (3)
GPMM3115	GP Female Bullet Connectors 4 mm (3)
GPMM3116	GP Bullet Connector Male 6 mm (3)
GPMM3117	GP Bullet Connector Female 6 mm (3)
GPMM3118	4 mm Male/6 mm Female Bullet Adapter (3)
GPMM3119	6 mm Male/4 mm Female Bullet Adapter (3)

GP = Gold-Plated.

Props, Prop Adapters, Spinners & Mounts

PowerFlow™

Propellers

- Specially shaped blade tips are turned back for longer flights and greater thrust, while reducing drag and using less motor power.



Stock #	DiameterxPitch in (mm)	Stock #	DiameterxPitch in (mm)	Stock #	DiameterxPitch in (mm)
GPMQ6610	8x3.5 (203x89)	GPMQ6655	10x3.5 (254x89)	GPMQ6695	11x4.5 (279x114)
GPMQ6630	9x4.5 (229x114)	GPMQ6660	10x4.5 (254x114)	GPMQ6801	11x8.5E (279x216)
GPMQ6640	9x6 (229x152)	GPMQ6675	10x7 (254x152)		

Prop Adapters

- Prop Adapters fit standard size propellers onto a motor shaft.
- Easy to use – adapter's split end goes onto a prop shaft and compresses as the nut is tightened in front of the propeller at the opposite end.
- Adapters for RimFire™ motors also available.

Motor Shaft Dia (mm)	Output Thread	Set Screw Adapter	Collet Adapter	Collet Adapter with Cone
1.5	3 mm	N/A	GPMQ4950	GPMQ4982
2.0	5 mm	N/A	GPMQ4953	GPMQ4984
2.3	5 mm	N/A	GPMQ4956	GPMQ4986
3.0	5 mm	GPMQ4930	GPMQ4959	GPMQ4988
3.175	5 mm	GPMQ4933	GPMQ4962	GPMQ4990
4.0	1/4 x 28	GPMQ4936	GPMQ4965	GPMQ4992
5.0	5/16 x 24	GPMQ4939	GPMQ4966	GPMQ4994
6.0	5/16 x 24	GPMQ4942	GPMQ4968	GPMQ4996
8.0	3/8 x 24	GPMQ4945	GPMQ4971	GPMQ4998



Set Screw 8 mm to 3/8x24



Collet 2 mm to 5 mm



Collet w/Cone 5 mm to 5/16x24

GPMQ4901	RimFire Prop Adapter 28 mm
GPMQ4906	RimFire Prop Adapter 42 mm
GPMQ4909	RimFire Prop Adapter 50 mm
GPMQ4912	RimFire Prop Adapter 63 mm

Brushless Motor Mounts

- Made of strong, lightweight aluminum.
- Hex-head hardware simplifies installation and adjustment.
- Ideal for Ammo™ and RimFire motors – compatible with most others.
- Feature the same bolt pattern as Great Planes® Adjustable Engine Mounts (GPMG1041, 1061, 1091 and 1101).
- Match size to can diameter. Length adjusts to fit.



GPMG1255

Stock #	Size	For Ammo	For RimFire
GPMG1250	Small	24 mm	28 mm
GPMG1255	Medium	28 mm	35 mm
GPMG1260	Large	36 mm	42 & 50 mm
GPMG1265	X-Large	N/A	63 mm
GPMG1200	Small	N/A	28 mm
GPMG1205	Medium	N/A	35-42 mm
GPMG1210	Large	N/A	50-63 mm
Standoff Mounts			
GPMG1270	X-Large	N/A	63 mm
GPMG1275	XX-Large	N/A	80 mm



E-Spinners

- Lighter weight means less rotating mass for more power.
- All include a lightened aluminum backplate.
- Adapters also available.

GPMQ4700	E-Spinner 1.5" Trans Black
GPMQ4701	E-Spinner 1.5" Trans Red
GPMQ4702	E-Spinner 1.5" Trans Blue
GPMQ4703	E-Spinner 1.5" Aluminum
GPMQ4708	E-Spinner 1.75" Trans Black
GPMQ4709	E-Spinner 1.75" Trans Red
GPMQ4710	E-Spinner 1.75" Trans Blue
GPMQ4711	E-Spinner 1.75" Aluminum
GPMQ4716	E-Spinner 2.0" Trans Black
GPMQ4717	E-Spinner 2.0" Trans Red
GPMQ4718	E-Spinner 2.0" Trans Blue
GPMQ4719	E-Spinner 2.0" Aluminum
GPMQ4724	E-Spinner 2.25" Trans Black
GPMQ4725	E-Spinner 2.25" Trans Red
GPMQ4726	E-Spinner 2.25" Trans Blue
GPMQ4727	E-Spinner 2.25" Aluminum

GPMQ4730	E-Spinner Adapter 5 mm
GPMQ4731	E-Spinner Adapter 1/4" -28
GPMQ4732	E-Spinner Adapter 5/16" -24
GPMQ4733	E-Spinner Adapter 3/8" -24

Miscellaneous Props & Adapters

GPMQ1690	8x4 Folding Prop
GPMQ1695	Prop Adapter Set
GPMQ4600	Prop Adapter — 3 mm Shaft
GPMQ4610	Prop Adapter — 10 mm Shaft
GPMQ4619	Prop Saver O-Rings

“Load and Go” ease for electric pilots.

- Compact for easy storage and transportation — balanced for easy carrying.
- Factory-finished and prebuilt of light, laser-cut 1/8" (3 mm) ply.
- Angled top trays position chargers for instant access and easy use.
- Vented battery compartments accept most 12V maintenance-free batteries.



GPMP1004
Dimensions 18.6 x 9.1 x 12.0 in (472 x 230 x 305 mm)

Ultra E-BOX™

Easy to handle — hard to beat.

- Unique, two-handle design ensures even weight distribution.
- Holds two chargers, two batteries, a transmitter and all accessories.
- Tray floor includes banana jacks for easy charger hookup — recharge packs from the box using its exterior switch and jacks.
- Hook & loop fasteners trap two batteries and a hidden drawer inside the battery compartment.
- Top tray features movable divider, plus slots and cutouts for packs, tools and CA.



Compact E-BOX™

Sized for the essentials!

- Less than 7" square — and just over 10" high.
- Holds a Triton™2 or Triton Jr. charger so securely that it can't fall out — even if the E-Box is tipped over!
- Includes deep drawer, recessed battery jacks and battery harness.

GPMP1006
Dimensions 6.9 x 6.8 x 10.2 in (176 x 173 x 258 mm)

PRO ADHESIVES

STICK WITH THE PROS!

Fast, strong bonds for wood and foam.

- The best choice for building and quick repairs!
- Available in general-use formulas and foam-safe formulas, as well as epoxies.
- All CAs offer extra-long, clog-resistant tips and “Best If Used By” label dating as proof of freshness.



GPMR6001

GPMR6073

GPMR6042

GPMR6039

GPMR6001	Thin CA ½ oz (14.2 g)	GPMG6036	Foam-Safe CA Activator Refill 8 oz.
GPMR6002	Thin CA 1 oz (28.4 g)	GPMG6039	CA Debonder 1 oz (28.4g)
GPMR6003	Thin CA 2 oz (56.7 g)	GPMG6041	Glue-B-Gone ½ oz
GPMR6004	Thin CA 4 oz (113 g)	GPMR6042	6-Min Pro Epoxy 4 oz
GPMR6007	Medium CA ½ oz (14.2 g)	GPMG6043	30-Min Pro Epoxy 4 oz
GPMR6008	Medium CA 1 oz (28.4 g)	GPMG6045	6-Min Pro Epoxy 9 oz
GPMR6009	Medium CA 2 oz (56.7 g)	GPMG6047	30-Min Pro Epoxy 9 oz
GPMR6010	Medium CA 4 oz (113 g)	GPMG6048	45-Min Pro Epoxy 9 oz
GPMR6013	Thick CA ½ oz (14.2 g)	GPMG6049	Pro Epoxy Finishing Resin 9 oz
GPMR6014	Thick CA 1 oz (28.4 g)	GPMR6069	Foam-Safe Medium CA 1 oz (28.4g)
GPMR6015	Thick CA 2 oz (56.7 g)	GPMR6070	Foam-Safe Medium CA 2 oz (56.7g)
GPMR6020	Thick Gel CA 1 oz (28.4 g)	GPMR6072	Foam-Safe Thick CA 1 oz (28.4g)
GPMR6034	Aerosol Activator 4 oz	GPMR6073	Foam-Safe Thick CA 2 oz (56.7g)
GPMG6035	Foam-Safe CA Activator Pump 2 oz.		

ElectriFly: making electric flight easier to enjoy.

For many modelers, electric flight is something new, exciting...and a little bit intimidating. Learning which brands to trust, where the values are and how to performance-match components can be tough. But ElectriFly makes it simple.

We don't make just motors or only batteries; we offer everything for electric flight. Electric aircraft and servos to move their control surfaces. Motors to power them and matching ESCs to control them. Batteries and chargers, spinners and mounts, props and adapters and more.

Performance compatibility is guaranteed, because every product is designed to work together. Connectors for matching components are always compatible and usually installed, for instant, plug-n-play use. And component quality is a given, because all ElectriFly products were designed the same way: by looking at the current state-of-the-art — and then looking for ways to make them better. All it took to make glow-to-RimFire conversions easier was to rename each motor for the glow displacement it replaced.

Simpler, easier, better ideas for electric flight— ElectriFly.

For ElectriFly service and support:

**For service on products in or out of warranty,
send them post-paid and insured to:**

Hobby Services
3002 N. Apollo Drive, Suite 1
Champaign, IL 61822 U.S.A.
Telephone: (217) 398-0007
Web site: hobbyservices.com

24-hour-a-day Customer Service

Our web site is always open and always ready to make your service experience easier. You can track and pay for repairs, add comments and even request specific shipping methods at any time of the day or night — whenever it's most convenient for you!

For general questions about service and products, visit:
hobbyservices@hobbico.com

For questions about the repair status, visit:
repairstatus@hobbyservices.com



*All models under 2 lbs. flying
weight are Park Pilot legal.*